

Tillable Soils Map

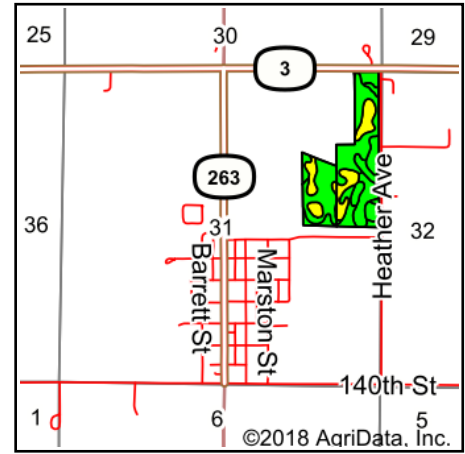
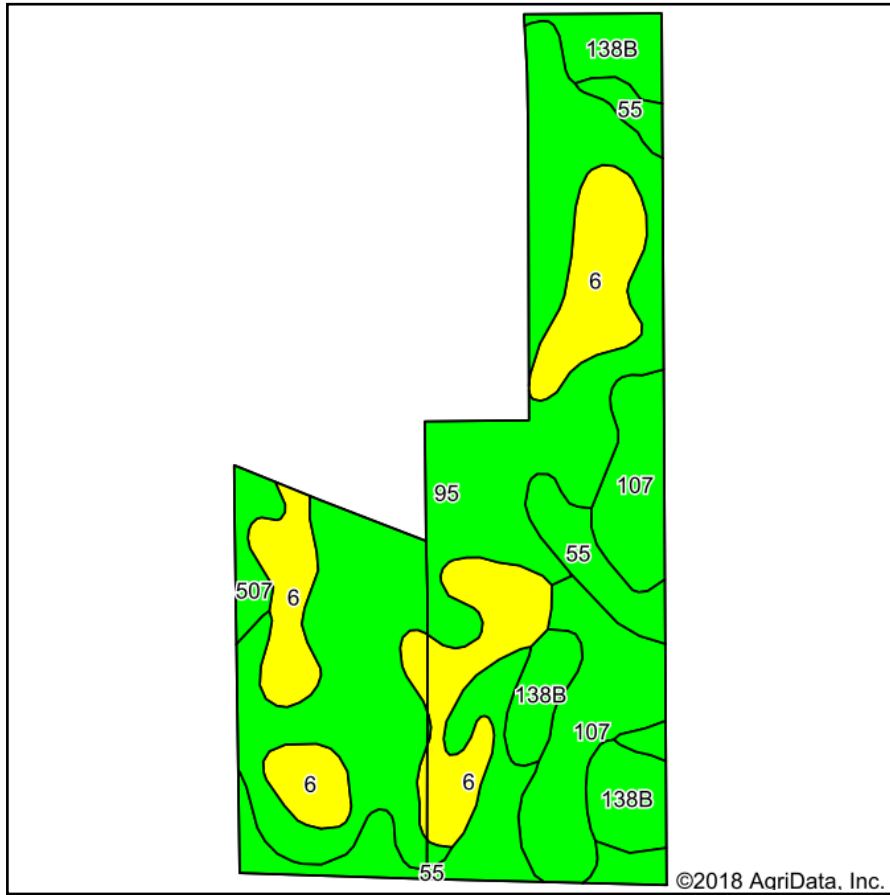

State: **Iowa**
 County: **Franklin**
 Location: **31-92N-21W**
 Township: **Marion**
 Acres: **48.69**
 Date: **4/18/2018**

PEOPLES™
 COMPANY
 INNOVATIVE. REAL ESTATE. SOLUTIONS.

Maps Provided By:

surety®
 CUSTOMIZED ONLINE MAPPING
 © AgriData, Inc. 2018 www.AgriDataInc.com



Area Symbol: IA069, Soil Area Version: 24

Code	Soil Description	Acres	Percent of field	CSR2 Legend	CSR2**	CSR	NCCPI Overall
95	Harps clay loam, 0 to 2 percent slopes	19.47	40.0%		72	63	77
6	Okoboji silty clay loam, 0 to 1 percent slopes	10.11	20.8%		59	57	80
107	Webster clay loam, 0 to 2 percent slopes	6.95	14.3%		86	84	80
55	Nicollet clay loam, 1 to 3 percent slopes	6.75	13.9%		89	89	82
138B	Clarion loam, 2 to 6 percent slopes	4.39	9.0%		89	82	83
507	Canisteo clay loam, 0 to 2 percent slopes	1.02	2.1%		84	79	79
Weighted Average					75.4	70.4	79.3

**IA has updated the CSR values for each county to CSR2.

*c: Using Capabilities Class Dominant Condition Aggregation Method

Soils data provided by USDA and NRCS.