

Soils Map - Tillable Acres

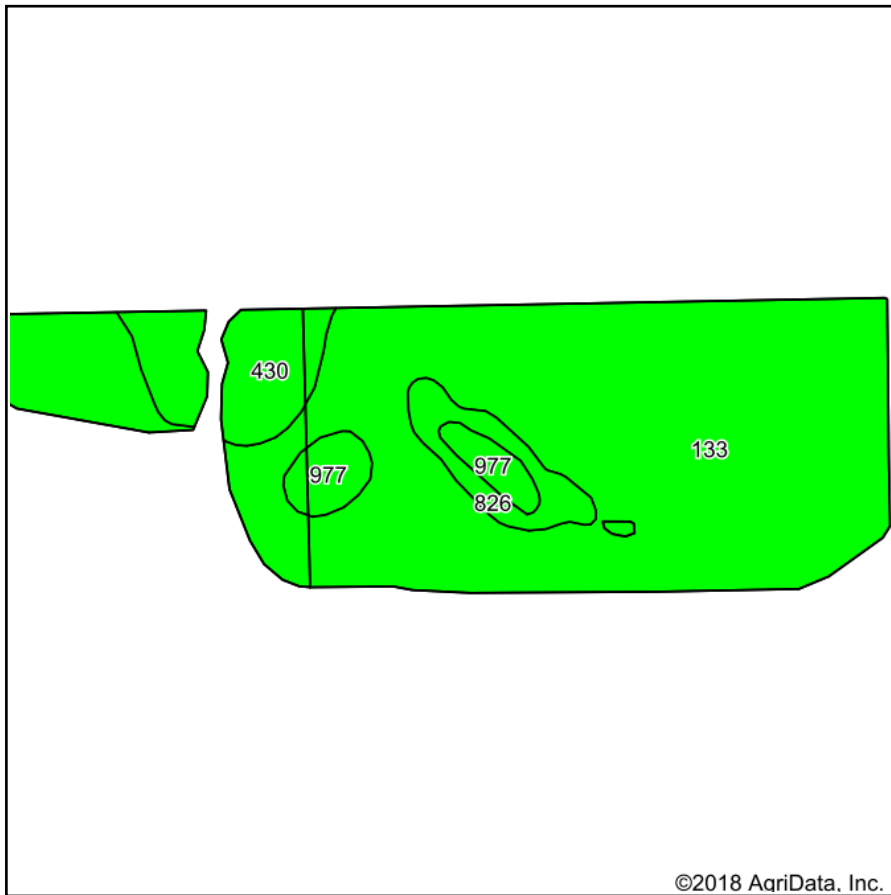

Soils data provided by USDA and NRCS.

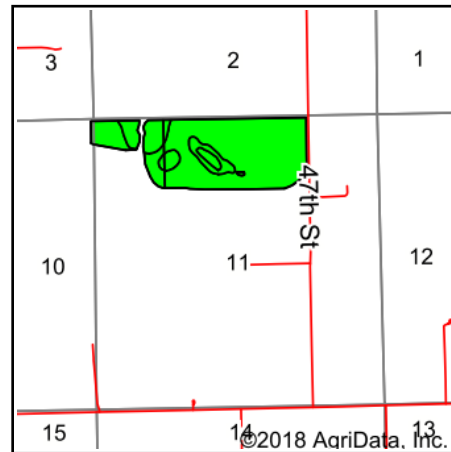

State: **Iowa**
 County: **Scott**
 Location: **11-79N-1E**
 Township: **Cleona**
 Acres: **94.46**
 Date: **8/29/2018**



Maps Provided By:



Area Symbol: IA163, Soil Area Version: 25

Code	Soil Description	Acres	Percent of field	CSR2 Legend	Non-Irr Class *c	*i Corn	*i Alfalfa	*i Soybeans	*i Bluegrass	*i Tall Grasses	CSR2**	CSR	NCCPI Overall	NCCPI Corn	NCCPI Small Grains	NCCPI Soybeans	NCCPI Cotton
133	Colo silty clay loam, 0 to 2 percent slopes, occasionally flooded	77.38	81.9%		llw	204.8	4.3	59.4	3.7	6.1	78	80	95	95	12	71	0
430	Ackmore silt loam, 0 to 2 percent slopes	8.60	9.1%		llw	203.2	5.3	58.9	3.7	6.1	77	83	87	87	56	76	0
977	Richwood silt loam, 0 to 2 percent slopes	4.27	4.5%		l	240	6.7	69.6	4.3	7.2	100	95	92	92	73	86	9
826	Rowley silt loam, 0 to 2 percent slopes	4.21	4.5%		lw	80	2.1	23.2	1.4	2.4	76	95	87	87	51	84	0
Weighted Average						200.7	4.4	58.2	3.6	6	78.8	81.6	93.8	93.8	20.5	72.7	0.4

**IA has updated the CSR values for each county to CSR2.

*i Yield data provided by the ISPAID Database version 8.1.1 developed by IA State University.

*c: Using Capabilities Class Dominant Condition Aggregation Method

Soils data provided by USDA and NRCS.