

# Soils Map

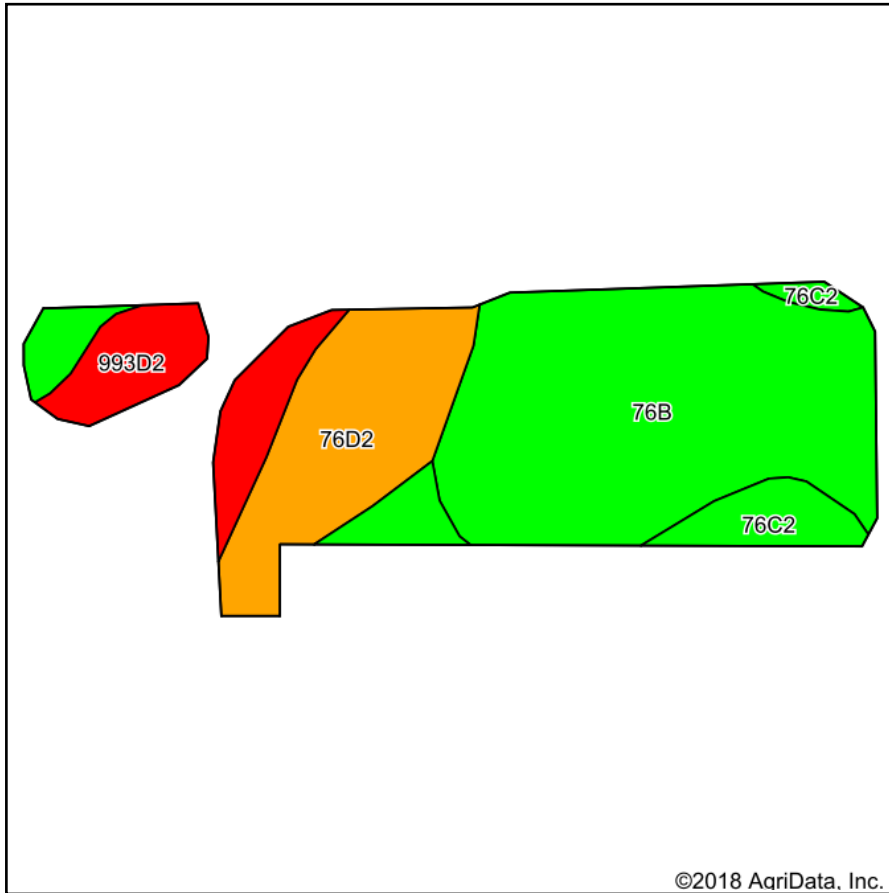

Soils data provided by USDA and NRCS.

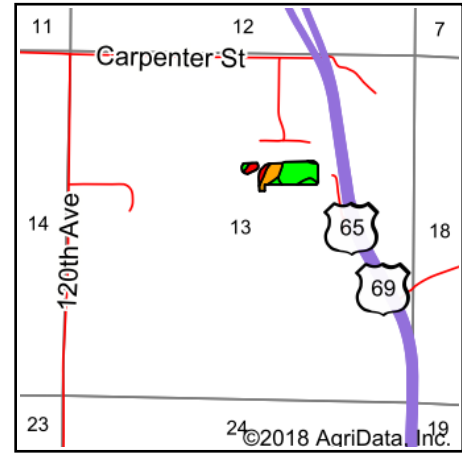

State: **Iowa**  
 County: **Warren**  
 Location: **13-77N-24W**  
 Township: **Greenfield**  
 Acres: **7.83**  
 Date: **9/7/2018**



Maps Provided By:



## Area Symbol: IA181, Soil Area Version: 22

Code	Soil Description	Acres	Percent of field	CSR2 Legend	Non-Irr Class *c	CSR2**	CSR	NCCPI Overall	NCCPI Soybeans
76B	Ladoga silt loam, 2 to 5 percent slopes	4.37	55.8%		IIe	86	85	82	78
76D2	Ladoga silt loam, 9 to 14 percent slopes, eroded	1.70	21.7%		IIIe	49	55	61	58
993D2	Armstrong-Gara loams, 9 to 14 percent slopes, moderately eroded	1.00	12.8%		IVe	23	20	62	46
76C2	Ladoga silt loam, dissected till plain, 5 to 9 percent slopes, eroded	0.76	9.7%		IIIe	75	65	64	62
<b>Weighted Average</b>						<b>68.9</b>	<b>68.2</b>	<b>73.1</b>	<b>68</b>

\*\*IA has updated the CSR values for each county to CSR2.

\*c: Using Capabilities Class Dominant Condition Aggregation Method

Soils data provided by USDA and NRCS.