

# Soils Map

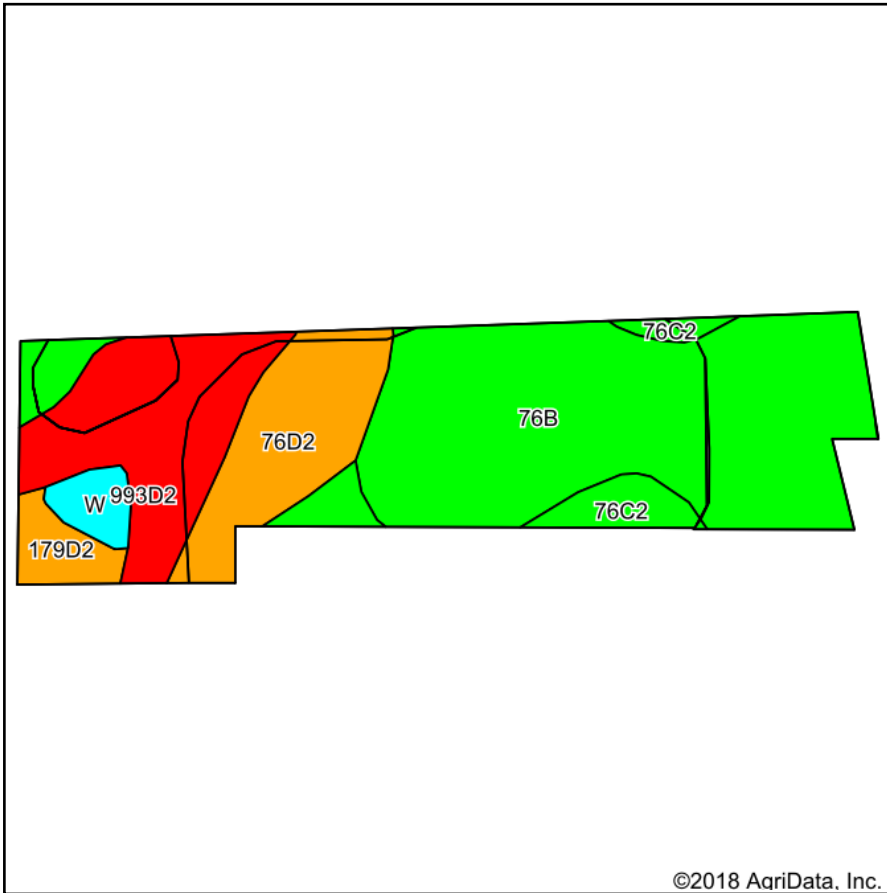

Soils data provided by USDA and NRCS.

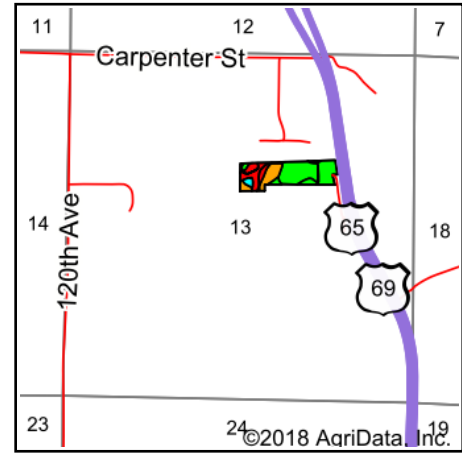

State: **Iowa**  
 County: **Warren**  
 Location: **13-77N-24W**  
 Township: **Greenfield**  
 Acres: **12.54**  
 Date: **9/7/2018**



Maps Provided By:



**Area Symbol: IA181, Soil Area Version: 22**

Code	Soil Description	Acres	Percent of field	CSR2 Legend	Non-Irr Class *c	CSR2**	CSR	NCCPI Overall	NCCPI Soybeans
76B	Ladoga silt loam, 2 to 5 percent slopes	6.71	53.5%		Ile	86	85	82	78
993D2	Armstrong-Gara loams, 9 to 14 percent slopes, moderately eroded	2.39	19.1%		IVe	23	20	62	46
76D2	Ladoga silt loam, 9 to 14 percent slopes, eroded	1.81	14.4%		IIIe	49	55	61	58
76C2	Ladoga silt loam, dissected till plain, 5 to 9 percent slopes, eroded	0.82	6.5%		IIIe	75	65	64	62
179D2	Gara loam, dissected till plain, 9 to 14 percent slopes, eroded	0.46	3.7%		IVe	43	43	68	51
W	Water	0.35	2.8%			0	0		0
<b>Weighted Average</b>						<b>64</b>	<b>63.1</b>	<b>71.2</b>	<b>64.8</b>

\*\*IA has updated the CSR values for each county to CSR2.

\*c: Using Capabilities Class Dominant Condition Aggregation Method

Soils data provided by USDA and NRCS.