

# LAND FOR SALE

LISTING #14329

**48.8 ACRES M/L**  
LEWIS COUNTY, MISSOURI



**DOUG YEGGE**

C: 563.320.9900

O: 563.659.8185

Doug@PeoplesCompany.com

**PeoplesCompany.com**  
**563.659.8185**

700 6th Ave  
DeWitt, Iowa 52742

# LAND FOR SALE

## LEGAL DESCRIPTION:

Part of the NW 1/4 of the NW 1/4 of Section 17, Township 62 North, Range 9 West of the 5th P.M.. Brief legal description is not to be used on legal documents.

## COMMENTS & BUILDING INFORMATION:

Offering 48.8 surveyed acres of productive Lewis County, Missouri farmland. The farm consists of 44.23 FSA tillable acres carrying class II, III and IV soils. Primary soil types on this tract include Kilwinning, Armstrong, Leonard and Lindley loams. The farm also contains a nice 1/2 acre pond with recreational opportunities. The farm is located approximately 30 miles Northwest of Quincy, Illinois and approximately 30 miles Southwest of Keokuk, Iowa. The farm lays on the east side of Co. Rd. 382 in Section 17, of Reddish Township, Lewis Co. Missouri.

Owner is offering a 3 yr. land contract.

## TO CONTACT LISTING AGENT:

Call: **Douglas R. Yegge**  
 Cell: 563.320.9900  
 Office: 563.659.8185  
 Doug@PeoplesCompany.com

## LEASE/FSA INFORMATION:

Currently leased for \$215 per tillable acre until Feb. 28, 2022.

**Crist, 48.9 Acres M/L, Lewis County, MO**

<b>TOTAL ACRES:</b>	<b>48.9</b>
<b>PRICE:</b>	<b>\$239,000</b>
<b>Price Per Acre:</b>	\$4,887.50
<b>Owner:</b>	Crist
<b>Operator:</b>	
<b>County &amp; State:</b>	Lewis Co., Missouri
<b>Location:</b>	North of LaBelle, MO
<b>Possession Date:</b>	To be agreed
<b>Drainage Info:</b>	
<b>Average Productivity:</b>	
<b>Taxable Acres:</b>	48
<b>Net RE Taxes:</b>	\$158.36
<b>Taxes Payable In:</b>	2019
<b>Topography:</b>	

## F.S.A. INFORMATION:

<b>Farmland:</b>	47.78
<b>Crop Acres:</b>	44.23
<b>CRP Acres:</b>	
<b>Wheat Base:</b>	18.5
<b>Wheat Yield:</b>	37
<b>Corn Base:</b>	12.7
<b>Corn Yield:</b>	74
<b>Soybean Base:</b>	
<b>Soybean Yield:</b>	

## APPROXIMATE BREAKDOWN OF ACRES:

<b>Total Acres:</b>	48.8
<b>Tillable Acres:</b>	44.23
<b>CRP Acres:</b>	
<b>Farmstead:</b>	
<b>Roads:</b>	3
<b>Pond</b>	.5
<b>Timber:</b>	1.17
<b>Pasture:</b>	



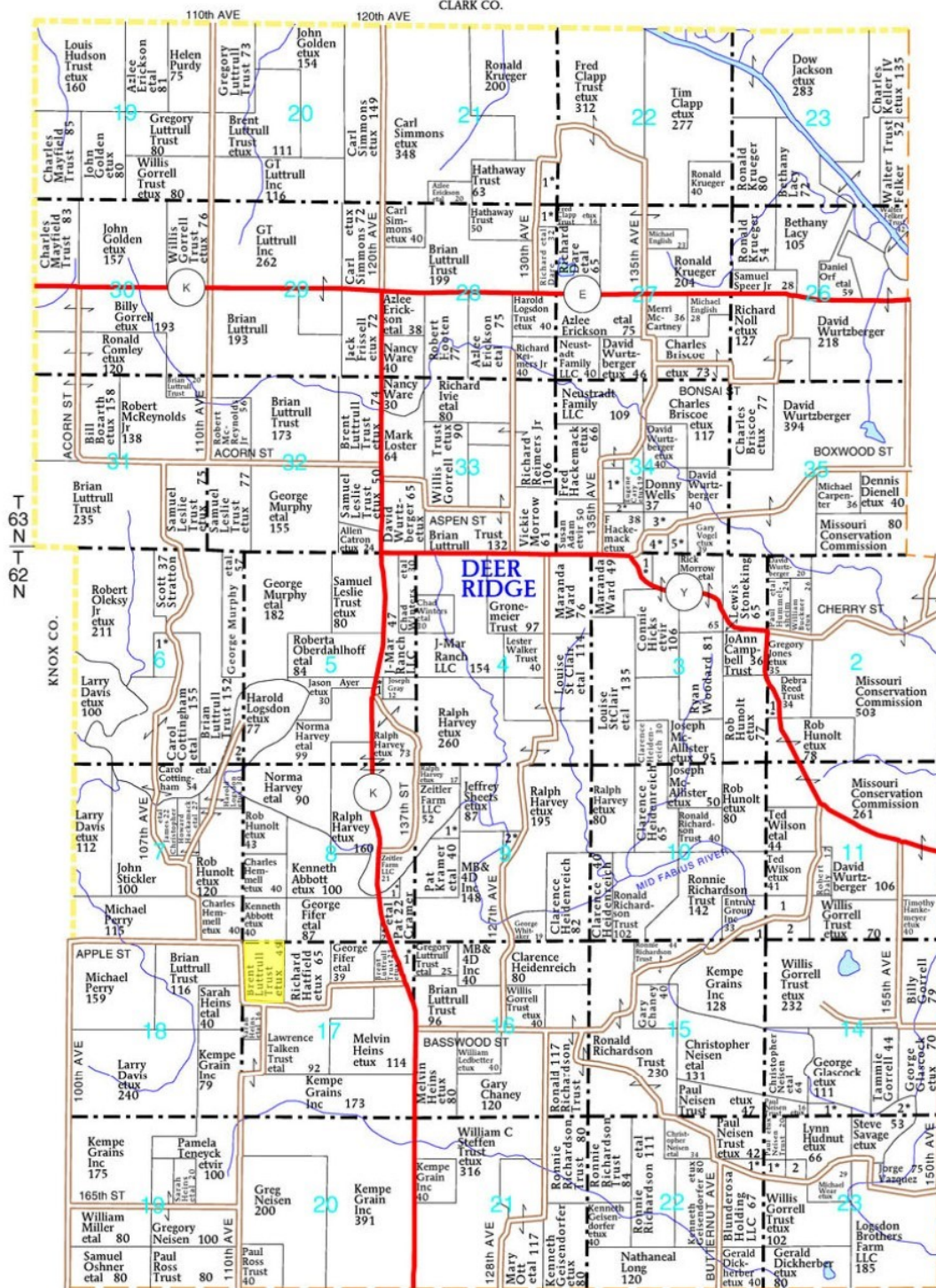
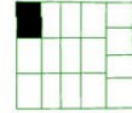

LA BELLE WEST TWP.

REDDISH WEST

## TOWNSHIP

## SECTION 2

- 1. Hunolt Jr, Robert 5**

### SECTION 3

1. Hackemack, F 7

## SECTION 5

1. Davison, William 5

## SECTION 6

1. Davie, Keith 18

## 2. Logsd

- ## SECTION 8

1. Miriani, Timothy 5
2. Kramer, Michael 5

2. Kramer, Michael 5  
SECTION 9

**SECTION 9**  
1. Kramer, Michael 8

1. Kramer, Michael 8
2. Whitaker, Robert 5

## SECTION 10

1. Kempe Grains Inc 7

## SECTION 11

1. Entrust Group Inc 21

## 2. Kempe

### SECTION 14

- SECTION 14**  
1. Hudnut, Lynn 11

1. Hudnut
2. Savage

2. Savage, Steve 9

## SECTION 17

1. Luttrull Trust, Gregory

12  
SECTION 21

- SECTION 21N**  
4. **Glossary** ..... 22

1. Clapp T  
SECTION 22

- SECTION 22S**  
1. Newberry, Richard 8

1. Newber  
SECTION 23

- SECTION 23S**  
1. Newberry, Richard 7

2. Gorrell, Billy 9

**SECTION 28**  
**4. Glass**

1. Clapp Trust, Fred 8  
SECTION 24

## SECTION 34

1. Gross, James 15
2. Gross, James 7
3. Waterkotte, John 14

3. Waterkotte, John 14
4. Collins, Larry 9
5. Winkler, William 13



Aerial Map



©2018 AgriData, Inc.



**PEOPLES**  
COMPANY  
INNOVATIVE. REAL ESTATE. SOLUTIONS.

map center: 40° 10' 40.93, -91° 55' 35.05

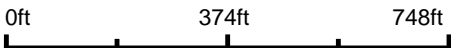

Maps Provided By:



**surety**  
CUSTOMIZED ONLINE MAPPING

© AgriData, Inc. 2018      [www.AgriDataInc.com](http://www.AgriDataInc.com)

**17-62N-9W**  
**Lewis County**  
**Missouri**



10/1/2018

Field borders provided by Farm Service Agency as of 5/21/2008.

# Soils Map

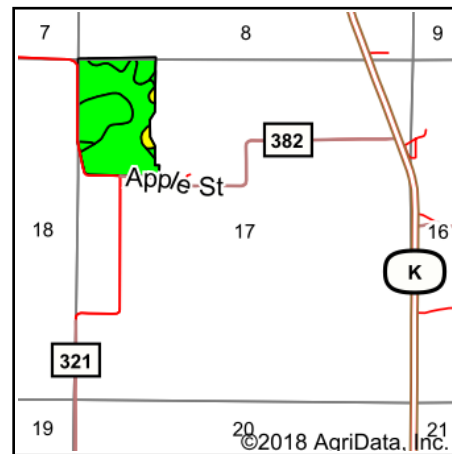
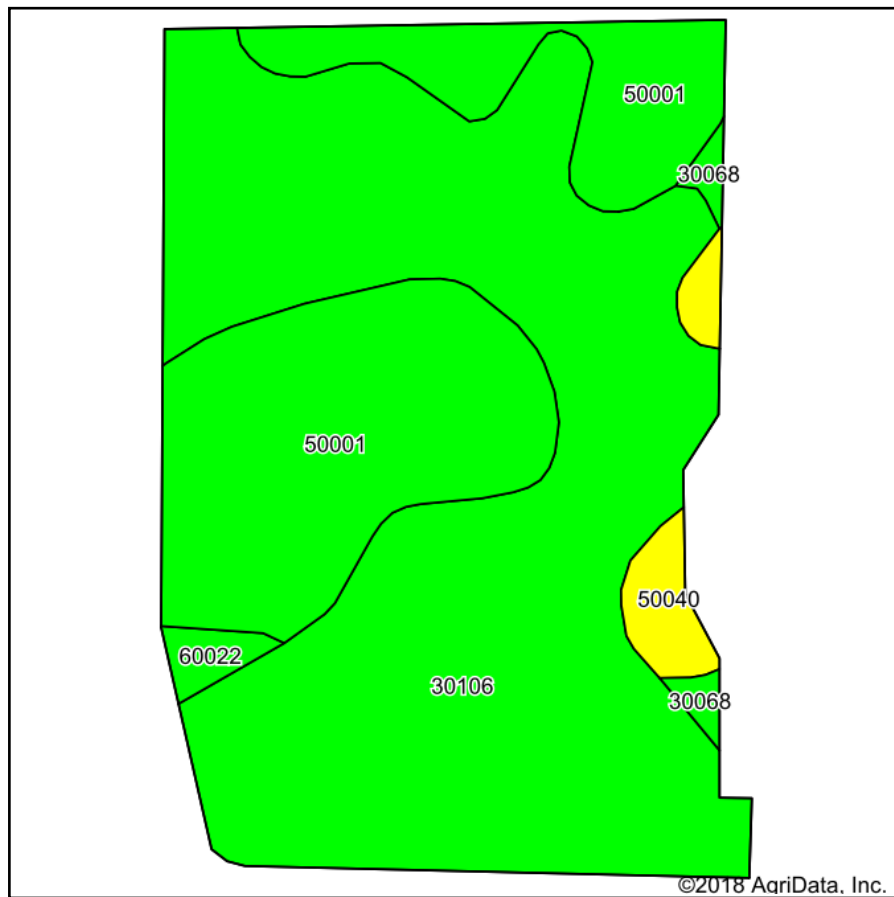

State: **Missouri**  
 County: **Lewis**  
 Location: **17-62N-9W**  
 Township: **Reddish**  
 Acres: **48.8**  
 Date: **10/1/2018**

**PEOPLES**™  
**COMPANY**  
 INNOVATIVE. REAL ESTATE. SOLUTIONS.

Maps Provided By:  
**surety**®  
 CUSTOMIZED ONLINE MAPPING  
 © AgriData, Inc. 2018 www.AgriDataInc.com



## Area Symbol: MO111, Soil Area Version: 18

Code	Soil Description	Acres	Percent of field	Non-Irr Class Legend	Non-Irr Class *c	Corn	Soybeans	NCCPI Overall	NCCPI Corn	NCCPI Small Grains	NCCPI Soybeans
30106	Kilwinning silt loam, 1 to 5 percent slopes	31.62	64.8%		IIIe			59	59	38	54
50001	Armstrong loam, 5 to 9 percent slopes, eroded	14.77	30.3%		IIIe	5	2	57	57	29	45
50040	Lindley loam, 14 to 20 percent slopes, eroded	1.40	2.9%		VIe			55	55	41	48
60022	Leonard silt loam, 1 to 6 percent slopes, eroded	0.54	1.1%		IIIe			42	42	35	42
30068	Gorin silt loam, 5 to 9 percent slopes, eroded	0.47	1.0%		IIIe			63	63	41	53
Weighted Average						1.5	0.6	58.1	58.1	35.4	51

\*c: Using Capabilities Class Dominant Condition Aggregation Method

Soils data provided by USDA and NRCS.

## Exhibit A

Being a part of the Northwest Quarter of Section 17, Township 62 North, Range 9 West of the 5th Principal Meridian, Lewis County, Missouri, and being more particularly described as follows: Beginning at the Northwest Corner of the Northwest Quarter of said Section 17; thence Easterly along the North line of the Northwest Quarter, South 89 degrees 45' 58" East (assumed bearing for this description) 1185.05 feet; thence South 03 degrees 06' 28" West 251.62 feet; thence South 01 degrees 43' 08" West 606.01 feet; thence South 27 degrees 00' 21" West 223.46 feet; thence South 10 degrees 03' 20" East 157.81 feet; thence South 25 degrees 19' 20" East 108.16 feet; thence South 39 degrees 10' 40" East 85.20 feet; thence South 03 degrees 04' 09" East 310.57 feet; thence South 89 degrees 34' 38" East 44.06 feet; thence South 01 degrees 27' 19" West 179.01 feet, to the centerline of the existing public road as now established; thence Westerly along said centerline, North 87 degrees 42' 30" West 1075.30 feet, to a curve; thence Northeasterly 133.48 feet along a 100.00 foot radius curve concave Northerly and having a chord bearing and length of North 49 degrees, 28' 04" West 123.79 feet; thence Northwesterly along said centerline, North 11 degrees 13' 38" West 299.16 feet, to a curve; thence Northwesterly 137.40 feet along a 1200.00 foot radius curve concave Northeasterly and having a chord bearing and length of North 07 degrees 56' 50" West 137.32 feet to a point on the North line of the Southwest Quarter of the Northwest Quarter; thence Westerly along said line North 89 degrees 27' 31" West 7.99 feet, to the West line of the Northwest Quarter; thence Northerly along said line, North 00 degrees 47' 38" East 1316.67 feet, to the point of beginning, containing 48.80 acres, more or less, being subject to the right of the public for roadway purposes along the existing public roads, and being subject to easements of record or by prescription.





**All Measurements are  
For FSA Programs Only**

**Wetland Determination Identifiers**

- Restricted Use
- ▼ Limited Restrictions
- Exempt from Conservation Compliance Provisions

Disclaimer: Wetland identifiers do not represent the size, shape or specific determination of the area. Refer to your original determination (CPA-026 and attached maps) for exact wetland boundaries and determinations, or contact NRCS.

**Lewis Co. FSA**

wht = wheat-srw-gr  
corn = corn-yel-gr  
SB = soybn-com-gr  
Hay=mixfg-fg  
Past or GZ= mixgfg-gz  
AGM = mixfg-agm-fg  
All flds NI unless noted  
\*Unless notated on Map

1:7,920

**Program Year: 2018**

Created: 4/24/2018

Flown: 2016-06-10

- clu
- crp
- plss

**Farm 4842  
Tract 10407**

MISSOURI

LEWIS

Form: FSA-156EZ

See Page 2 for non-discriminatory Statements.

United States Department of Agriculture  
Farm Service Agency

FARM : 4842

Prepared : Sep 27, 2018

Crop Year : 2019

## Abbreviated 156 Farm Record

Operator Name

: [REDACTED]

Farms Associated with Operator :

29-111-403, 29-111-703, 29-111-704, 29-137-1328, 29-175-1377, 29-137-1417, 29-115-1474, 29-007-1565,  
29-117-1572, 29-121-1856, 29-007-1864, 29-173-2639, 29-175-2640, 29-173-2640, 29-007-3244, 29-127-3577,  
29-045-3735, 29-045-3736, 29-127-3915, 29-111-3917, 29-111-3949, 29-103-3983, 29-103-3984, 29-111-4100,  
29-115-4468, 29-173-4711, 29-111-4842, 29-111-4946, 29-137-5045, 29-007-5171, 29-175-5281, 29-115-5433,  
29-175-5694, 29-007-5860, 29-007-5954, 29-007-5955, 29-137-6129, 29-175-6204, 29-137-6273, 29-175-6286,  
29-121-7489, 29-121-7714

CRP Contract Number(s)

: None

Recon ID

: 29-111-2017-6

## Farm Land Data

Farmland	Cropland	DCP Cropland	WBP	WRP	CRP	GRP	Sugarcane	Farm Status	Number Of Tracts
47.78	44.23	44.23	0.00	0.00	0.00	0.00	0.00	Active	1
State Conservation	Other Conservation	Effective DCP Cropland	Double Cropped		MPL	Acre Election	EWP	DCP Ag.Rel. Activity	Broken From Native Sod
0.00	0.00	44.23	0.00		0.00		0.00	0.00	0.00

## Crop Election Choice

ARC Individual	ARC County	Price Loss Coverage
None	SOYBN	WHEAT, CORN

## DCP Crop Data

Crop Name	Base Acres	CCC-505 CRP Reduction Acres	CTAP Yield	PLC Yield	HIP
Wheat	18.50	0.00	0	37	
Corn	12.70	0.00	0	74	

TOTAL 31.20 0.00

## NOTES

Tract Number : 10407

Description : S17 T62 R9

FSA Physical Location : MISSOURI/LEWIS

ANSI Physical Location : MISSOURI/LEWIS

BIA Unit Range Number :

HEL Status : HEL field on tract.Conservation system being actively applied

Wetland Status : Wetland determinations not complete

WL Violations : None

Owners : ROBERT L CRIST, LINDA S CRIST

Other Producers : None

Recon ID : None

## Tract Land Data

Farm Land	Cropland	DCP Cropland	WBP	WRP	CRP	GRP	Sugarcane
47.78	44.23	44.23	0.00	0.00	0.00	0.00	0.00
State Conservation	Other Conservation	Effective DCP Cropland	Double Cropped	MPL	EWP	DCP Ag. Rel Activity	Broken From Native Sod
0.00	0.00	44.23	0.00	0.00	0.00	0.00	0.00

## DCP Crop Data



MISSOURI

LEWIS

Form: FSA-156EZ

United States Department of Agriculture  
Farm Service Agency

FARM : 4842

Prepared : Sep 27, 2018

Crop Year : 2019

## Abbreviated 156 Farm Record

## Tract 10407 Continued ...

Crop Name	Base Acres	CCC-505 CRP Reduction Acres	CTAP Yield	PLC Yield
Wheat	18.50	0.00	0	37
Corn	12.70	0.00	0	74
<b>TOTAL</b>	<b>31.20</b>	<b>0.00</b>		

## NOTES

The U.S. Department of Agriculture (USDA) prohibits discrimination against its customers, employees, and applicants for employment on the basis of race, color, national origin, age, disability, sex, gender identity, religion, reprisal, and where applicable, political beliefs, marital status, familial or parental status, sexual orientation, or all or part of an individual's income is derived from any public assistance program, or protected genetic information in employment or in any program or activity conducted or funded by the Department. (Not all prohibited bases will apply to all programs and/or employment activities.) Persons with disabilities, who wish to file a program complaint, write to the address below or if you require alternative means of communication for program information (e.g., Braille, large print, audiotape, etc.) please contact USDA's TARGET Center at (202) 720-2600 (voice and TDD). Individuals who are deaf, hard of hearing, or have speech disabilities and wish to file either an EEO or program complaint, please contact USDA through the Federal Relay Service at (800) 877-8339 or (800) 845-6136 (in Spanish).

If you wish to file a Civil Rights program complaint of discrimination, complete the USDA Program Discrimination Complaint Form, found online at [http://www.ascr.usda.gov/complaint\\_filing\\_cust.html](http://www.ascr.usda.gov/complaint_filing_cust.html), or at any USDA office, or call (866) 632-9992 to request the form. You may also write a letter containing all of the information requested in the form. Send your completed complaint form or letter by mail to U.S. Department of Agriculture, Director, Office of Adjudication, 1400 Independence Avenue, S.W., Washington, D.C. 20250-9410, by fax (202) 690-7442 or email at [program.intake@usda.gov](mailto:program.intake@usda.gov). USDA is an equal opportunity provider and employer.



**APPLE STREET**





HWY V

48.9 AC.



HWY K

KNOX CITY

HWY 6

LA BELLE