

# Tillable Soils Map

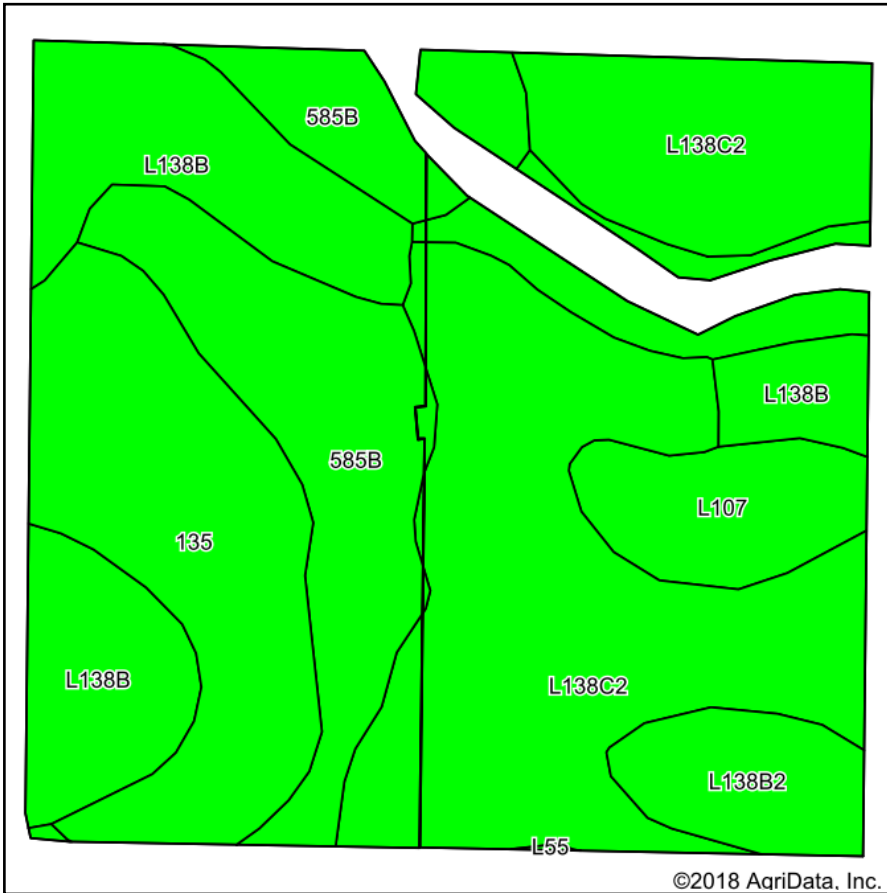

Soils data provided by USDA and NRCS.

©2018 AgriData, Inc.

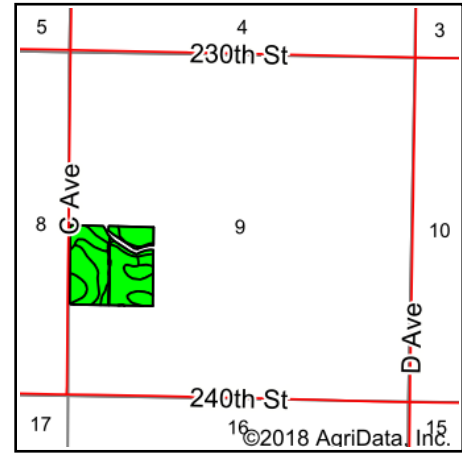

State: **Iowa**  
 County: **Greene**  
 Location: **9-83N-32W**  
 Township: **Scranton**  
 Acres: **33.98**  
 Date: **10/29/2018**

**PEOPLES**  
 COMPANY  
 INNOVATIVE. REAL ESTATE. SOLUTIONS.

Maps Provided By:



Area Symbol: IA073, Soil Area Version: 24

Code	Soil Description	Acres	Percent of field	CSR2 Legend	Non-Irr Class *c	CSR2**	CSR	*n NCCPI Overall	*n NCCPI Soybeans
L138C2	Clarion loam, Bemis moraine, 6 to 10 percent slopes, moderately eroded	12.11	35.6%		Ille	83		60	60
585B	Coland-Spillville complex, 1 to 5 percent slopes	5.95	17.5%		Ilw	74	70	93	87
L138B	Clarion loam, Bemis moraine, 2 to 6 percent slopes	5.67	16.7%		Ile	88		79	79
135	Coland clay loam, 0 to 2 percent slopes, occasionally flooded	5.52	16.2%		Ilw	76	81	86	78
L107	Webster clay loam, Bemis moraine, 0 to 2 percent slopes	3.15	9.3%		Ilw	88		80	80
L138B2	Clarion loam, Bemis moraine, 2 to 6 percent slopes, moderately eroded	1.58	4.6%		Ile	85		63	62
<b>Weighted Average</b>						<b>81.7</b>	<b>*-</b>	<b>*n 75.2</b>	<b>*n 72.8</b>

\*\*IA has updated the CSR values for each county to CSR2.

\*- CSR weighted average cannot be calculated on the current soils data, use prior data version for csr values.

\*n: The aggregation method is "Weighted Average using major components"

\*c: Using Capabilities Class Dominant Condition Aggregation Method

Soils data provided by USDA and NRCS.