

Soils Map

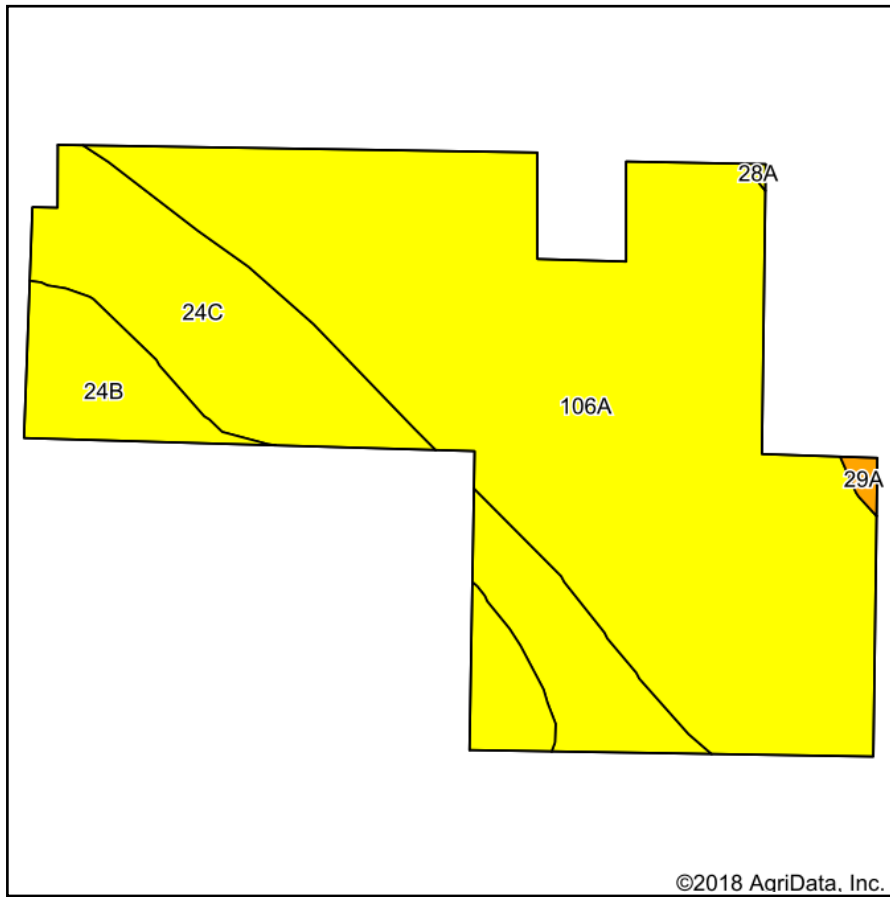

Soils data provided by USDA and NRCS.

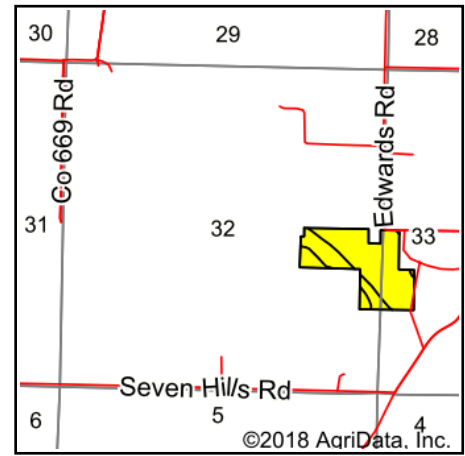

State: **Oregon**
 County: **Umatilla**
 Location: **32-6N-35E**
 Township: **Umapine**
 Acres: **36.7**
 Date: **10/12/2018**

PEOPLES™
COMPANY
 INNOVATIVE. REAL ESTATE. SOLUTIONS.

Maps Provided By:

surety®
 CUSTOMIZED ONLINE MAPPING
 © AgriData, Inc. 2018 www.AgriDataInc.com



Area Symbol: OR667, Soil Area Version: 13

Cod e	Soil Description	Acres	Percent of field	Non-Irr Class Legend	Non-Irr Class *c	Irr Class *c	Alfalfa hay Irrigated	Apples Irrigated	Asparagus Irrigated	Corn Irrigated	Sweet corn Irrigated	Pasture Irrigated	Sugar beets Irrigated	Winter wheat Irrigated	Winter wheat	Alfalfa seed Irrigated	Barley	Car pea Irrig
106A	Umapine silt loam, reclaimed, 0 to 3 percent slopes	25.07	68.3%		IVs	IIIw	7	1000	250	150	7	18	28	100				
24C	Ellisforde silt loam, 7 to 20 percent slopes	8.17	22.3%		IIIe	IVe	8	1500				13		110	18	500	31	
24B	Ellisforde silt loam, 1 to 7 percent slopes	3.32	9.0%		IIIe	Ile	8	1500				13		110	18	500	31	
29A	Freewater very cobbly loam, 0 to 3 percent slopes	0.14	0.4%		VIIs	IVs		1000				10						
Weighted Average							7.3	1156.5	170.8	102.5	4.8	16.4	19.1	102.7	5.6	156.5	9.7	

*c: Using Capabilities Class Dominant Condition Aggregation Method

Soils data provided by USDA and NRCS.