

# Tract 2 - Tillable Soils Map

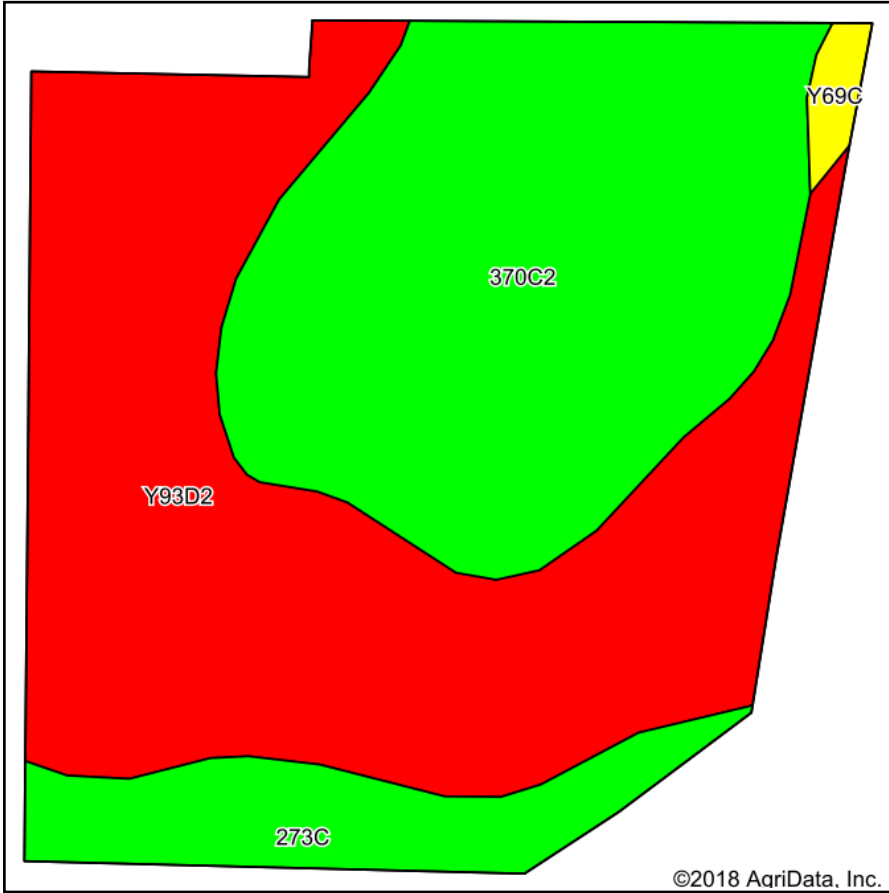

Soils data provided by USDA and NRCS.

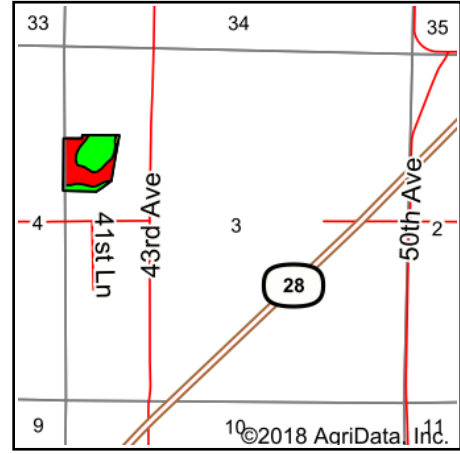

State: **Iowa**  
 County: **Warren**  
 Location: **3-76N-25W**  
 Township: **Jefferson**  
 Acres: **14.52**  
 Date: **10/30/2018**



Maps Provided By:



**Area Symbol: IA181, Soil Area Version: 23**

Code	Soil Description	Acres	Percent of field	CSR2 Legend	CSR2**	CSR
Y93D2	Shelby-Adair clay loams, dissected till plain, 9 to 14 percent slopes, eroded	7.20	49.6%		35	
370C2	Sharpsburg silty clay loam, 5 to 9 percent slopes, eroded	5.79	39.9%		80	67
273C	Olmitz loam, 5 to 9 percent slopes	1.37	9.4%		85	57
Y69C	Clearfield silty clay loam, dissected till plain, 5 to 9 percent slopes	0.16	1.1%		59	
<b>Weighted Average</b>					<b>57.9</b>	<b>*-</b>

\*\*IA has updated the CSR values for each county to CSR2.

\*- CSR weighted average cannot be calculated on the current soils data, use prior data version for csr values.

\*c: Using Capabilities Class Dominant Condition Aggregation Method

Soils data provided by USDA and NRCS.