

Soils Map

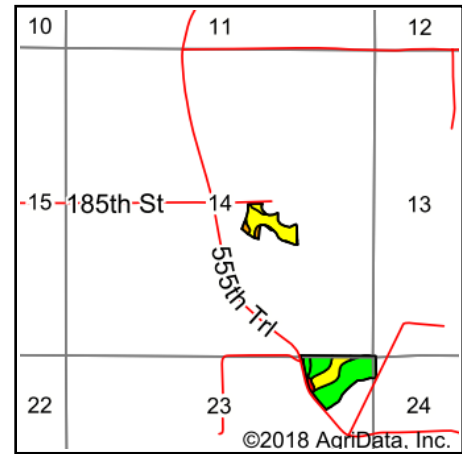
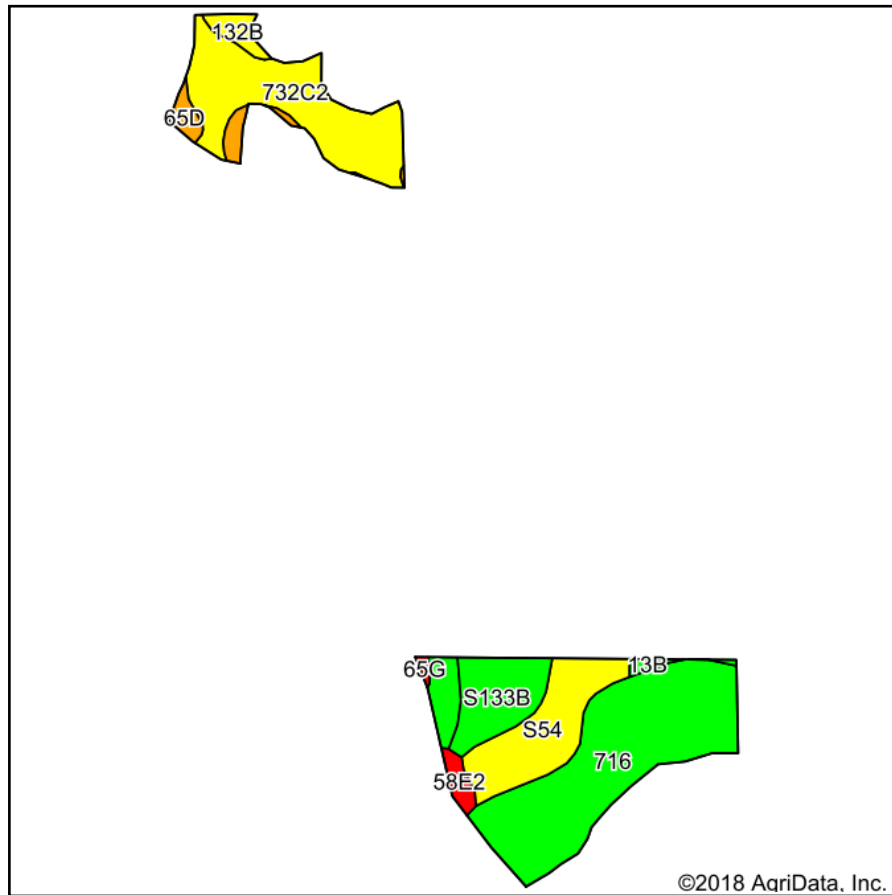

State: **Iowa**
 County: **Monroe**
 Location: **14-72N-19W**
 Township: **Wayne**
 Acres: **24.72**
 Date: **10/18/2018**

PEOPLES COMPANY
 INNOVATIVE. REAL ESTATE. SOLUTIONS.

Maps Provided By:
surety
 CUSTOMIZED ONLINE MAPPING
 © AgriData, Inc. 2018 www.AgriDataInc.com



Area Symbol: IA135, Soil Area Version: 26

Code	Soil Description	Acres	Percent of field	CSR2 Legend	Non-Irr Class *c	CSR2**	CSR	*n NCCPI Overall	*n NCCPI Soybeans
716	Lawson-Quiver-Nodaway complex, 0 to 2 percent slopes, occasionally flooded	9.60	38.8%		Ilw	78		87	85
732C2	Weller silty clay loam, 5 to 9 percent slopes, moderately eroded	5.89	23.8%		Ille	59	40	73	67
S54	Zook silty clay loam, heavy till, 0 to 2 percent slopes, occasionally flooded	3.77	15.3%		Ilw	68		73	64
S133B	Colo silty clay loam, heavy till, 2 to 5 percent slopes, rarely flooded	2.52	10.2%		Ilw	80		94	81
13B	Olmitz-Colo-Vesser complex, 2 to 5 percent slopes	1.06	4.3%		Ilw	82	60	82	72
65D	Lindley loam, 9 to 14 percent slopes	0.81	3.3%		IVe	43	40	71	66
132B	Weller silt loam, 2 to 5 percent slopes	0.55	2.2%		Ille	67	60	88	84
58E2	Douds loam, heavy loess, 14 to 18 percent slopes, moderately eroded	0.43	1.7%		Vle	34	18	63	54
65G	Lindley loam, 18 to 40 percent slopes	0.09	0.4%		Vlle	6	5	17	9
Weighted Average						69.9	*-	*n 80.9	*n 75.1

**IA has updated the CSR values for each county to CSR2.

*- CSR weighted average cannot be calculated on the current soils data, use prior data version for csr values.

*n: The aggregation method is "Weighted Average using major components"

*c: Using Capabilities Class Dominant Condition Aggregation Method

Soils data provided by USDA and NRCS.