

Soils Map

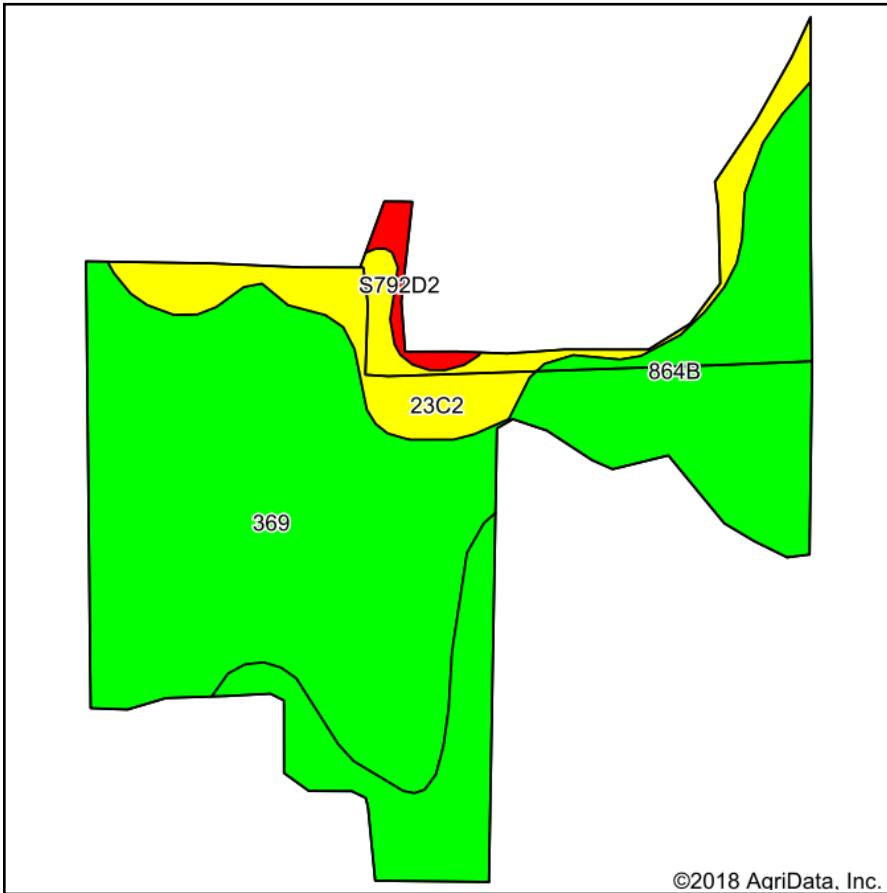

Soils data provided by USDA and NRCS.

©2018 AgriData, Inc.

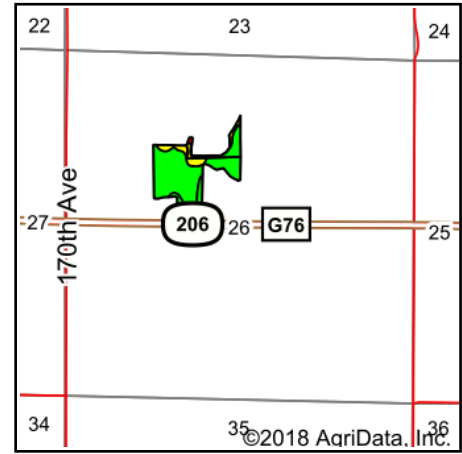

©2018 AgriData, Inc.

State: **Iowa**
 County: **Warren**
 Location: **26-74N-23W**
 Township: **Liberty**
 Acres: **20.71**
 Date: **12/11/2018**



Maps Provided By:



© AgriData, Inc. 2018

www.AgriDataInc.com



Area Symbol: IA181, Soil Area Version: 23

Code	Soil Description	Acres	Percent of field	CSR2 Legend	Non-Irr Class *c	*i Corn	*i Soybeans	CSR2**	CSR	*n NCCPI Overall	*n NCCPI Corn	*n NCCPI Small Grains
369	Winterset silty clay loam, 0 to 2 percent slopes	11.22	54.2%	Green	IIw	217.6	63.1	84	83	80	80	16
864B	Grundy silty clay loam, 2 to 5 percent slopes	6.66	32.2%	Yellow	IIe	80	23.2	72	82	78	78	44
23C2	Arispe silty clay loam, 5 to 9 percent slopes, moderately eroded	2.54	12.3%	Yellow	IIIe	80	23.2	62	62	82	82	49
S792D2	Armstrong loam, 9 to 14 percent slopes, moderately eroded	0.29	1.4%	Red	IVe	0	0	9		57	57	32
Weighted Average						153.4	44.5	76.4	*-	*n 79.3	*n 79.3	*n 29.3

**IA has updated the CSR values for each county to CSR2.

*- CSR weighted average cannot be calculated on the current soils data, use prior data version for csr values.

*i Yield data provided by the ISPAID Database version 8.1.1 developed by IA State University.

*n: The aggregation method is "Weighted Average using major components"

*c: Using Capabilities Class Dominant Condition Aggregation Method

Soils data provided by USDA and NRCS.