

# Total Soils Map

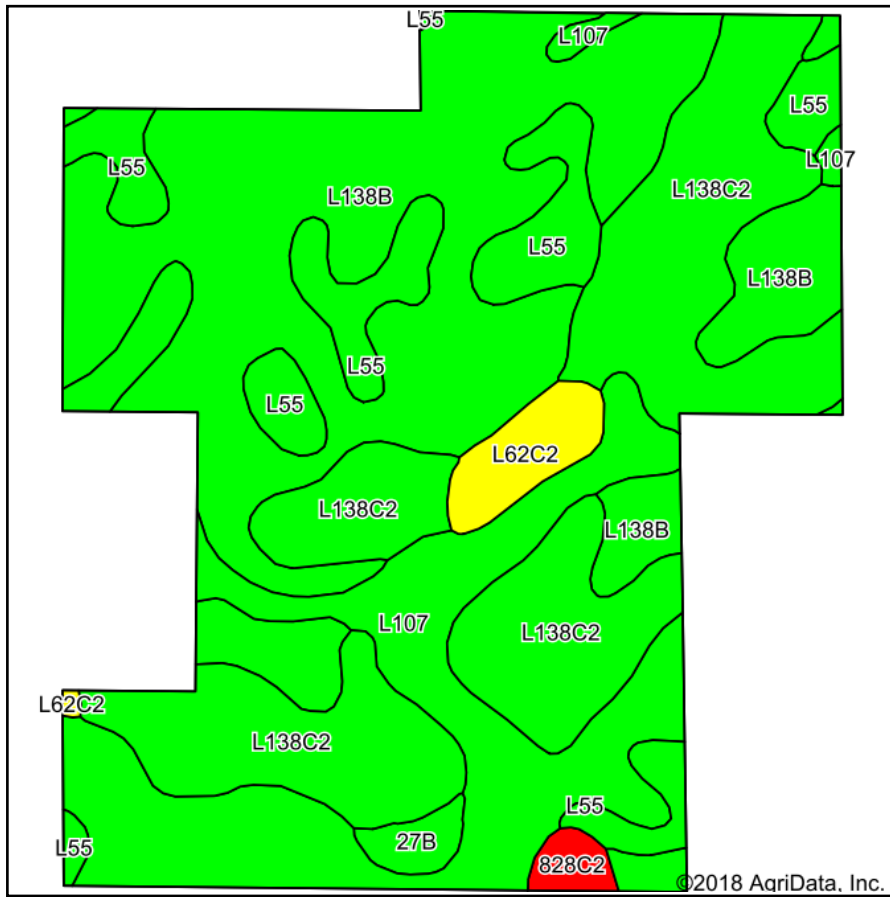

Soils data provided by USDA and NRCS.

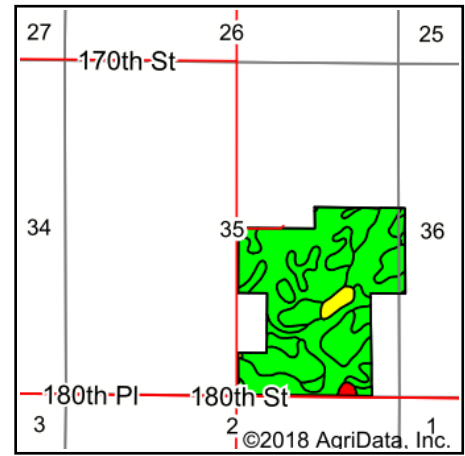

State: **Iowa**  
 County: **Dallas**  
 Location: **35-81N-26W**  
 Township: **Des Moines**  
 Acres: **141.5**  
 Date: **12/11/2018**

**PEOPLES**™  
 COMPANY  
 INNOVATIVE. REAL ESTATE. SOLUTIONS.

Maps Provided By:

**surety**®  
 CUSTOMIZED ONLINE MAPPING  
 © AgriData, Inc. 2018 www.AgriDataInc.com



Area Symbol: IA049, Soil Area Version: 24

Code	Soil Description	Acres	Percent of field	CSR2 Legend	Non-Irr Class *c	CSR2**	CSR	*n NCCPI Corn	*n NCCPI Soybeans
L138B	Clarion loam, Bemis moraine, 2 to 6 percent slopes	54.36	38.4%		Ile	88		79	79
L138C2	Clarion loam, Bemis moraine, 6 to 10 percent slopes, moderately eroded	39.32	27.8%		Ille	83		57	60
L107	Webster clay loam, Bemis moraine, 0 to 2 percent slopes	27.88	19.7%		Ilw	88		77	80
L55	Nicollet loam, 1 to 3 percent slopes	13.99	9.9%		Ie	91		78	83
L62C2	Storden loam, Bemis moraine, 6 to 10 percent slopes, moderately eroded	3.44	2.4%		Ille	64		57	63
27B	Terril loam, 2 to 6 percent slopes	1.37	1.0%		Ile	87	82	91	81
828C2	Zenor sandy loam, 5 to 9 percent slopes, moderately eroded	1.14	0.8%		Ille	45	31	39	33
<b>Weighted Average</b>						<b>86</b>	<b>*-</b>	<b>*n 71.7</b>	<b>*n 73.6</b>

\*\*IA has updated the CSR values for each county to CSR2.

\*- CSR weighted average cannot be calculated on the current soils data, use prior data version for csr values.

\*n: The aggregation method is "Weighted Average using major components"

\*c: Using Capabilities Class Dominant Condition Aggregation Method

Soils data provided by USDA and NRCS.