

Soils Map

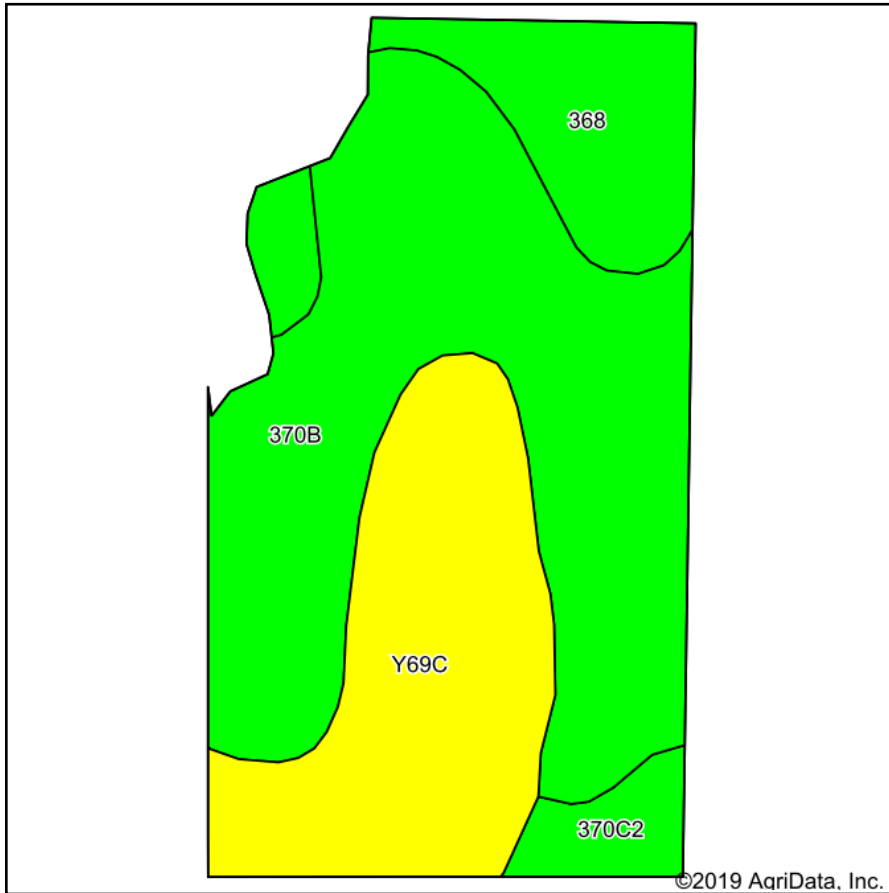

Soils data provided by USDA and NRCS.

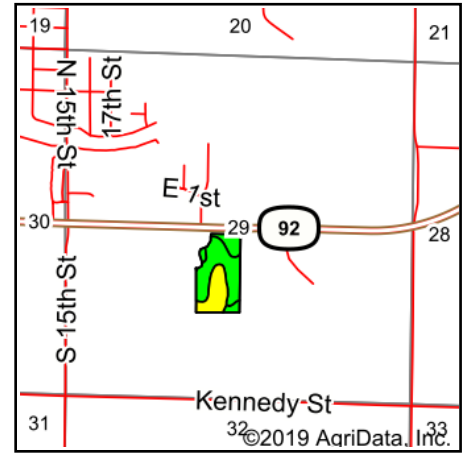

State: **Iowa**
 County: **Warren**
 Location: **29-76N-23W**
 Township: **Lincoln**
 Acres: **17.05**
 Date: **3/13/2019**

PEOPLES
 COMPANY
 INNOVATIVE. REAL ESTATE. SOLUTIONS.

Maps Provided By:



© AgriData, Inc. 2019

www.AgriDataInc.com



Area Symbol: IA181, Soil Area Version: 23

Code	Soil Description	Acres	Percent of field	CSR2 Legend	Non-Irr Class *c	*i Corn	*i Soybeans	CSR2**	CSR	*n NCCPI Overall	*n NCCPI Corn	*n NCCPI Soybeans
370B	Sharpsburg silty clay loam, 2 to 5 percent slopes	8.97	52.6%		IIe	225.6	65.4	91	87	93	93	77
Y69C	Clearfield silty clay loam, dissected till plain, 5 to 9 percent slopes	4.90	28.7%		IIIw			59		78	78	71
368	Macksburg silty clay loam, 0 to 2 percent slopes	2.49	14.6%		Iw	230.4	66.8	93	95	85	85	78
370C2	Sharpsburg silty clay loam, 5 to 9 percent slopes, eroded	0.69	4.0%		IIIe	204.8	59.4	80	67	71	71	63
Weighted Average						160.6	46.6	81.7	*n 86.6	*n 86.6	*n 74.9	

**IA has updated the CSR values for each county to CSR2.

*- CSR weighted average cannot be calculated on the current soils data, use prior data version for csr values.

*i Yield data provided by the ISPAID Database version 8.1.1 developed by IA State University.

*n: The aggregation method is "Weighted Average using major components"

*c: Using Capabilities Class Dominant Condition Aggregation Method

Soils data provided by USDA and NRCS.