

Soils Map

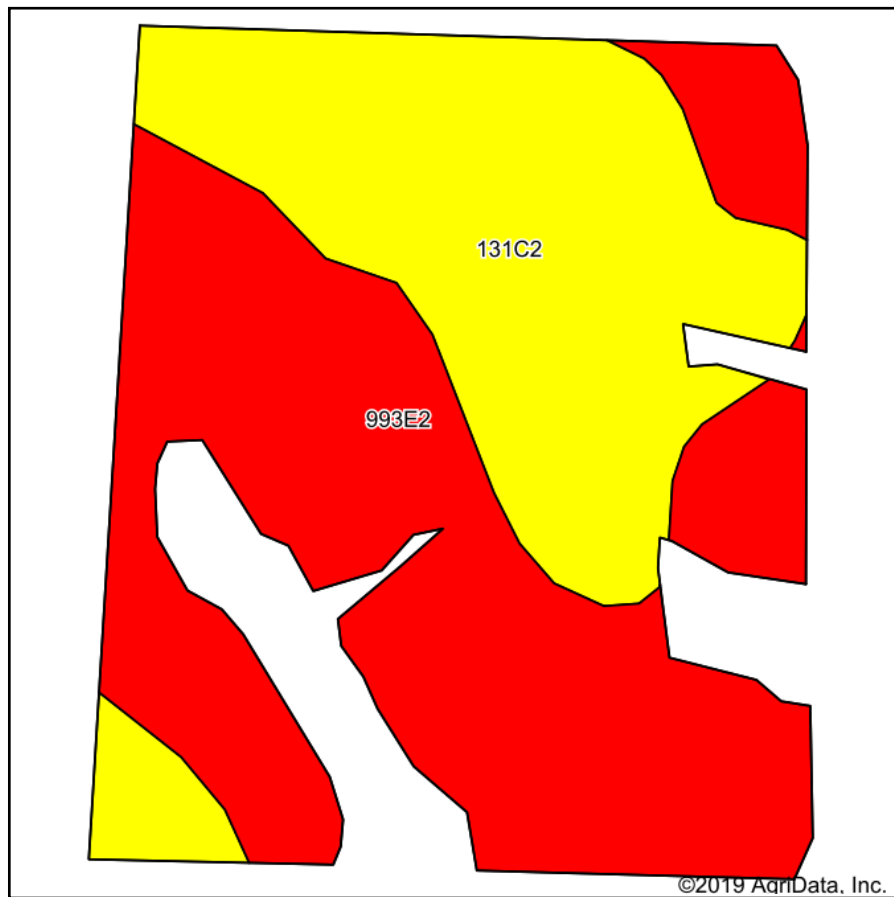

Soils data provided by USDA and NRCS.

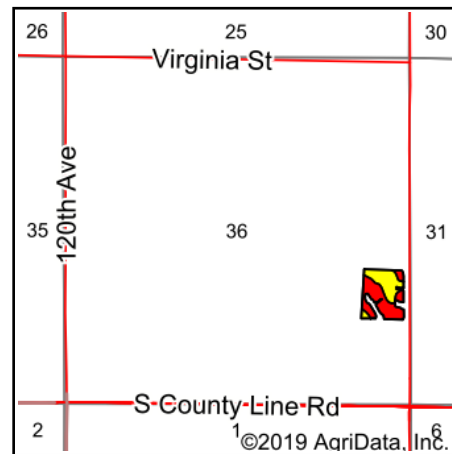

State: **Iowa**
 County: **Warren**
 Location: **36-74N-24W**
 Township: **Squaw**
 Acres: **9.79**
 Date: **4/30/2019**

PEOPLES™
 COMPANY
 INNOVATIVE. REAL ESTATE. SOLUTIONS.

Maps Provided By:

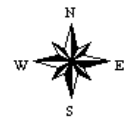

Area Symbol: IA181, Soil Area Version: 23

| Code | Soil Description | Acres | Percent of field | CSR2 Legend | Non-Irr Class *c | *i Corn | *i Soybeans | CSR2** | CSR | *n NCCPI Overall | *n NCCPI Corn | *n NCCPI Soybeans |
|-------------------------|------------------------------------------------------------------|-------|------------------|-------------|------------------|-----------|-------------|-------------|-------------|------------------|----------------|-------------------|
| 993E2 | Armstrong-Gara loams, 14 to 18 percent slopes, moderately eroded | 5.71 | 58.3% | | Vle | 104 | 30.2 | 17 | 5 | 57 | 57 | 41 |
| 131C2 | Pershing silt loam, 5 to 9 percent slopes, moderately eroded | 4.08 | 41.7% | | Ille | 80 | 23.2 | 62 | 50 | 60 | 60 | 49 |
| Weighted Average | | | | | | 94 | 27.3 | 35.8 | 23.8 | *n 58.3 | *n 58.3 | *n 44.3 |

**IA has updated the CSR values for each county to CSR2.

*i Yield data provided by the ISPAID Database version 8.1.1 developed by IA State University.

*n: The aggregation method is "Weighted Average using major components"

*c: Using Capabilities Class Dominant Condition Aggregation Method

Soils data provided by USDA and NRCS.