

# Soils Map

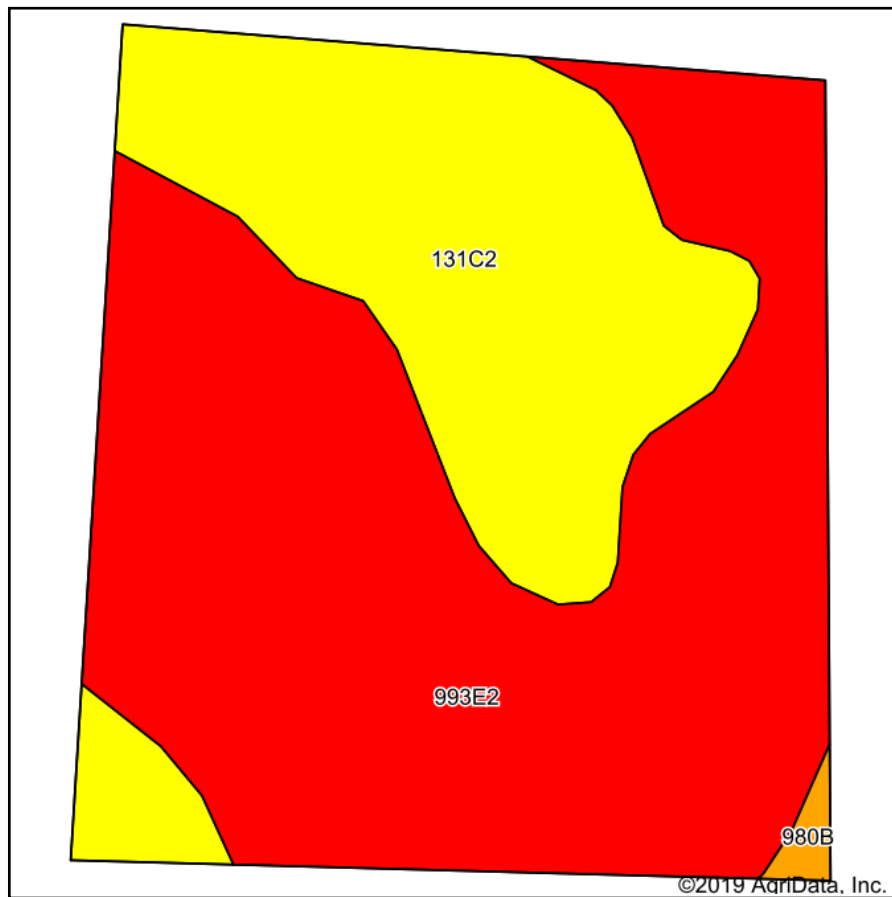

Soils data provided by USDA and NRCS.

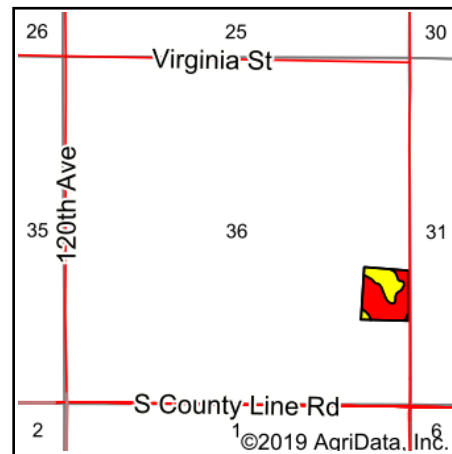

State: **Iowa**  
 County: **Warren**  
 Location: **36-74N-24W**  
 Township: **Squaw**  
 Acres: **13**  
 Date: **4/22/2019**

**PEOPLES**™  
 COMPANY  
 INNOVATIVE. REAL ESTATE. SOLUTIONS.

Maps Provided By:



Area Symbol: IA181, Soil Area Version: 23

Code	Soil Description	Acres	Percent of field	CSR2 Legend	Non-Irr Class *c	*i Corn	*i Soybeans	CSR2**	CSR	*n NCCPI Overall	*n NCCPI Corn	*n NCCPI Soybeans
993E2	Armstrong-Gara loams, 14 to 18 percent slopes, moderately eroded	8.45	65.0%		Vle	104	30.2	17	5	57	57	41
131C2	Pershing silt loam, 5 to 9 percent slopes, moderately eroded	4.46	34.3%		Ille	80	23.2	62	50	60	60	49
980B	Gullied land-Ely-Colo complex, 2 to 5 percent slopes	0.09	0.7%		Vlle	88	25.5	42	25	11	5	5
<b>Weighted Average</b>						<b>95.7</b>	<b>27.8</b>	<b>32.6</b>	<b>20.6</b>	<b>*n 57.7</b>	<b>*n 57.7</b>	<b>*n 43.5</b>

\*\*IA has updated the CSR values for each county to CSR2.

\*i Yield data provided by the ISPAID Database version 8.1.1 developed by IA State University.

\*n: The aggregation method is "Weighted Average using major components"

\*c: Using Capabilities Class Dominant Condition Aggregation Method

Soils data provided by USDA and NRCS.