

# Soils Map

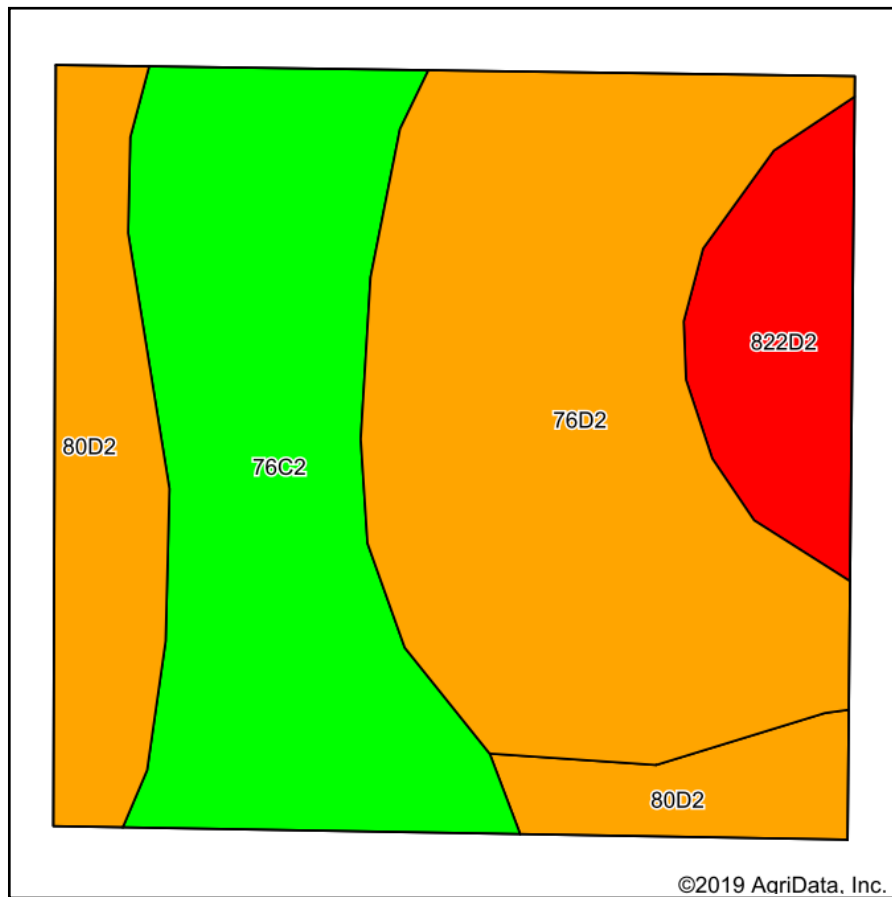

Soils data provided by USDA and NRCS.

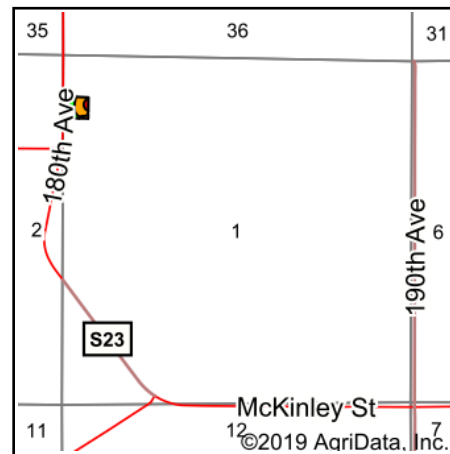

State: **Iowa**  
 County: **Warren**  
 Location: **1-75N-23W**  
 Township: **Otter**  
 Acres: **2.5**  
 Date: **4/30/2019**

**PC PEOPLES**™  
 COMPANY  
 INNOVATIVE. REAL ESTATE. SOLUTIONS.

Maps Provided By:

**surety**®  
 CUSTOMIZED ONLINE MAPPING  
 © AgriData, Inc. 2019 www.AgriDataInc.com



## Area Symbol: IA181, Soil Area Version: 23

Code	Soil Description	Acres	Percent of field	CSR2 Legend	Non-Irr Class *c	*i Corn	*i Soybeans	CSR2**	CSR	*n NCCPI Overall	*n NCCPI Corn	*n NCCPI Soybeans
76D2	Ladoga silt loam, 9 to 14 percent slopes, eroded	1.04	41.6%		IIIe	163.2	47.3	49	55	61	61	59
76C2	Ladoga silt loam, dissected till plain, 5 to 9 percent slopes, eroded	0.79	31.6%		IIIe	192	55.7	75	65	64	64	63
80D2	Clinton silt loam, 9 to 14 percent slopes, eroded	0.43	17.2%		IIIe	158.4	45.9	46	50	58	58	56
822D2	Lamoni silty clay loam, 9 to 14 percent slopes, eroded	0.24	9.6%		IVe	100.8	29.2	10	15	53	53	40
<b>Weighted Average</b>						<b>165.5</b>	<b>48</b>	<b>53</b>	<b>53.5</b>	<b>*n 60.7</b>	<b>*n 60.7</b>	<b>*n 57.9</b>

\*\*IA has updated the CSR values for each county to CSR2.

\*i Yield data provided by the ISPAID Database version 8.1.1 developed by IA State University.

\*n: The aggregation method is "Weighted Average using major components"

\*c: Using Capabilities Class Dominant Condition Aggregation Method

Soils data provided by USDA and NRCS.