

Soils Map

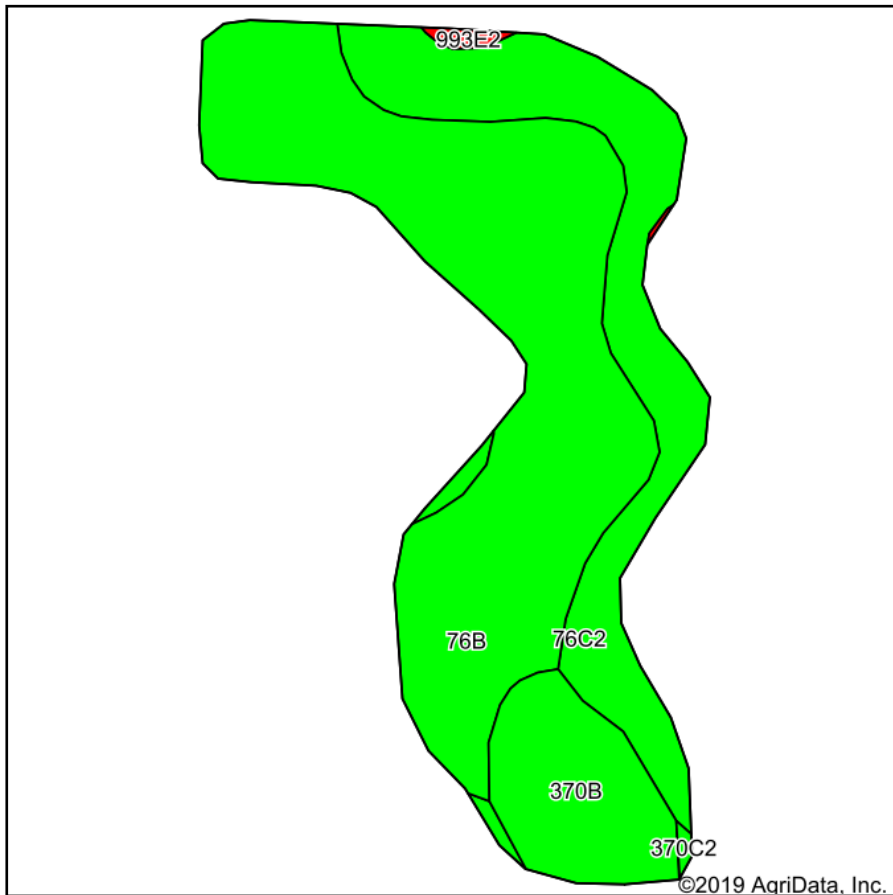

Soils data provided by USDA and NRCS.

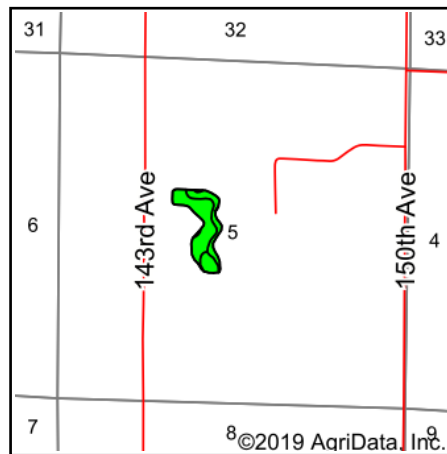

State: **Iowa**
 County: **Warren**
 Location: **5-76N-23W**
 Township: **Lincoln**
 Acres: **11.5**
 Date: **5/31/2019**



Area Symbol: IA181, Soil Area Version: 23

Code	Soil Description	Acres	Percent of field	CSR2 Legend	Non-Irr Class *c	CSR2**	CSR	*n NCCPI Overall	*n NCCPI Soybeans
76B	Ladoga silt loam, 2 to 5 percent slopes	6.76	58.8%		Ile	86	85	82	78
76C2	Ladoga silt loam, dissected till plain, 5 to 9 percent slopes, eroded	3.19	27.7%		IIle	75	65	64	63
370B	Sharpsburg silty clay loam, 2 to 5 percent slopes	1.48	12.9%		Ile	91	87	93	77
993E2	Armstrong-Gara loams, 14 to 18 percent slopes, moderately eroded	0.07	0.6%		VIe	17	5	57	41
Weighted Average						83.2	79.2	*n 78.3	*n 73.5

**IA has updated the CSR values for each county to CSR2.

*n: The aggregation method is "Weighted Average using major components"

*c: Using Capabilities Class Dominant Condition Aggregation Method

Soils data provided by USDA and NRCS.