

IOWA HIGHWAY 3

3

MAP OF COUNTY DRAIN NO. 3  
MARION TOWNSHIP  
SECTION 31  
FRANKLIN COUNTY

- Intake
- Private Tile
- 12" Main

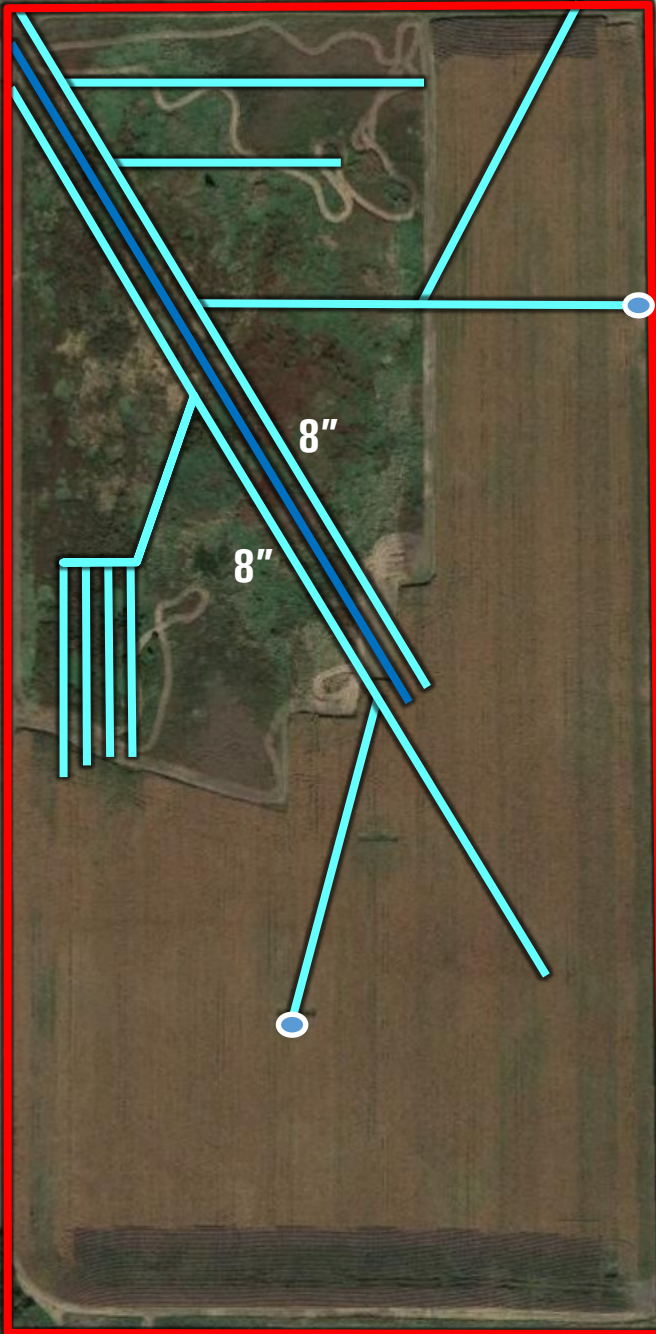

HEATHER AVENUE

Heather Ave

Rolling-Prairie-Trail

S25

Gull Ave

Main St