

Tillable Soils Map

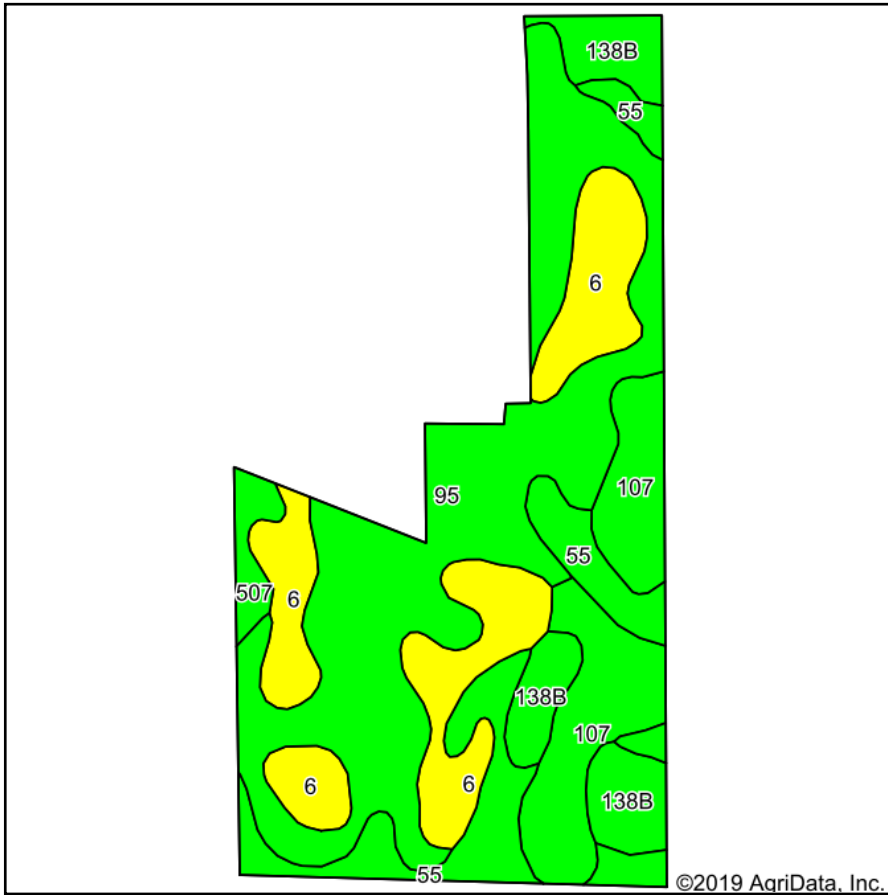

Soils data provided by USDA and NRCS.

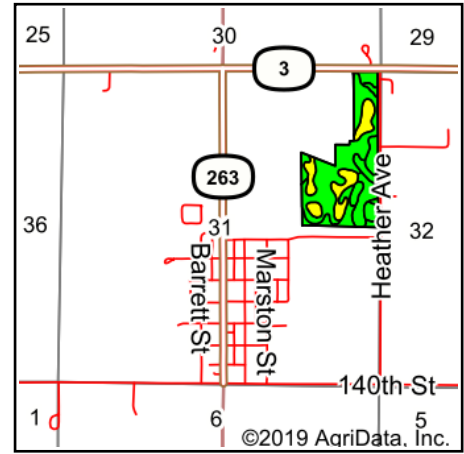

State: **Iowa**
 County: **Franklin**
 Location: **31-92N-21W**
 Township: **Marion**
 Acres: **48.69**
 Date: **6/17/2019**



Maps Provided By:



© AgriData, Inc. 2019

www.AgriDataInc.com



Area Symbol: IA069, Soil Area Version: 25									
Code	Soil Description	Acres	Percent of field	CSR2 Legend	Non-Irr Class *c	CSR2**	CSR	*n NCCPI Overall	
95	Harps clay loam, 0 to 2 percent slopes	19.52	40.1%		IIw	72	63	77	
6	Okoboji silty clay loam, 0 to 1 percent slopes	10.10	20.7%		IIIw	59	57	80	
107	Webster clay loam, 0 to 2 percent slopes	6.95	14.3%		IIw	86	84	80	
55	Nicollet clay loam, 1 to 3 percent slopes	6.71	13.8%		Iw	89	89	82	
138B	Clarion loam, 2 to 6 percent slopes	4.39	9.0%		Ile	89	82	83	
507	Canisteo clay loam, 0 to 2 percent slopes	1.02	2.1%		IIw	84	79	79	
Weighted Average						75.4	70.4	*n 79.3	

**IA has updated the CSR values for each county to CSR2.

*n: The aggregation method is "Weighted Average using major components"

*c: Using Capabilities Class Dominant Condition Aggregation Method

Soils data provided by USDA and NRCS.