

Tillable Soils Map

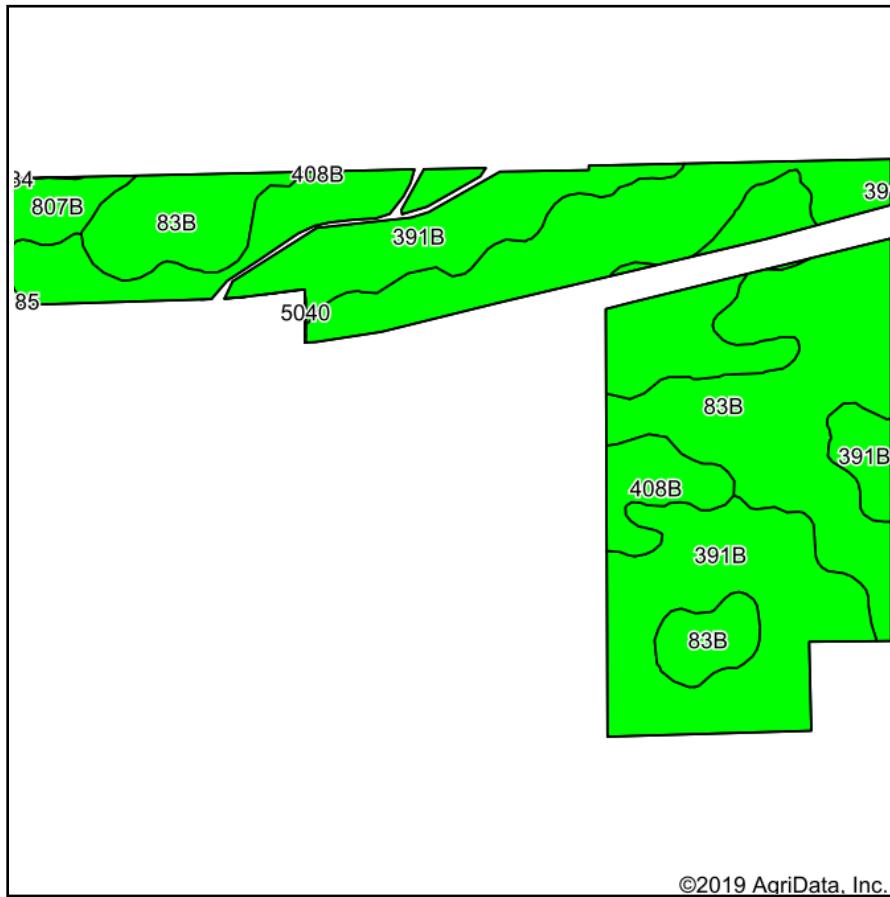

Soils data provided by USDA and NRCS.

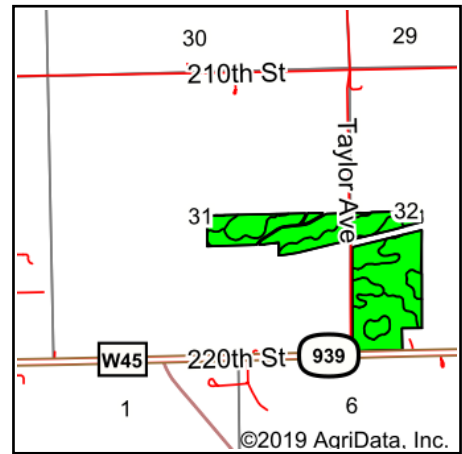

State: **Iowa**
 County: **Buchanan**
 Location: **31-89N-7W**
 Township: **Fremont**
 Acres: **104.52**
 Date: **6/14/2019**



Maps Provided By:



Area Symbol: IA019. Soil Area Version: 24							
Code	Soil Description	Acres	Percent of field	CSR2 Legend	Non-Irr Class *c	CSR2**	CSR
391B	Clyde-Floyd complex, 1 to 4 percent slopes	49.63	47.5%		Ilw	87	76
83B	Kenyon loam, 2 to 5 percent slopes	47.94	45.9%		Ile	90	86
408B	Olin fine sandy loam, 2 to 5 percent slopes	4.20	4.0%		Ile	74	67
807B	Schley variant sandy loam, 1 to 4 percent slopes	2.66	2.5%		Ilw	66	50
585	Spillville-Coland complex, 0 to 2 percent slopes	0.09	0.1%		Ilw	76	80
Weighted Average						87.3	79.6

**IA has updated the CSR values for each county to CSR2.

*c: Using Capabilities Class Dominant Condition Aggregation Method
 Soils data provided by USDA and NRCS.