

T-80-N

ALLENS GROVE PLAT

(Landowners)

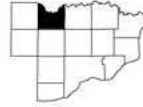

R-2-E

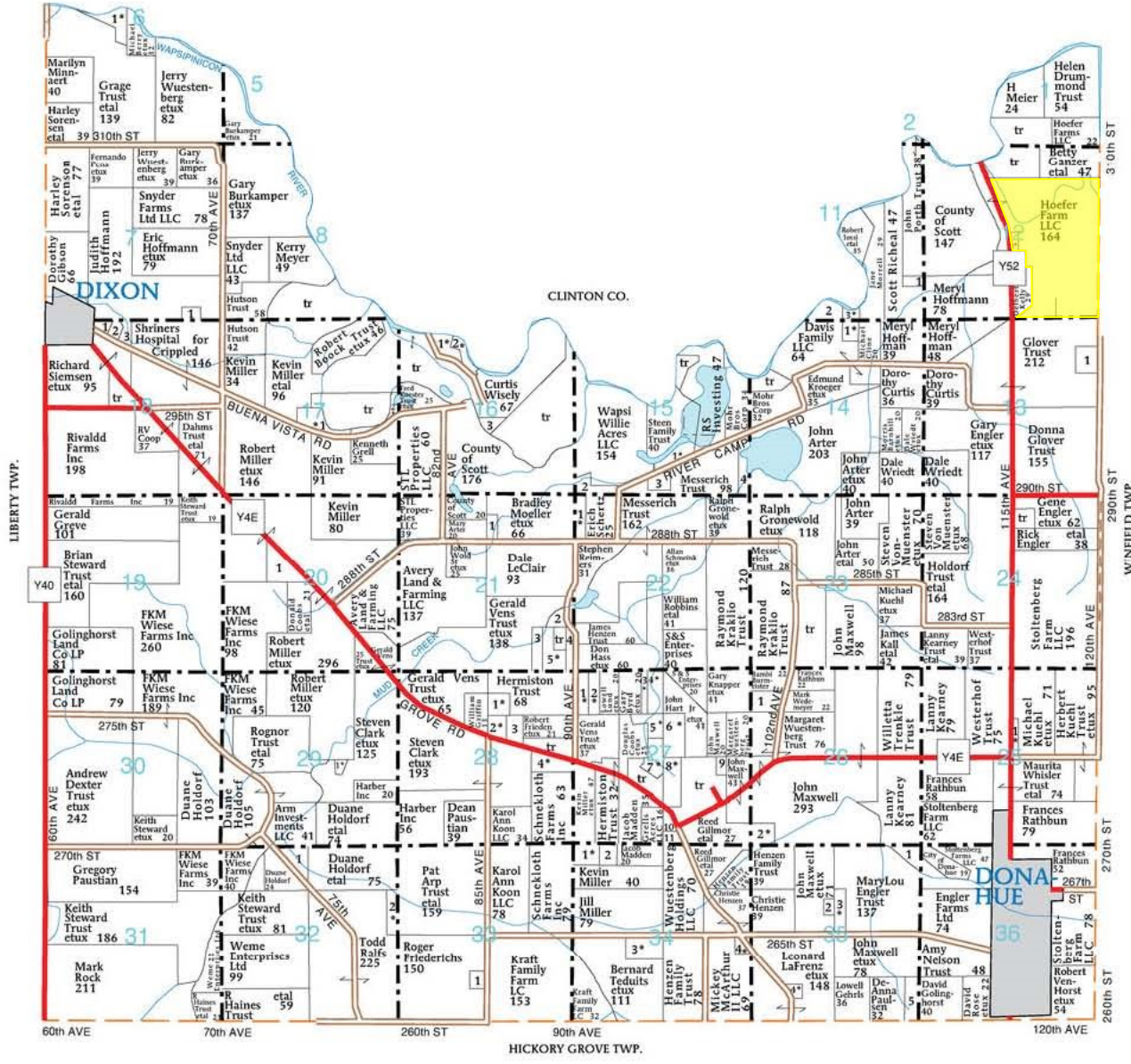

ALLENS GROVE TOWNSHIP

- SECTION 6**
1. Halsey, James etux 18
- SECTION 7**
1. Bierman, Matthew 6
- SECTION 11**
1. Hoffman, Meryl 8
2. Davis Family LLC 10
3. Fifer, Nancy etal 5
- SECTION 12**
1. Wegener, Dirk etux 11
- SECTION 13**
1. MCG Trust 10
- SECTION 14**
1. Fifer, Kirk etux 10

- SECTION 15**
1. Tuftee, Roger etux 8
2. Rohrer Jr, Albert 34
3. Ryan Trust 5
4. Arter, John 14
- SECTION 16**
1. Wiggins, Lyle etux 15
2. Gliosci, Michael etux 9
3. Braet, Ruth 6
- SECTION 17**
1. Shachow Trust, Oleg etux 91
- SECTION 18**
2. Kuester Trust, Fred etux 5
- SECTION 18**
1. Hoffman, Judith 5
2. City of Dixon 7
3. Hoffman, Judith 7

- SECTION 20**
1. RH&K Enterprises 15
- SECTION 21**
1. Ewoldt, Jerry 12
2. Robinson-Kramer, Kathy 11
3. Hammes, Wilfred 9
4. West, Barbara 7
5. Kramer, John etux 23
- SECTION 22**
1. Wold, John etal 8
- SECTION 25**
1. Seifert, James etux 6
- SECTION 26**
1. Wuestenberg, Jerry 11
2. Gillmor, Reed etal 14

- SECTION 27**
1. Meyer, Christopher etux 9
2. Gephart, Jason etux 10
3. Wiese, Michael etal 6
4. McKinney, Greg etux 13
5. Heart Shot Ministres 11
6. VonMuenster, Steven etux 23
7. Onken, Matthew etux 17
8. Altenhofen, Donavon etal 20
9. Mahoney Trust, Mary 5
10. Jungwirth, Jane 8
11. Wuestenberg Holdings LLC 5

- SECTION 28**
1. Engel, James etux 10
2. Karnish, Thomas etux 13
3. Steffe, Garry 12
4. Karnish, Thomas etux 13
- SECTION 29**
1. Rognor Trust 18
- SECTION 32**
1. Arm Investments LLC 12
- SECTION 33**
2. Arp Trust, Pat etal 10
- SECTION 34**
1. Crossroads Development Co 6
1. Miller, Kevin etux 13

- 2. Hermiston Trust 7
3. Wuestenberg, Roger etux 15
4. Keppy, Neal etux 8
- SECTION 35**
1. Stoltenberg Farm LLC 9
2. Maxwell, John 6
3. Wiese, Michael etal 12
4. Duncan, Curtis etal 6
5. Golinghorst, David 13