

# Soils Map

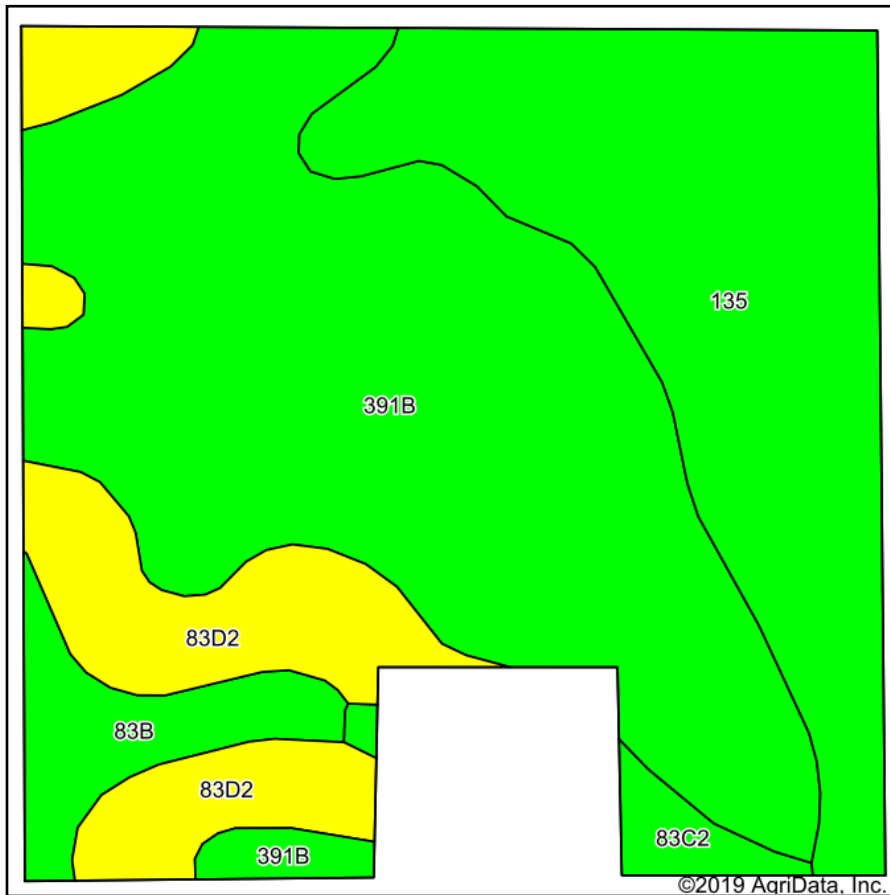

Soils data provided by USDA and NRCS.

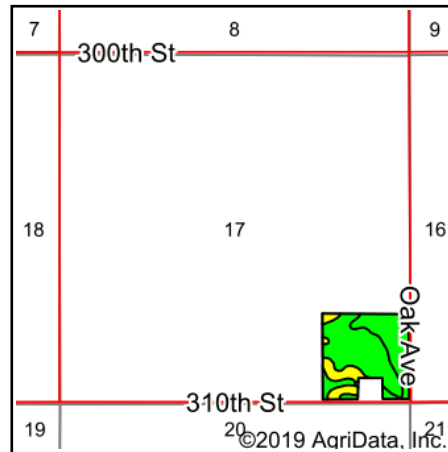

State: **Iowa**  
 County: **Butler**  
 Location: **17-90N-16W**  
 Township: **Albion**  
 Acres: **36.07**  
 Date: **7/31/2019**



Maps Provided By:



© AgriData, Inc. 2019

www.AgriDataInc.com

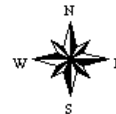

Area Symbol: IA023. Soil Area Version: 24

Code	Soil Description	Acres	Percent of field	CSR2 Legend	Non-Irr Class *c	*i Corn	*i Soybeans	CSR2**	CSR	Corn	Soybeans	*n NCCPI Overall	*n NCCPI Corn	*n NCCPI Soybeans
391B	Clyde-Floyd complex, 1 to 4 percent slopes	17.62	48.8%	Green	llw	216	62.6	87	72			86	86	79
135	Coland clay loam, 0 to 2 percent slopes	10.83	30.0%	Green	llw	198.4	57.5	74	80			94	94	89
83D2	Kenyon loam, 9 to 14 percent slopes, eroded	5.08	14.1%	Yellow	llle	176	51	61	58			64	64	56
83B	Kenyon loam, 2 to 5 percent slopes	1.85	5.1%	Green	lle	225.6	65.4	90	85	210	61	84	84	75
83C2	Kenyon loam, 5 to 9 percent slopes, eroded	0.69	1.9%	Green	llle	204.8	59.4	84	68	212	61	68	68	60
<b>Weighted Average</b>						<b>205.4</b>	<b>59.5</b>	<b>79.5</b>	<b>73</b>	<b>14.8</b>	<b>4.3</b>	<b>*n 84.9</b>	<b>*n 84.9</b>	<b>*n 78.2</b>

\*\*IA has updated the CSR values for each county to CSR2.

\*i Yield data provided by the ISPAID Database version 8.1.1 developed by IA State University.

\*n: The aggregation method is "Weighted Average using major components"

\*c: Using Capabilities Class Dominant Condition Aggregation Method

Soils data provided by USDA and NRCS.