

Soils Map

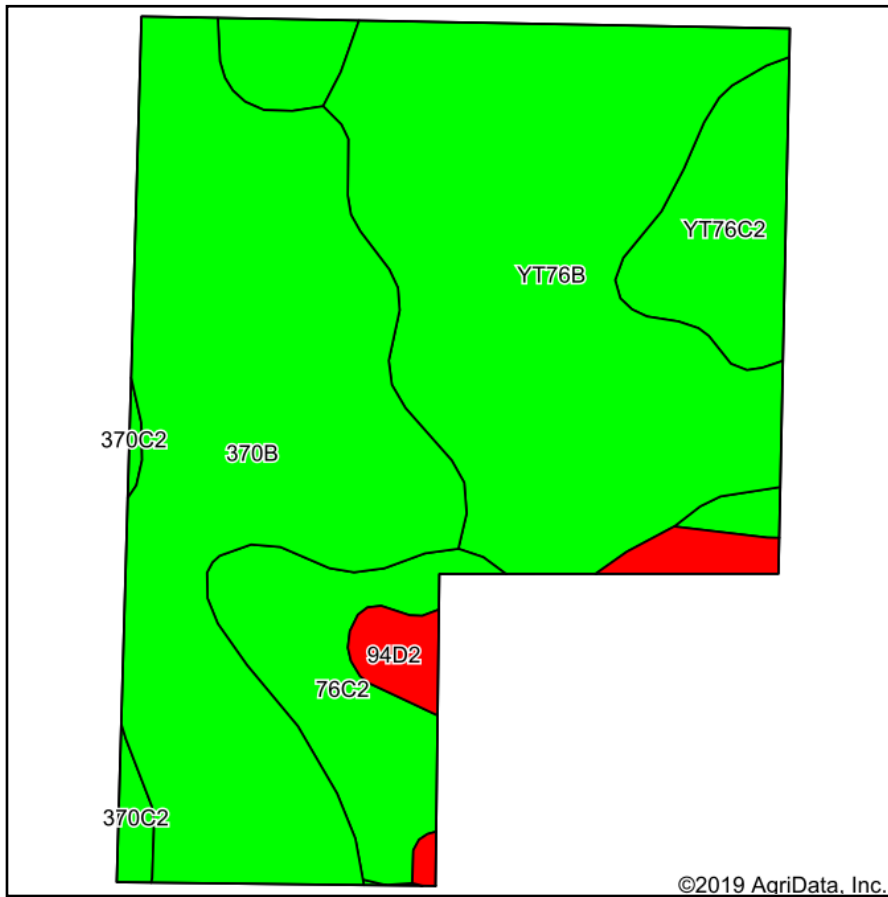

Soils data provided by USDA and NRCS.

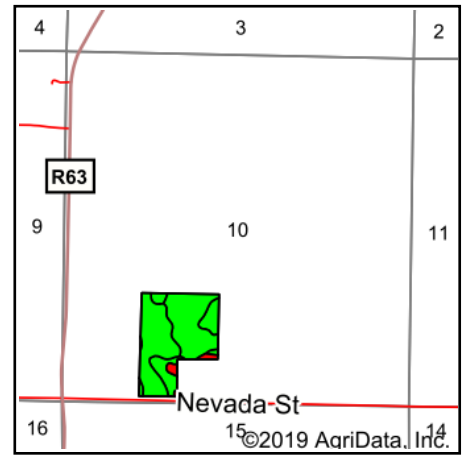

State: **Iowa**
 County: **Warren**
 Location: **10-75N-24W**
 Township: **White Oak**
 Acres: **35**
 Date: **7/31/2019**

PC PEOPLES
 COMPANY
 INNOVATIVE. REAL ESTATE. SOLUTIONS.

Maps Provided By:

surety
 CUSTOMIZED ONLINE MAPPING
 © AgriData, Inc. 2019 www.AgriDataInc.com



Area Symbol: IA181, Soil Area Version: 23												
Code	Soil Description	Acres	Percent of field	CSR2 Legend	Non-Irr Class *c	*i Corn	*i Soybeans	CSR2**	CSR	*n NCCPI Overall	*n NCCPI Corn	*n NCCPI Soybeans
370B	Sharpsburg silty clay loam, 2 to 5 percent slopes	13.47	38.5%		Ile	225.6	65.4	91	87	93	93	77
YT76B	Ladoga silt loam, terrace on dissected till plain, 2 to 5 percent slopes	13.22	37.8%		Ile			86		82	82	78
YT76C2	Ladoga silt loam, terrace on dissected till plain, 5 to 9 percent slopes, eroded	3.57	10.2%		IIle			78		64	64	63
76C2	Ladoga silt loam, dissected till plain, 5 to 9 percent slopes, eroded	3.22	9.2%		IIle	192	55.7	75	65	64	64	63
94D2	Mystic-Caleb complex, 9 to 14 percent slopes, moderately eroded	1.12	3.2%		IVe	120	34.8	25	25	61	61	48
370C2	Sharpsburg silty clay loam, 5 to 9 percent slopes, eroded	0.40	1.1%		IIle	204.8	59.4	80	67	71	71	63
Weighted Average						110.7	32.1	84.1	*-	*n 81.9	*n 81.9	*n 73.6

**IA has updated the CSR values for each county to CSR2.

*- CSR weighted average cannot be calculated on the current soils data, use prior data version for csr values.

*i Yield data provided by the ISPAID Database version 8.1.1 developed by IA State University.

*n: The aggregation method is "Weighted Average using major components"

*c: Using Capabilities Class Dominant Condition Aggregation Method

Soils data provided by USDA and NRCS.