

Soils Map

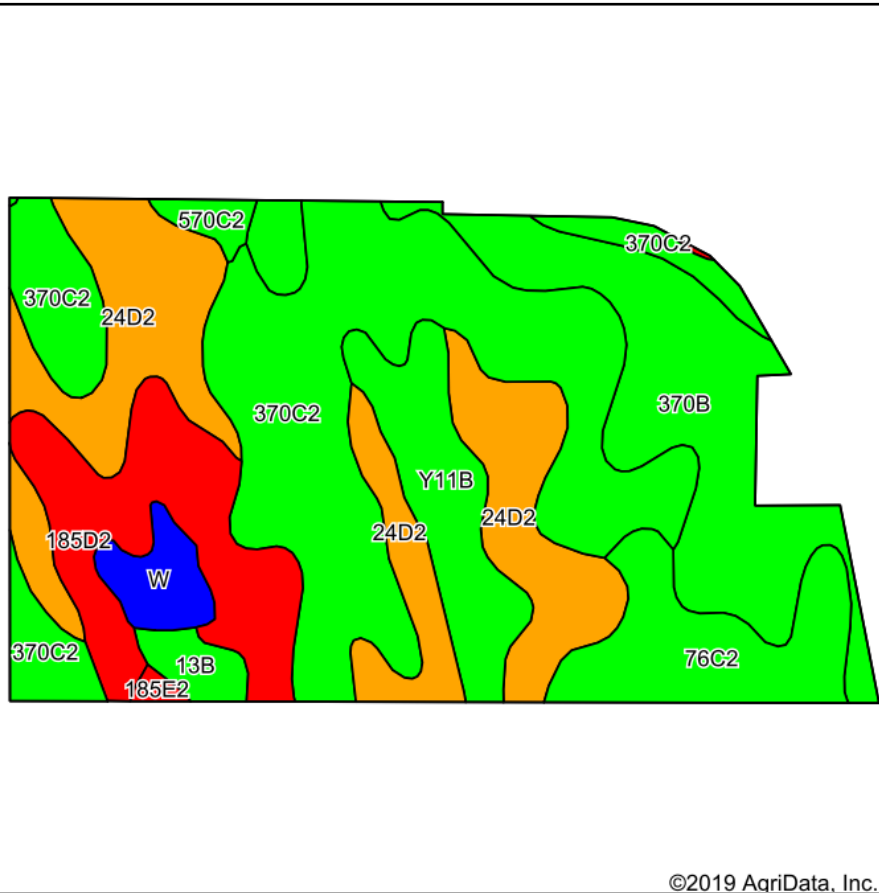

©2019 AgriData, Inc.

Soils data provided by USDA and NRCS.

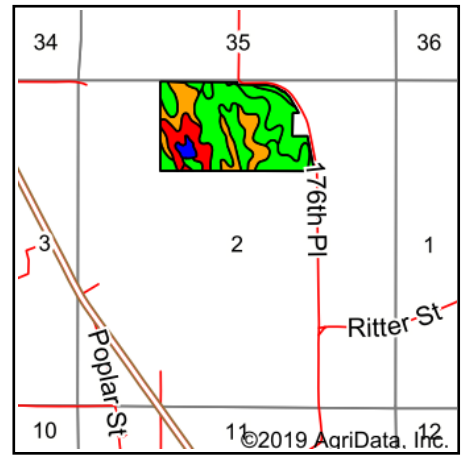

State: **Iowa**
 County: **Marion**
 Location: **2-74N-19W**
 Township: **Indiana**
 Acres: **78.22**
 Date: **9/12/2019**



Maps Provided By:



© AgriData, Inc. 2019

www.AgriDataInc.com



Area Symbol: IA125. Soil Area Version: 27													
Code	Soil Description	Acres	Percent of field	CSR2 Legend	Non-Irr Class *c	*i Corn	*i Soybeans	CSR2**	CSR	*n NCCPI Overall	*n NCCPI Corn	*n NCCPI Soybeans	
370C2	Sharpsburg silty clay loam, 5 to 9 percent slopes, eroded	25.59	32.7%		IIIe	204.8	59.4	80	67	71	71	63	
24D2	Shelby loam, 9 to 14 percent slopes, moderately eroded	15.95	20.4%		IIIe	168	48.7	45	48	58	58	52	
370B	Sharpsburg silty clay loam, 2 to 5 percent slopes	12.70	16.2%		Ile	225.6	65.4	91	87	93	93	77	
185D2	Bauer silt loam, 9 to 14 percent slopes, moderately eroded	8.48	10.8%		VIe	124.8	36.2	13	20	22	22	13	
76C2	Ladoga silt loam, 5 to 9 percent slopes, eroded	6.10	7.8%		IIIe	192	55.7	75	65	76	76	64	
Y11B	Colo, occasionally flooded-Ely silty clay loams, dissected till plain, 2 to 5 percent slopes	5.47	7.0%		IIw	0	0	80		96	96	80	
W	Water	1.81	2.3%			0	0	0	0		0	0	
13B	Nodaway-Vesser silt loams, 2 to 5 percent slopes	1.15	1.5%		IIw	190.4	55.2	79	63	91	91	83	
570C2	Nira silty clay loam, 5 to 9 percent slopes, moderately eroded	0.72	0.9%		IIIe	187.2	54.3	72	67	80	80	69	
185E2	Bauer silt loam, 14 to 18 percent slopes, moderately eroded	0.25	0.3%		VIIe	115.2	33.4	5	10	20	20	12	
Weighted Average						171.3	49.7	64.8	*	*n 67.3	*n 67.3	*n 57.6	

**IA has updated the CSR values for each county to CSR2.

*. CSR weighted average cannot be calculated on the current soils data, use prior data version for csr values.

*i Yield data provided by the ISPAID Database version 8.1.1 developed by IA State University.

*n: The aggregation method is "Weighted Average using major components"

*c: Using Capabilities Class Dominant Condition Aggregation Method

Soils data provided by USDA and NRCS.