

Tillable Soils Map

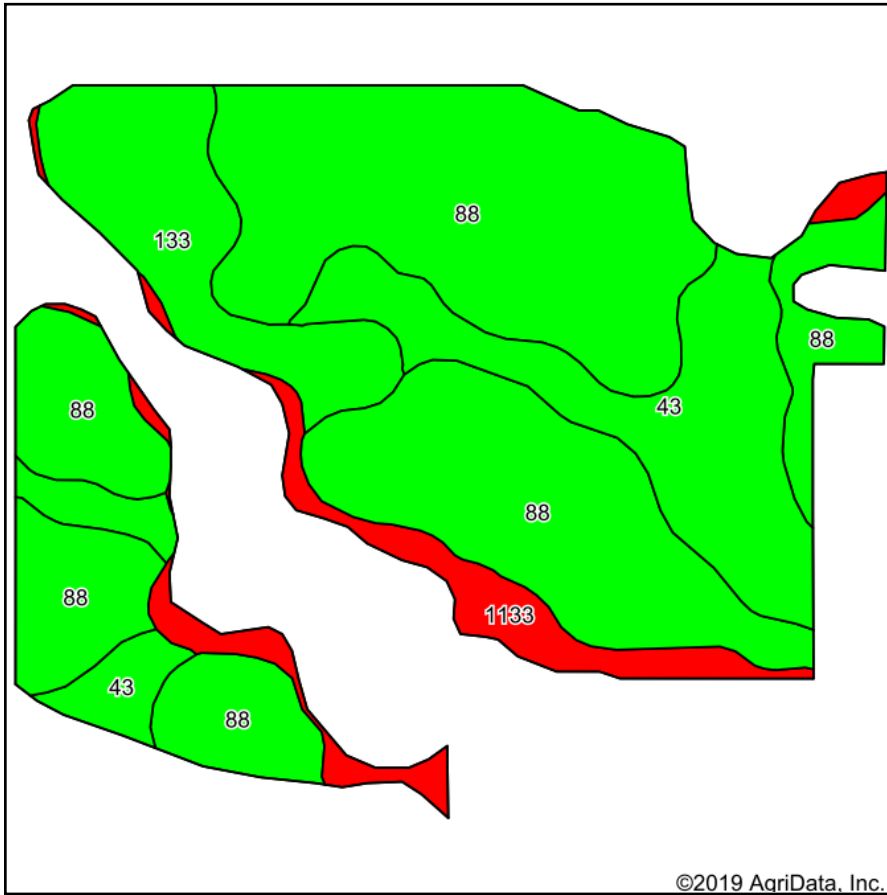

Soils data provided by USDA and NRCS.

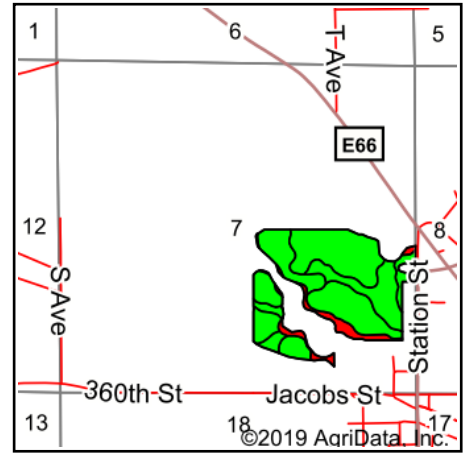

State: **Iowa**
 County: **Tama**
 Location: **7-82N-13W**
 Township: **Salt Creek**
 Acres: **83.61**
 Date: **10/9/2019**



Maps Provided By:



Area Symbol: IA171, Soil Area Version: 23							
Cod e	Soil Description	Acres	Percent of field	CSR2 Legend	Non-Irr Class *c	CSR2**	CSR
88	Nevin silty clay loam, 0 to 2 percent slopes	51.55	61.7%		Iw	95	90
43	Bremer silty clay loam, 0 to 2 percent slopes	15.66	18.7%		Ilw	74	82
133	Colo silty clay loam, 0 to 2 percent slopes, occasionally flooded	9.50	11.4%		Ilw	78	85
1133	Colo silty clay loam, channeled, 0 to 2 percent slopes, frequently flooded	6.90	8.3%		Ilw	5	25
Weighted Average						81.7	82.6

**IA has updated the CSR values for each county to CSR2.

*c: Using Capabilities Class Dominant Condition Aggregation Method

Soils data provided by USDA and NRCS.