

# Soils Map

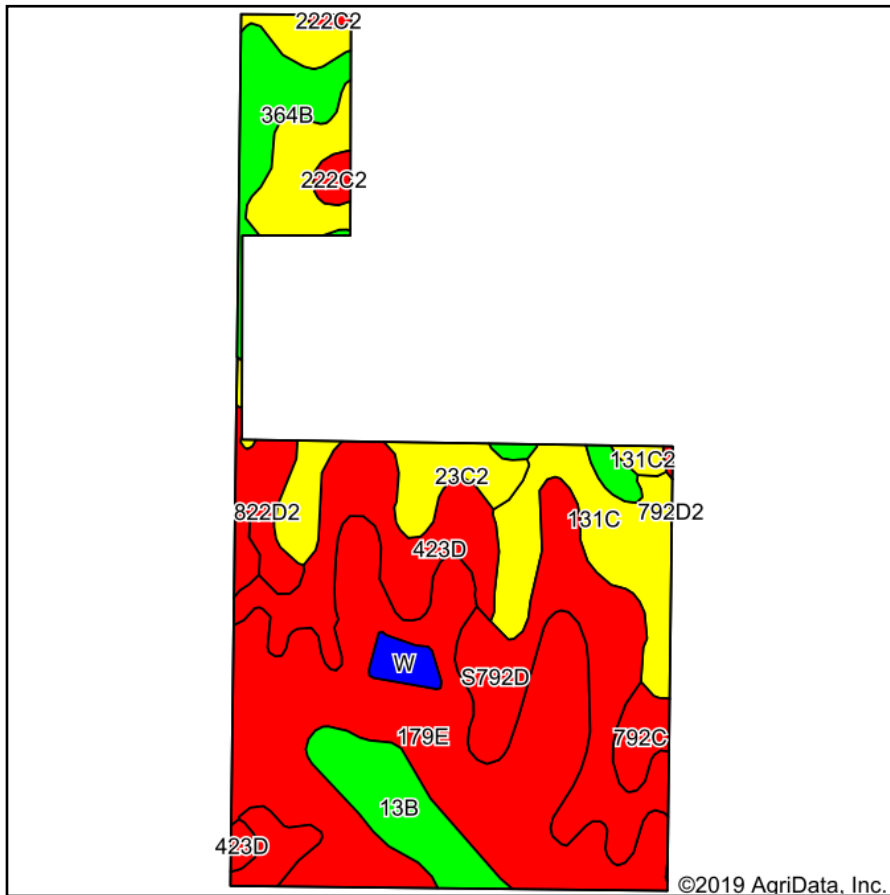

Soils data provided by USDA and NRCS.

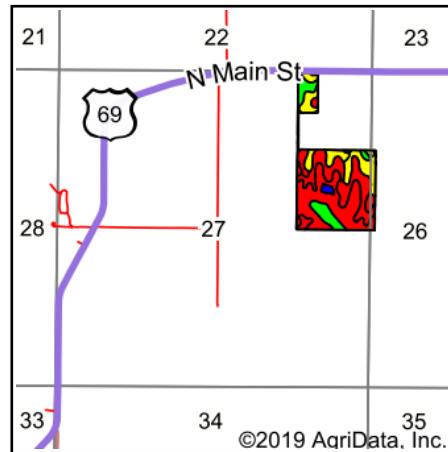

State: **Iowa**  
 County: **Clarke**  
 Location: **27-73N-25W**  
 Township: **Fremont**  
 Acres: **45.5**  
 Date: **11/1/2019**



Maps Provided By:



© AgriData, Inc. 2019

www.AgriDataInc.com



Area Symbol: IA039. Soil Area Version: 25												
Code	Soil Description	Acres	Percent of field	CSR2 Legend	Non-Irr Class *c	*i Corn	*i Soybeans	CSR2**	CSR	*n NCCPI Overall	*n NCCPI Corn	*n NCCPI Soybeans
179E	Gara loam, 14 to 18 percent slopes	15.83	34.8%		Vle	144	41.8	30	30	68	68	52
S792D	Armstrong loam, 9 to 14 percent slopes	6.87	15.1%		IVe	0	0	10		70	70	52
23C2	Arispe silty clay loam, 5 to 9 percent slopes, moderately eroded	5.06	11.1%		IIIe	80	23.2	62	50	82	82	74
423D	Bucknell silty clay loam, 9 to 14 percent slopes	4.79	10.5%		IVe	102.4	29.7	11	18	63	63	46
131C	Pershing silt loam, 5 to 9 percent slopes	4.15	9.1%		IIIe	80	23.2	65	49	72	72	61
364B	Grundy silty clay loam, 2 to 5 percent slopes	2.70	5.9%		Ile	80	23.2	72	75	77	77	69
13B	Olmitz-Zook-Colo complex, 0 to 5 percent slopes	2.67	5.9%		IIw	192	55.7	77	60	86	86	73
822D2	Lamoni clay loam, 9 to 14 percent slopes, moderately eroded	1.32	2.9%		IVe	100.8	29.2	11	15	58	58	42
792C	Armstrong loam, 5 to 9 percent slopes	0.86	1.9%		IIIe	128	37.1	35	31	65	65	49
W	Water	0.56	1.2%			0	0	0	0		0	0
222C2	Clarinda silty clay loam, 5 to 9 percent slopes, moderately eroded	0.44	1.0%		IVw	140.8	40.8	28	25	45	45	38
131C2	Pershing silty clay loam, 5 to 9 percent slopes, moderately eroded	0.25	0.5%		IIIe	80	23.2	62	45	59	59	55
<b>Weighted Average</b>						<b>100.2</b>	<b>29.1</b>	<b>36.3</b>	<b>*-</b>	<b>*n 69.8</b>	<b>*n 69.8</b>	<b>*n 55.8</b>

\*\*IA has updated the CSR values for each county to CSR2.

\*- CSR weighted average cannot be calculated on the current soils data, use prior data version for csr values.

\*i Yield data provided by the ISPAID Database version 8.1.1 developed by IA State University.

\*n: The aggregation method is "Weighted Average using major components"

\*c: Using Capabilities Class Dominant Condition Aggregation Method

Soils data provided by USDA and NRCS.