

Soils Map

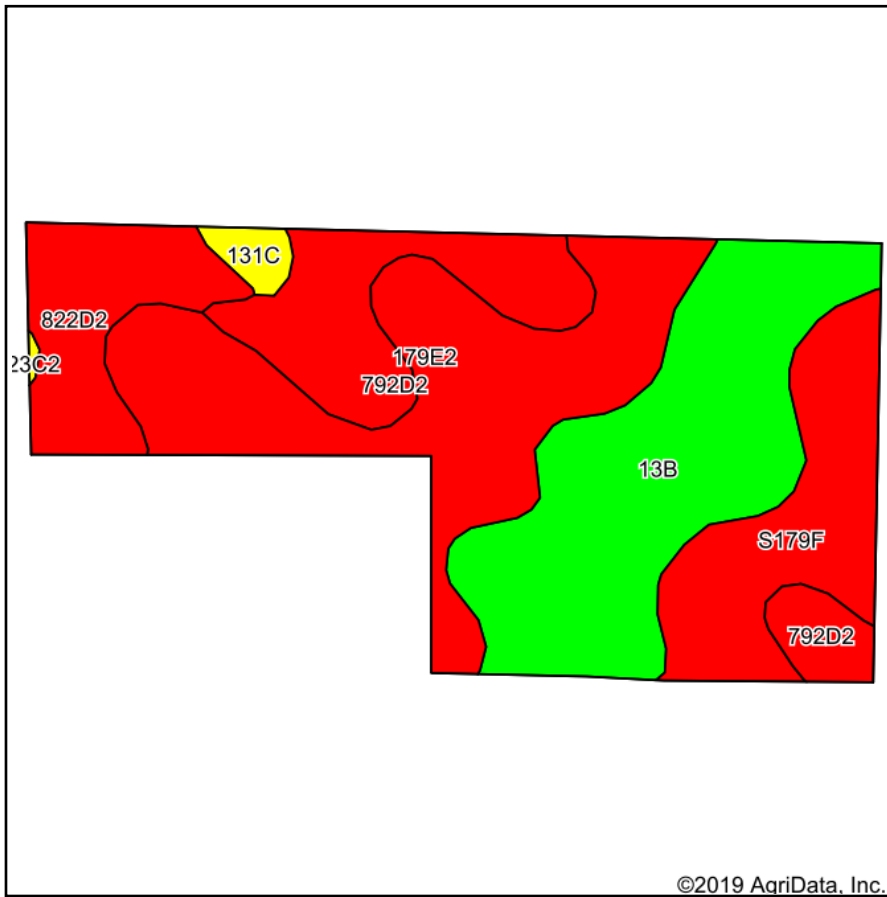

Soils data provided by USDA and NRCS.

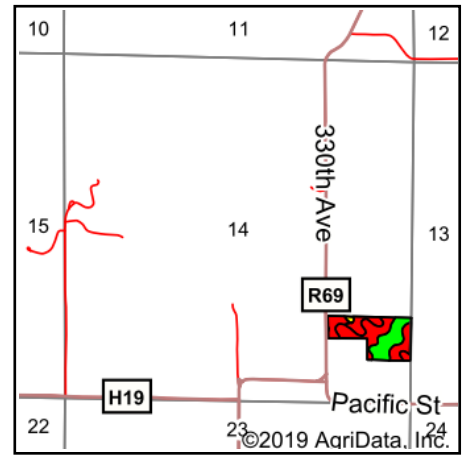

State: **Iowa**
 County: **Clarke**
 Location: **14-73N-24W**
 Township: **Liberty**
 Acres: **15**
 Date: **10/31/2019**



Maps Provided By:



Area Symbol: IA039. Soil Area Version: 24												
Code	Soil Description	Acres	Percent of field	CSR2 Legend	Non-Irr Class *c	*i Corn	*i Soybeans	CSR2**	CSR	*n NCCPI Overall	*n NCCPI Corn	*n NCCPI Soybeans
13B	Olmitz-Zook-Colo complex, 0 to 5 percent slopes	4.48	29.9%		IIw	192	55.7	77	60	86	86	73
179E2	Gara clay loam, 14 to 18 percent slopes, moderately eroded	4.28	28.5%		VIe	139.2	40.4	23	28	55	55	40
792D2	Armstrong clay loam, 9 to 14 percent slopes, moderately eroded	2.25	15.0%		IVe	88	25.5	5	13	51	51	37
S179F	Gara loam, 18 to 25 percent slopes	2.23	14.9%		VIe	0	0	19		56	56	41
822D2	Lamoni clay loam, 9 to 14 percent slopes, moderately eroded	1.54	10.3%		IVe	100.8	29.2	11	15	58	58	42
131C	Pershing silt loam, 5 to 9 percent slopes	0.22	1.5%		IIIe	80	23.2	65	49	72	72	61
Weighted Average						121.8	35.3	35.2	*	*n 64.4	*n 64.4	*n 50.1

**IA has updated the CSR values for each county to CSR2.

*- CSR weighted average cannot be calculated on the current soils data, use prior data version for csr values.

*i Yield data provided by the ISPAID Database version 8.1.1 developed by IA State University.

*n: The aggregation method is "Weighted Average using major components"

*c: Using Capabilities Class Dominant Condition Aggregation Method

Soils data provided by USDA and NRCS.