

# Soils Map

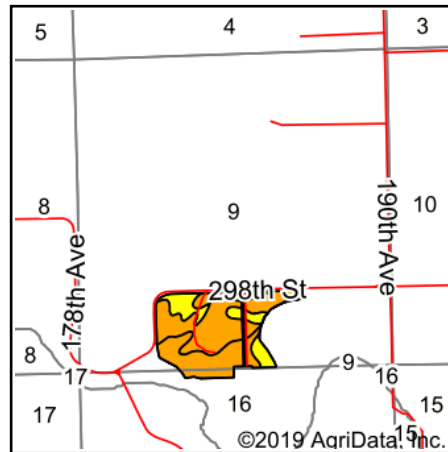

State: **Iowa**  
 County: **Clinton**  
 Location: **9-80N-2E**  
 Township: **Olive**  
 Acres: **57.69**  
 Date: **12/1/2019**

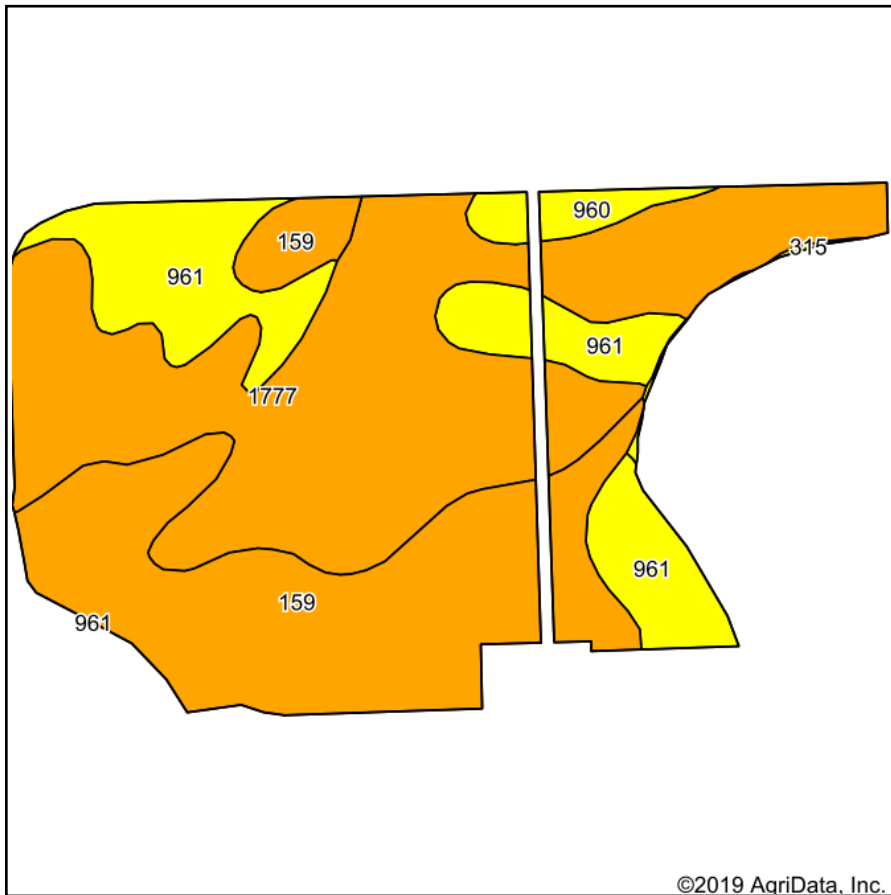

Maps Provided By:

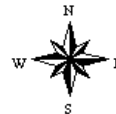

Soils data provided by USDA and NRCS.

©2019 AgriData, Inc.

Area Symbol: IA045, Soil Area Version: 25																	
Code	Soil Description	Acres	Percent of field	CSR2 Legend	Non-Irr Class *c	*i Corn	*i Alfalfa	*i Soybeans	*i Bluegrass	*i Tall Grasses	CSR2**	CSR	*n NCCPI Overall	*n NCCPI Corn	*n NCCPI Small Grains	*n NCCPI Soybeans	*n NCCPI Cotton
1777	Wapsie variant loam, 0 to 2 percent slopes	27.19	47.1%		Ils	80	2.2	23.2	1.4	2.4	41	64	67	67	45	40	0
159	Finchford loamy sand, 0 to 2 percent slopes	18.65	32.3%		IVs	148.8	4.2	43.2	2.7	4.5	43	35	55	55	46	36	9
961	Ambraw silty clay loam, 0 to 2 percent slopes	10.33	17.9%		Ilw	177.6	3.7	51.5	3.2	5.3	65	47	91	91	12	74	0
960	Shaffton loam, 0 to 2 percent slopes	1.38	2.4%		Ilw	80	2.1	23.2	1.4	2.4	57	62	89	89	27	81	0
315	Fluvents-Ambraw complex, 0 to 2 percent slopes	0.14	0.2%		Illw	80	0	23.2	1.4	2.4	59	5	66	66	33	52	0
<b>Weighted Average</b>						<b>119.7</b>	<b>3.1</b>	<b>34.7</b>	<b>2.1</b>	<b>3.6</b>	<b>46.4</b>	<b>51.4</b>	<b>*n 67.9</b>	<b>*n 67.9</b>	<b>*n 39</b>	<b>*n 45.8</b>	<b>*n 2.9</b>

\*\*IA has updated the CSR values for each county to CSR2.

\*i Yield data provided by the ISPAID Database version 8.1.1 developed by IA State University.

\*n: The aggregation method is "Weighted Average using major components"

\*c: Using Capabilities Class Dominant Condition Aggregation Method

Soils data provided by USDA and NRCS.