

Soils Map

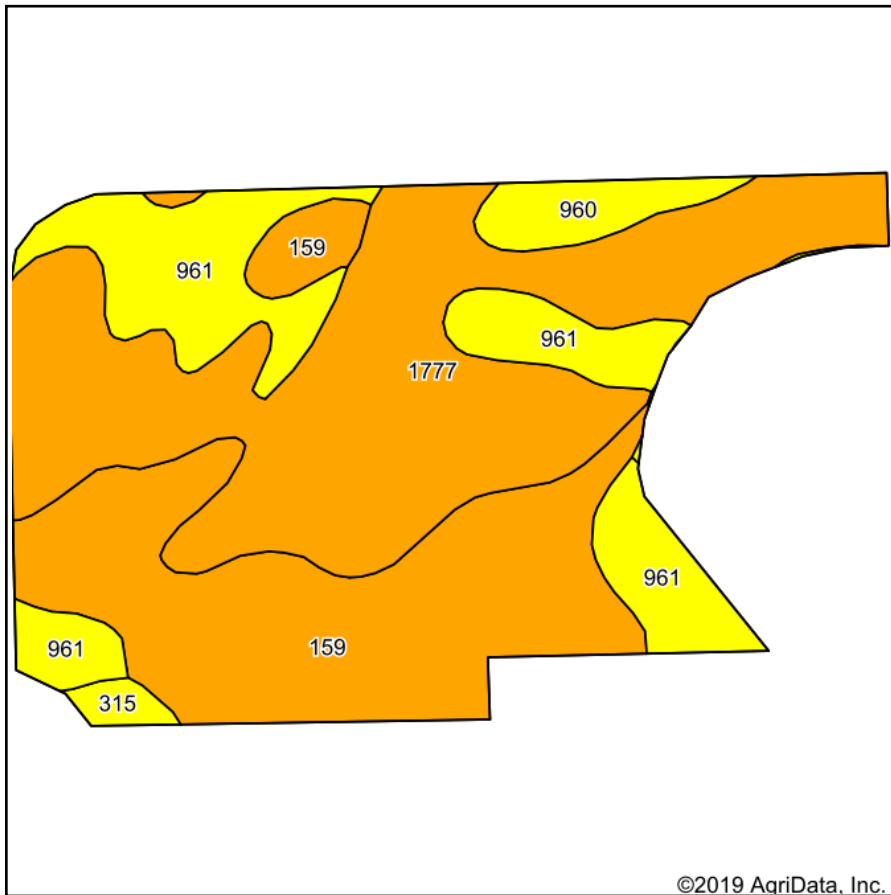

Soils data provided by USDA and NRCS.

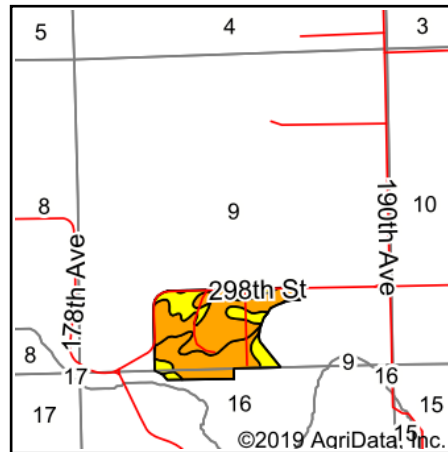

State: **Iowa**
 County: **Clinton**
 Location: **9-80N-2E**
 Township: **Olive**
 Acres: **66.13**
 Date: **12/1/2019**



Maps Provided By:



© AgriData, Inc. 2019

www.AgriDataInc.com

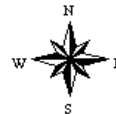

Area Symbol: IA045, Soil Area Version: 25																	
Cod e	Soil Description	Acres	Percent of field	CSR2 Legend	Non-Irr Class *c	*i Corn	*i Alfalfa	*i Soybeans	*i Bluegrass	*i Tall Grasses	CSR2**	CSR	*n NCCPI Overall	*n NCCPI Corn	*n NCCPI Small Grains	*n NCCPI Soybeans	*n NCCPI Cotton
1777	Wapsie variant loam, 0 to 2 percent slopes	29.20	44.2%		Ils	80	2.2	23.2	1.4	2.4	41	64	67	67	45	40	0
159	Finchford loamy sand, 0 to 2 percent slopes	20.83	31.5%		IVs	148.8	4.2	43.2	2.7	4.5	43	35	55	55	46	36	9
961	Ambraw silty clay loam, 0 to 2 percent slopes	13.03	19.7%		Ilw	177.6	3.7	51.5	3.2	5.3	65	47	91	91	12	74	0
960	Shaffton loam, 0 to 2 percent slopes	2.31	3.5%		Ilw	80	2.1	23.2	1.4	2.4	57	62	89	89	27	81	0
315	Fluvents-Ambraw complex, 0 to 2 percent slopes	0.76	1.1%		Illw	80	0	23.2	1.4	2.4	59	5	66	66	33	52	0
Weighted Average						120.9	3.1	35.1	2.2	3.6	47.1	50.8	*n 68.7	*n 68.7	*n 38	*n 47	*n 2.8

**IA has updated the CSR values for each county to CSR2.

*i Yield data provided by the ISPAID Database version 8.1.1 developed by IA State University.

*n: The aggregation method is "Weighted Average using major components"

*c: Using Capabilities Class Dominant Condition Aggregation Method

Soils data provided by USDA and NRCS.