

# Soils Map - Total Acres

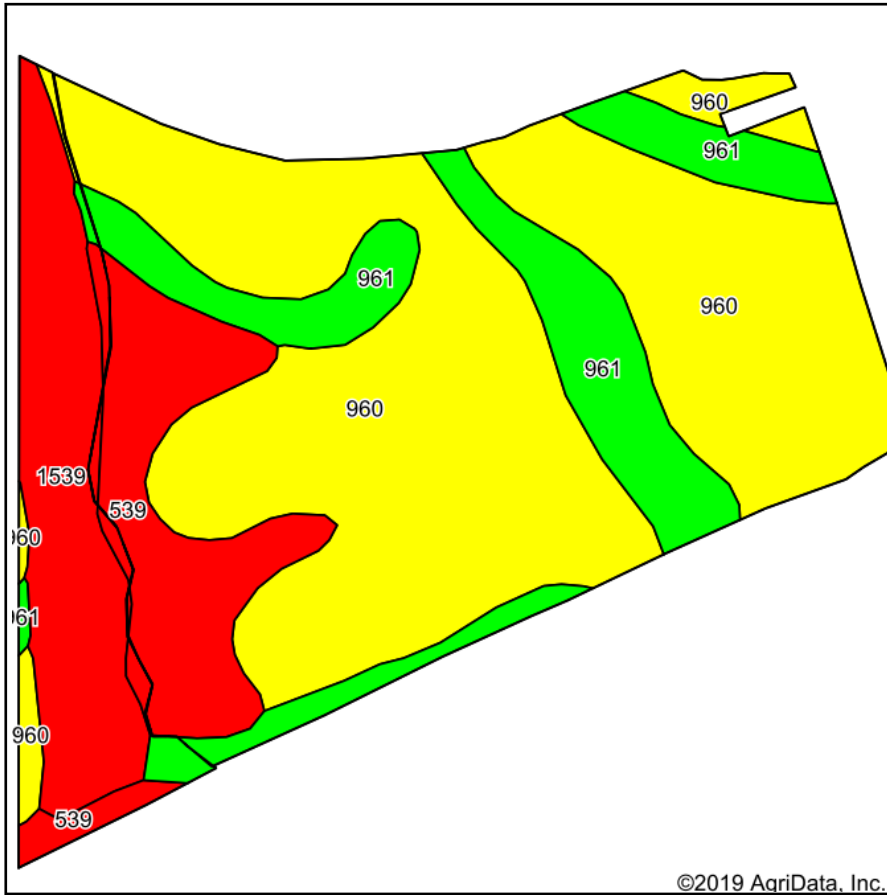

Soils data provided by USDA and NRCS.

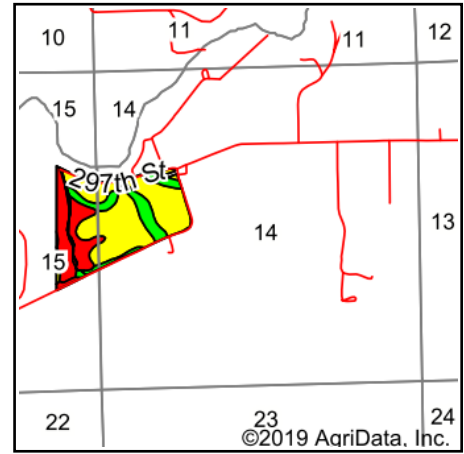

State: **Iowa**  
 County: **Scott**  
 Location: **14-80N-2E**  
 Township: **Allens Grove**  
 Acres: **66**  
 Date: **12/27/2019**

**PC PEOPLES**  
 COMPANY  
 INNOVATIVE. REAL ESTATE. SOLUTIONS.

Maps Provided By:

**surety**  
 CUSTOMIZED ONLINE MAPPING  
 © AgriData, Inc. 2019 www.AgriDataInc.com



Area Symbol: IA163. Soil Area Version: 28

Code	Soil Description	Acres	Percent of field	CSR2 Legend	Non-Irr Class *c	*i Corn	*i Alfalfa	*i Soybeans	*i Bluegrass	*i Tall Grasses	CSR2**	CSR	*n NCCPI Overall	*n NCCPI Corn	*n NCCPI Small Grains	*n NCCPI Soybeans
960	Shaffton loam, 0 to 2 percent slopes	38.48	58.3%		Ilw	80	2.1	23.2	1.4	2.4	58	78	86	86	27	79
961	Ambraw clay loam, 0 to 2 percent slopes	11.02	16.7%		Ilw	196.8	4.1	57.1	3.5	5.9	73	47	91	91	13	76
1539	Ambraw-Perks-Lawson complex, frequently flooded, 0 to 2 percent slopes	8.31	12.6%		Vw	120	2.5	34.8	2.2	3.6	5	25	32	32	10	21
539	Perks sandy loam, 0 to 3 percent slopes	8.19	12.4%		Ills	88	2.5	25.5	1.6	2.6	8	20	42	42	32	22
<b>Weighted Average</b>						<b>105.5</b>	<b>2.5</b>	<b>30.6</b>	<b>1.9</b>	<b>3.2</b>	<b>47.6</b>	<b>59</b>	<b>*n 74.6</b>	<b>*n 74.6</b>	<b>*n 23.1</b>	<b>*n 64.1</b>

\*\*IA has updated the CSR values for each county to CSR2.

\*i Yield data provided by the ISPAID Database version 8.1.1 developed by IA State University.

\*n: The aggregation method is "Weighted Average using major components"

\*c: Using Capabilities Class Dominant Condition Aggregation Method

Soils data provided by USDA and NRCS.