

Total Soils Map

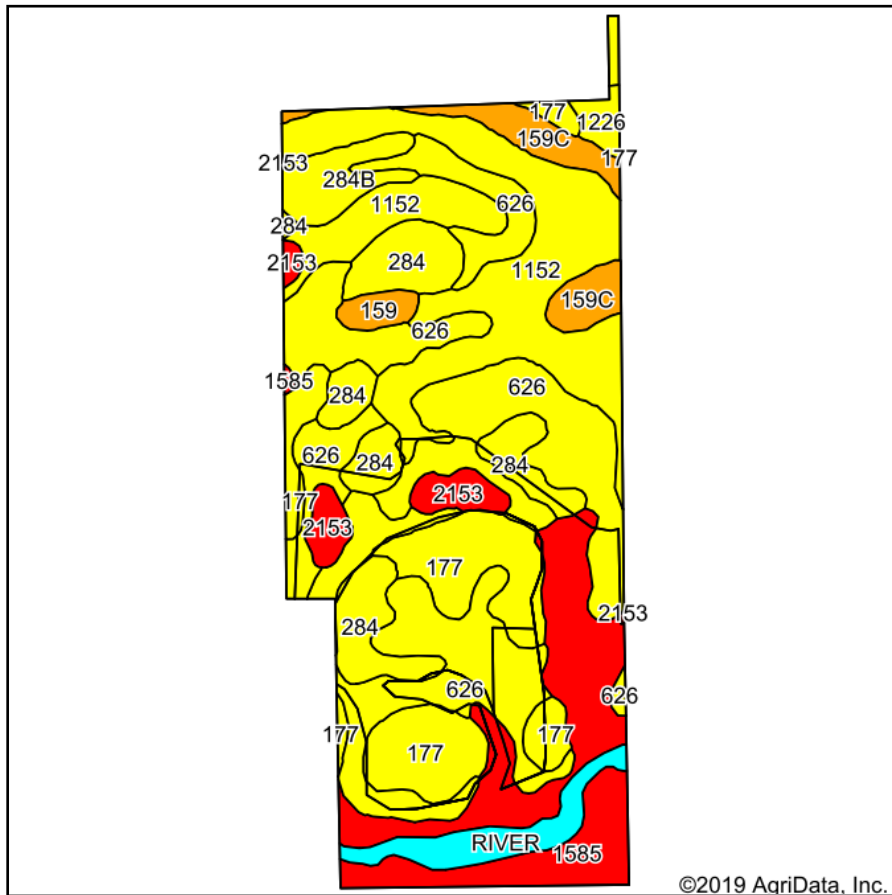

Soils data provided by USDA and NRCS.

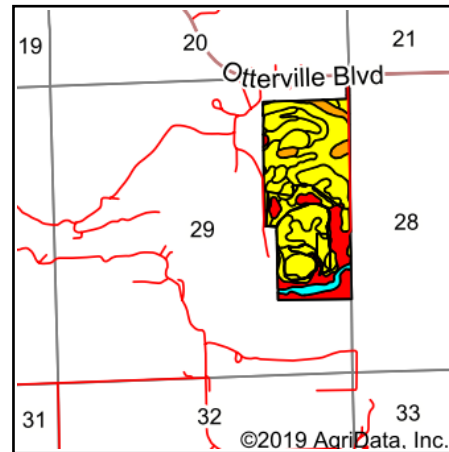

State: **Iowa**
 County: **Buchanan**
 Location: **29-89N-9W**
 Township: **Washington**
 Acres: **118.29**
 Date: **5/28/2019**

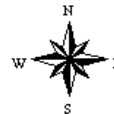

Area Symbol: IA019, Soil Area Version: 24

Code	Soil Description	Acres	Percent of field	CSR2 Legend	Non-Irr Class *c	CSR2**	CSR
626	Hayfield loam, 0 to 2 percent slopes, rarely flooded	33.96	28.7%		IIs	53	67
1152	Marshan clay loam, 0 to 2 percent slopes, rarely flooded	24.57	20.8%		IIw	54	68
1585	Spillville-Coland complex, channeled, 0 to 2 percent slopes	16.72	14.1%		Vw	25	5
177	Saude loam, 0 to 2 percent slopes	14.48	12.2%		IIs	60	63
284	Flagler sandy loam, 0 to 2 percent slopes	11.50	9.7%		IIIs	55	50
159C	Finchford loamy sand, 2 to 9 percent slopes	4.54	3.8%		IVs	33	5
RIVER	Water, rivers and streams	3.83	3.2%			0	
284B	Flagler sandy loam, 2 to 5 percent slopes	3.28	2.8%		IIIe	51	45
2153	Shandep clay loam, 0 to 2 percent slopes, ponded, occasionally flooded	3.20	2.7%		Vw	21	
159	Finchford loamy sand, 0 to 2 percent slopes	1.19	1.0%		IVs	43	30
1226	Lawler loam, 0 to 2 percent slopes, rarely flooded	1.02	0.9%		IIs	59	72
Weighted Average						46.8	*-

**IA has updated the CSR values for each county to CSR2.

*- CSR weighted average cannot be calculated on the current soils data, use prior data version for csr values.

Soils data provided by USDA and NRCS.

Maps Provided By:



© AgriData, Inc. 2019

www.AgriDataInc.com

*c: Using Capabilities Class Dominant Condition Aggregation Method