

# Soils Map

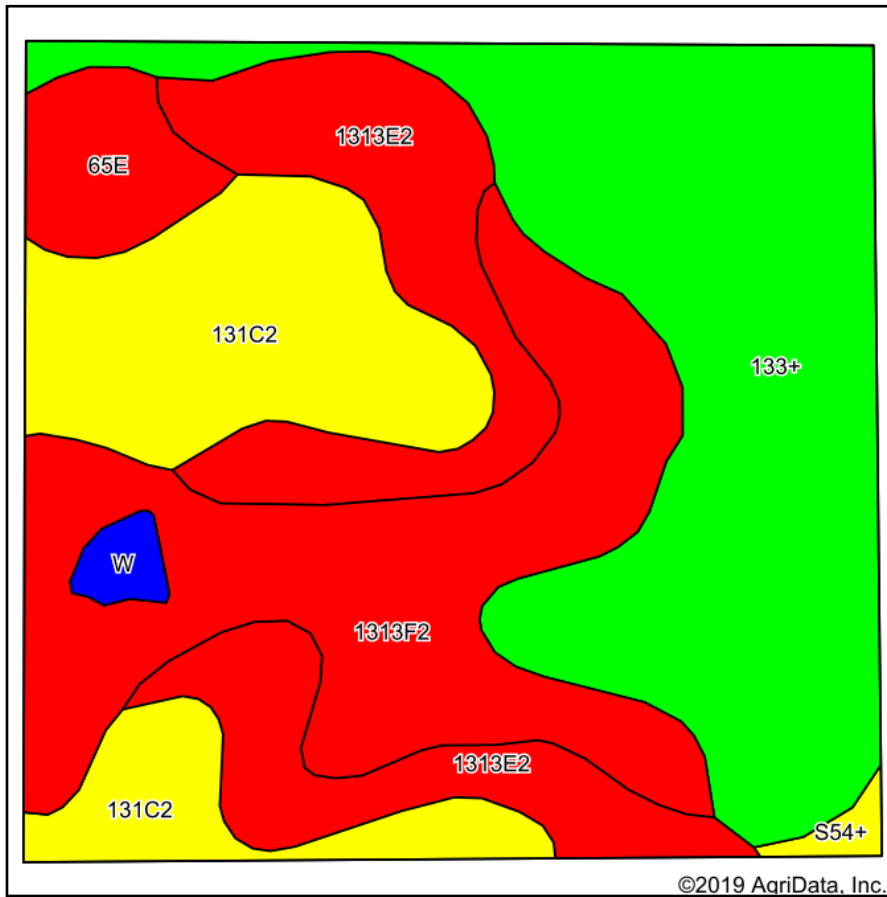

Soils data provided by USDA and NRCS.

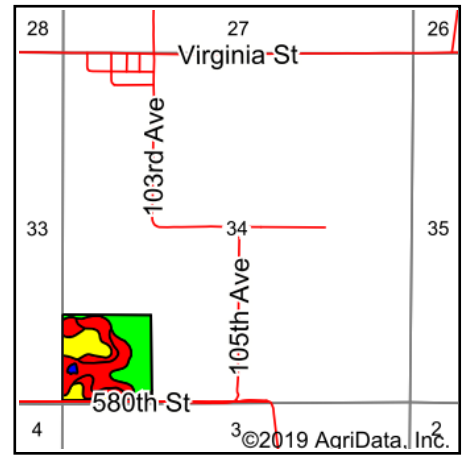

State: **Iowa**  
 County: **Marion**  
 Location: **34-74N-20W**  
 Township: **Washington**  
 Acres: **40**  
 Date: **2/3/2020**

**PC PEOPLES**  
 COMPANY  
 INNOVATIVE. REAL ESTATE. SOLUTIONS.

Maps Provided By:  
**surety**  
 CUSTOMIZED ONLINE MAPPING  
 © AgriData, Inc. 2019 www.AgriDataInc.com



Area Symbol: IA125. Soil Area Version: 28												
Code	Soil Description	Acres	Percent of field	CSR2 Legend	Non-Irr Class *c	*i Corn	*i Soybeans	CSR2**	CSR	*n NCCPI Overall	*n NCCPI Corn	*n NCCPI Soybeans
133+	Colo silt loam, deep loess, 0 to 2 percent slopes, overwash, occasionally flooded	13.55	33.9%		IIw	204.8	59.4	78	80	95	95	82
1313F2	Munterville silt loam, 18 to 25 percent slopes, moderately eroded	9.43	23.6%		VIIe	80	23.2	5	5	33	33	26
131C2	Pershing silt loam, 5 to 9 percent slopes, moderately eroded	7.51	18.8%		IIIe	80	23.2	62	49	60	60	49
1313E2	Munterville silt loam, 14 to 18 percent slopes, moderately eroded	7.26	18.2%		VIe	80	23.2	22	5	45	45	36
65E	Lindley loam, 14 to 18 percent slopes	1.62	4.0%		VIe	139.2	40.4	24	28	72	72	60
W	Water	0.38	1.0%			0	0	0	0		0	0
S54+	Zook silt loam, heavy till, 0 to 2 percent slopes, occasionally flooded, overwash	0.25	0.6%		IIw	0	0	68		82	82	69
<b>Weighted Average</b>						<b>123.4</b>	<b>35.8</b>	<b>44.6</b>	<b>*</b>	<b>*n 62.8</b>	<b>*n 62.8</b>	<b>*n 52.5</b>

\*\*IA has updated the CSR values for each county to CSR2.

\*. CSR weighted average cannot be calculated on the current soils data, use prior data version for csr values.

\*i Yield data provided by the ISPAID Database version 8.1.1 developed by IA State University.

\*n: The aggregation method is "Weighted Average using major components"

\*c: Using Capabilities Class Dominant Condition Aggregation Method

Soils data provided by USDA and NRCS.