

# Tillable Soils Map

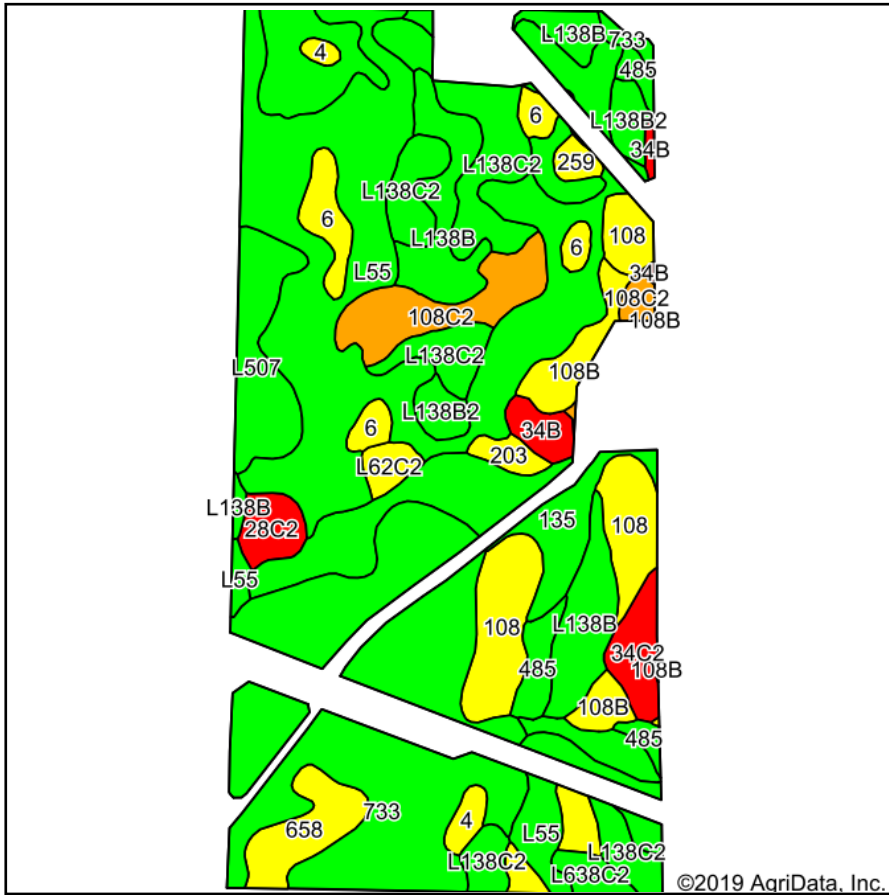

Soils data provided by USDA and NRCS.

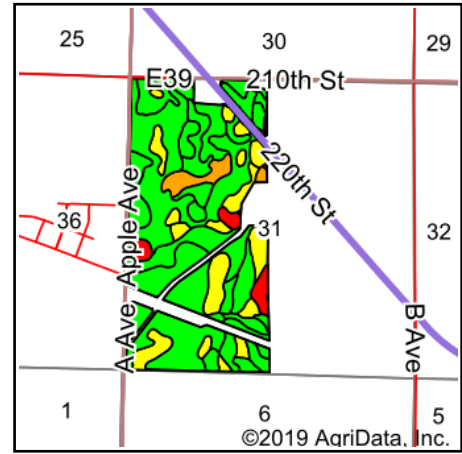

State: **Iowa**  
 County: **Greene**  
 Location: **31-84N-32W**  
 Township: **Kendrick**  
 Acres: **266.38**  
 Date: **1/28/2020**



Area Symbol: IA073. Soil Area Version: 25		Acres	Percent of field	CSR2 Legend	Non-Irr Class *c	CSR2**	CSR	*n NCCPI Overall
L55	Nicollet loam, 1 to 3 percent slopes	63.50	23.8%		Ie	91		83
733	Calco silty clay loam, 0 to 2 percent slopes, occasionally flooded	50.80	19.1%		IIw	78	76	82
L138C2	Clarion loam, Bemis moraine, 6 to 10 percent slopes, moderately eroded	21.48	8.1%		IIIe	83		60
L507	Canisteo clay loam, Bemis moraine, 0 to 2 percent slopes	19.00	7.1%		IIw	87		79
L138B	Clarion loam, Bemis moraine, 2 to 6 percent slopes	17.74	6.7%		Ile	88		79
135	Coland clay loam, 0 to 2 percent slopes, occasionally flooded	16.66	6.3%		IIw	76	81	86
108	Wadena loam, 0 to 2 percent slopes	16.11	6.0%		IIs	56		65
108C2	Wadena loam, 6 to 12 percent slopes, moderately eroded	9.64	3.6%		IIIe	44	25	55
6	Okoboji silty clay loam, 0 to 1 percent slopes	6.81	2.6%		IIIw	59	58	80
108B	Wadena loam, 2 to 6 percent slopes	6.10	2.3%		Ile	52	51	65
658	Mayer loam, 0 to 2 percent slopes	5.95	2.2%		IIw	54		69
L62C2	Storden loam, Bemis moraine, 6 to 10 percent slopes, moderately eroded	4.65	1.7%		IIIe	64		63
485	Spillville loam, 0 to 2 percent slopes, occasionally flooded	4.53	1.7%		IIw	88	91	88
L138B2	Clarion loam, Bemis moraine, 2 to 6 percent slopes, moderately eroded	4.16	1.6%		Ile	85		63
34C2	Estherville sandy loam, 5 to 9 percent slopes, moderately eroded	4.07	1.5%		IVe	13	8	38
28C2	Dickman fine sandy loam, 5 to 9 percent slopes, moderately eroded	3.19	1.2%		IVe	14	22	51
34B	Estherville sandy loam, 2 to 6 percent slopes	2.96	1.1%		IIIIs	27	20	46
L107	Webster clay loam, Bemis moraine, 0 to 2 percent slopes	2.15	0.8%		IIw	88		80
4	Knoke silty clay loam, 0 to 1 percent slopes	2.07	0.8%		IIIw	56	58	75
L638C2	Clarion-Storden complex, Bemis moraine, 6 to 10 percent slopes, moderately eroded	1.90	0.7%		IIIe	75		61
203	Cylinder loam, 0 to 2 percent slopes	1.64	0.6%		IIs	58		75
259	Biscay clay loam, 0 to 2 percent slopes	1.27	0.5%		IIw	52	78	70
<b>Weighted Average</b>						<b>75.9</b>	<b>*-</b>	<b>*n 75.3</b>

\*\*IA has updated the CSR values for each county to CSR2.

\*- CSR weighted average cannot be calculated on the current soils data, use prior data version for csr values.

\*n: The aggregation method is "Weighted Average using major components"

\*c: Using Capabilities Class Dominant Condition Aggregation Method

Soils data provided by USDA and NRCS.