

# Tillable Soils Map

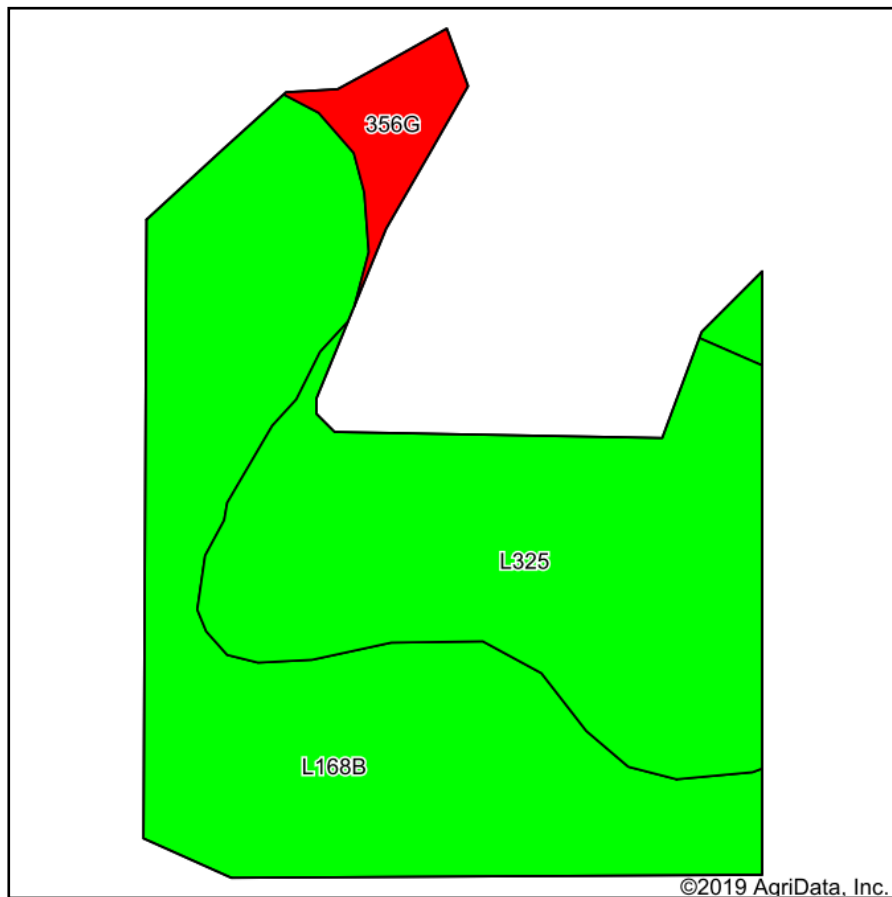

Soils data provided by USDA and NRCS.

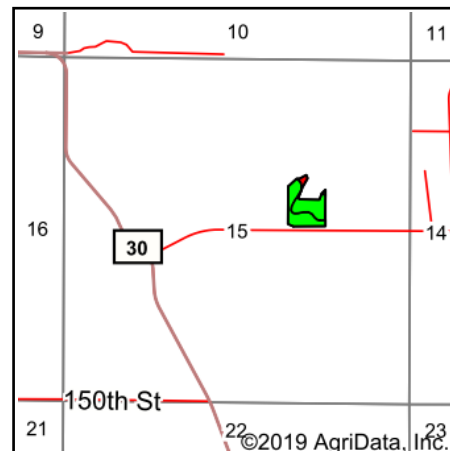

State: **Iowa**  
 County: **Dallas**  
 Location: **15-81N-26W**  
 Township: **Des Moines**  
 Acres: **7**  
 Date: **3/24/2020**



Maps Provided By:



Area Symbol: IA049. Soil Area Version: 25										
Code	Soil Description	Acres	Percent of field	CSR2 Legend	Non-Irr Class *c	*i Corn	*i Soybeans	CSR2**	CSR	*n NCCPI Overall
L168B	Hayden loam, Bemis moraine, 2 to 6 percent slopes	3.75	53.6%		Ile	0	0	76		85
L325	Le Sueur loam, Bemis moraine, 1 to 3 percent slopes	2.94	42.0%		Ie	0	0	78		93
356G	Hayden-Storden loams, 25 to 50 percent slopes	0.31	4.4%		VIIe	88	25.5	5	5	18
<b>Weighted Average</b>						<b>3.9</b>	<b>1.1</b>	<b>73.7</b>	<b>*-</b>	<b>*n 85.4</b>

\*\*IA has updated the CSR values for each county to CSR2.

\*- CSR weighted average cannot be calculated on the current soils data, use prior data version for csr values.

\*i Yield data provided by the ISPAID Database version 8.1.1 developed by IA State University.

\*n: The aggregation method is "Weighted Average using major components"

\*c: Using Capabilities Class Dominant Condition Aggregation Method

Soils data provided by USDA and NRCS.