

# Tillable Soils Map

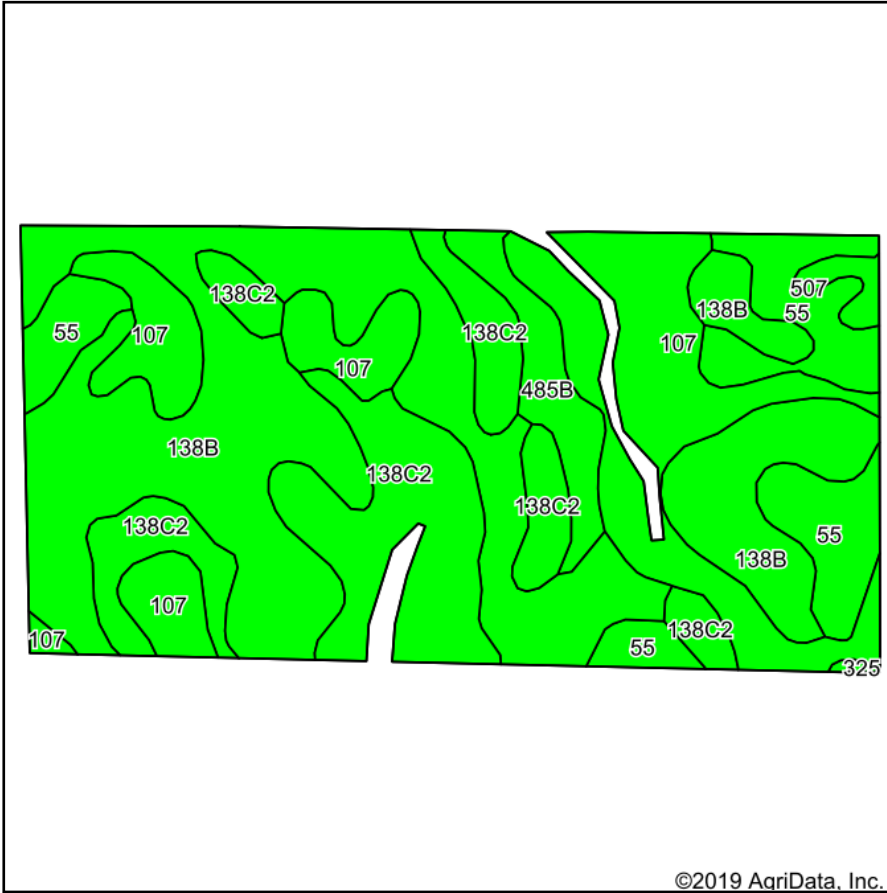

Soils data provided by USDA and NRCS.

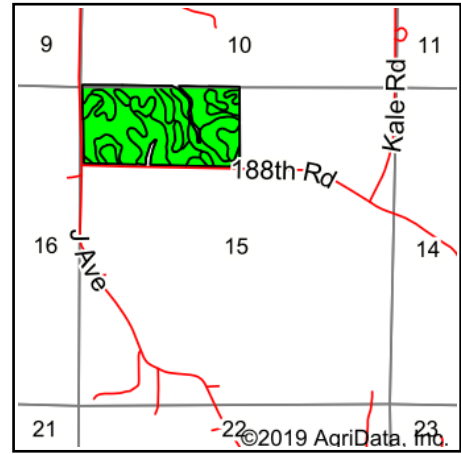

State: **Iowa**  
 County: **Boone**  
 Location: **15-84N-27W**  
 Township: **Yell**  
 Acres: **76.05**  
 Date: **2/11/2020**



Maps Provided By:



© AgriData, Inc. 2019

www.AgriDataInc.com



Area Symbol: IA015. Soil Area Version: 27										
Code	Soil Description	Acres	Percent of field	CSR2 Legend	Non-Irr Class *c	*i Corn	*i Soybeans	CSR2**	CSR	*n NCCPI Overall
138B	Clarion loam, 2 to 6 percent slopes	31.99	42.1%		Ile	225.6	65.4	89	84	83
107	Webster clay loam, 0 to 2 percent slopes	16.55	21.8%		IIw	224	65	86	87	80
138C2	Clarion loam, 6 to 10 percent slopes, moderately eroded	14.99	19.7%		IIIe	204.8	59.4	83	66	65
55	Nicollet clay loam, 1 to 3 percent slopes	8.78	11.5%		Iw	233.6	67.7	89	92	82
485B	Spillville loam, 2 to 5 percent slopes	3.03	4.0%		Ile	200	58	88	87	89
507	Canisteo clay loam, 0 to 2 percent slopes	0.71	0.9%		IIw	224	65	84	82	79
<b>Weighted Average</b>						<b>221</b>	<b>64.1</b>	<b>87.1</b>	<b>82.1</b>	<b>*n 78.9</b>

\*\*IA has updated the CSR values for each county to CSR2.

\*i Yield data provided by the ISPAID Database version 8.1.1 developed by IA State University.

\*n: The aggregation method is "Weighted Average using major components"

\*c: Using Capabilities Class Dominant Condition Aggregation Method

Soils data provided by USDA and NRCS.