

**RIDGE SURVEYING & CONSULTING, PLLC.**

311 South Church St., Suite H  
Jonesboro, AR 72401 870-203-9940  
www.ridgesurveying.net

**BOUNDARY SURVEY**  
CLIENT: KING  
PART OF THE SW 1/4, NW 1/4  
SECTION 27, TOWNSHIP 19-N, RANGE 5-W  
SHARP COUNTY, ARKANSAS

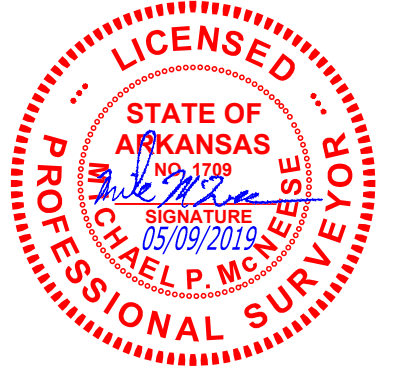

**DRAWING INFO**

DRAWN BY: MPM	SCALE: 1" = 100'
DATE: 05 / 09 / 2019	JOB NO: 19173

**REVISIONS**

500-19N-05W-0-27-430-67-1709

**LEGEND:**

- FOUND MONUMENT (AS NOTED)
- BOUNDARY LINE
- x- FENCE LINE
- STORM DRAIN MANHOLE
- UTILITY POLE
- ↗ GUY WIRE

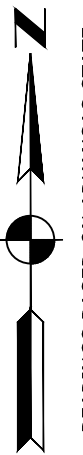

BEARINGS BASED ON ARKANSAS STATE PLANE GRID NORTH ZONE (0301)

**SURVEYOR'S NOTES:**

1. SURVEYOR HAS MADE NO INVESTIGATION OR INDEPENDENT SEARCH FOR EASEMENTS OF RECORD OR ANY OTHER FACTS WHICH AN ACCURATE TITLE SEARCH MAY DISCLOSE.
2. BASIS OF BEARINGS: ARKANSAS STATE PLANE GRID NORTH (0301).
3. THE FOLLOWING DOCUMENTS WERE USED TO COMPLETE THIS SURVEY:
  - ARDOT RIGHT-OF-WAY PLANS FOR JOB# 5897.
  - SURVEY BY ROBERT GREEN, P.S. 1180, S.L.S. DOC# 201705092667, DATED 10/20/1997.
  - SURVEY BY JIM SITZ, P.S. 1497, S.L.S. DOC# 515330, DATED 12/01/2005.
  - CORPORATION WARRANTY DEED, REX HARDY INCORPORATED TO KING, RECORDED IN BOOK 2015-05192, PUBLIC RECORDS OF SHARP COUNTY IN ASH FLAT, ARKANSAS, DATED 4/17/2015.
4. THE SUBJECT PROPERTY LIES OUTSIDE THE 100 YEAR SPECIAL FLOOD HAZARD ZONE, AS SHOWN ON FEMA FLOOD INSURANCE RATE MAPS: PANEL NO. 05135C0095, DATED SEPTEMBER 16, 2011.
5. FIELD WORK WAS COMPLETED ON MAY 08, 2019.

**LEGAL DESCRIPTION (AS-SURVEYED):**

A PART OF THE SOUTHWEST QUARTER OF THE NORTHWEST QUARTER OF SECTION 27, TOWNSHIP 19 NORTH, RANGE 5 WEST OF THE FIFTH PRINCIPAL MERIDIAN, SHARP COUNTY, ARKANSAS, BEING MORE PARTICULARLY DESCRIBED AS FOLLOWS:

COMMENCING AT THE SOUTHWEST OF SECTION 27 AFORESAID; THENCE NORTH 16°44'00" EAST, 2751.20 FEET, TO A FOUND REBAR IN THE FENCE FOR THE POINT OF BEGINNING; THENCE NORTH 45°12'24" WEST, LEAVING SAID FENCE, 400.24 FEET TO THE SOUTHERLY RIGHT-OF-WAY LINE OF U.S. HIGHWAY 62/412; THENCE ALONG SAID SOUTHERLY RIGHT-OF-WAY LINE, NORTH 45°12'33" EAST, 300.00 FEET; THENCE SOUTH 45°12'26" EAST, LEAVING SAID SOUTHERLY RIGHT-OF-WAY LINE, 399.78 FEET TO A FOUND REBAR IN A FENCE; THENCE SOUTH 45°07'14" WEST, ALONG SAID FENCE, 300.00 FEET TO THE POINT OF BEGINNING PROPER, CONTAINING 2.75 ACRES (120,001 SQ. FT.), MORE OR LESS, SUBJECT TO ALL RIGHTS-OF-WAY AND EASEMENTS OF RECORD.

**SURVEYOR'S CERTIFICATION:**

I, MICHAEL P. MCNEESE, CERTIFY THAT THE SURVEY SHOWN HEREON WAS MADE IN ACCORDANCE WITH THE REQUIREMENTS OF "ARKANSAS STANDARDS OF PRACTICE FOR PROPERTY BOUNDARY SURVEYS AND PLATS"; AND THAT THE ABOVE DESCRIBED TRACT WAS SURVEYED UNDER MY DIRECT SUPERVISION.

