

Soils Map

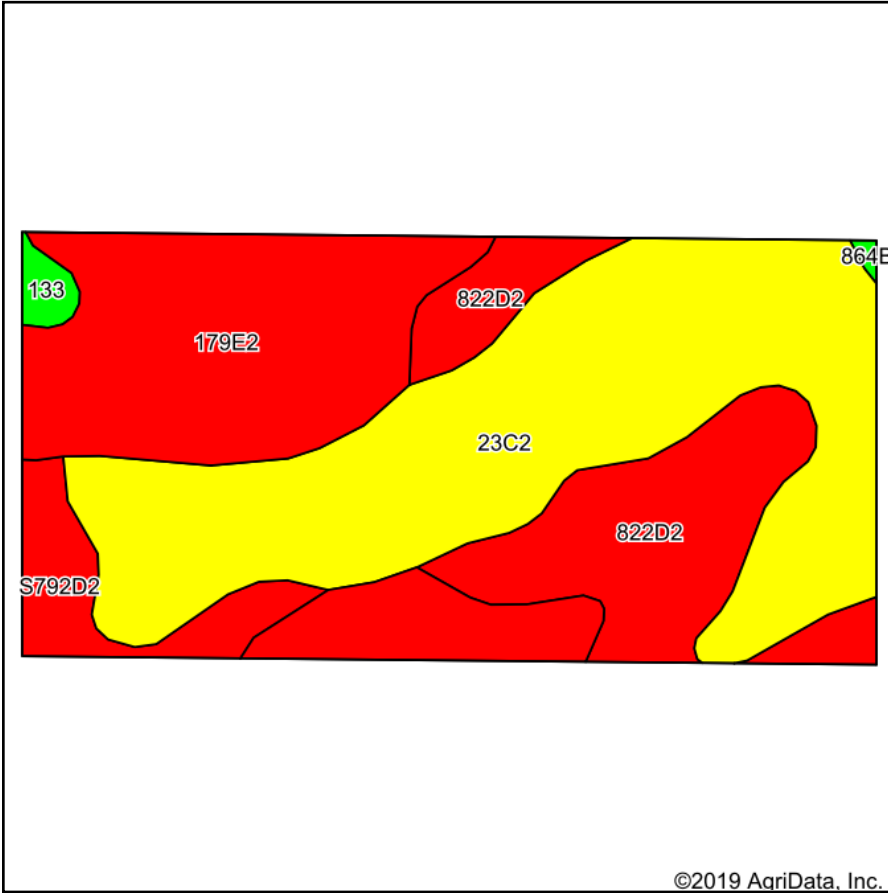

Soils data provided by USDA and NRCS.

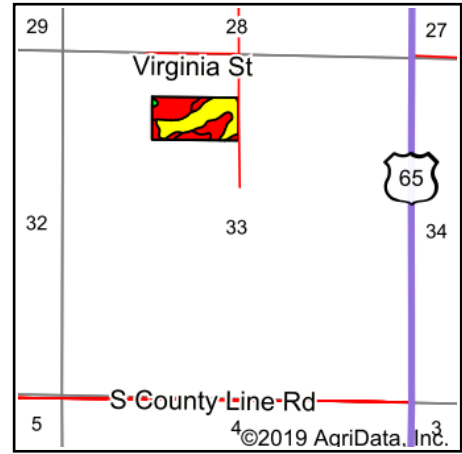

State: **Iowa**
 County: **Warren**
 Location: **28-74N-23W**
 Township: **Liberty**
 Acres: **20**
 Date: **6/8/2020**



Maps Provided By:



Area Symbol: IA181, Soil Area Version: 24										
Code	Soil Description	Acres	Percent of field	CSR2 Legend	Non-Irr Class *c	CSR2**	CSR	*n NCCPI Overall	*n NCCPI Soybeans	
23C2	Arispe silty clay loam, 5 to 9 percent slopes, moderately eroded	9.02	45.1%	Yellow	IIIe	62	62	82	74	
179E2	Gara loam, 14 to 18 percent slopes, moderately eroded	5.86	29.3%	Red	VIe	24	33	56	41	
822D2	Lamoni silty clay loam, 9 to 14 percent slopes, eroded	3.79	19.0%	Red	IVe	10	15	53	40	
S792D2	Armstrong loam, 9 to 14 percent slopes, moderately eroded	1.12	5.6%	Red	IVe	9		57	42	
133	Colo silty clay loam, deep loess, 0 to 2 percent slopes, occasionally flooded	0.21	1.0%	Green	IIw	78	80	94	77	
Weighted Average						38.2	*-	*n 67.6	*n 56.1	

**IA has updated the CSR values for each county to CSR2.

*- CSR weighted average cannot be calculated on the current soils data, use prior data version for csr values.

*n: The aggregation method is "Weighted Average using major components"

*c: Using Capabilities Class Dominant Condition Aggregation Method

Soils data provided by USDA and NRCS.