

# WEBB KELLEY W & ANN

## WETHERTON RD

Logged In:  
3 minutes  
Total Time:  
3 minutes

Basic Information	
Parcel Number:	001-00329-000
County Name:	Sharp County
Property Address:	WEBB KELLEY W & ANN WETHERTON RD <a href="#">Map This Address</a>
Mailing Address:	WEBB KELLEY W & ANN 2307 RACE ST JONESBORO AR 72401
Total Acres:	75.00
Timber Acres:	74.00
Sec-Twp-Rng:	26-19-03
Lot/Block:	/
Subdivision:	
Legal Description:	PT E/2 NW/4
School District:	45 SLOAN HENDRIX
Homestead Parcel?:	No
Tax Status:	Taxable
Over 65?:	No
Parcel Boundary	

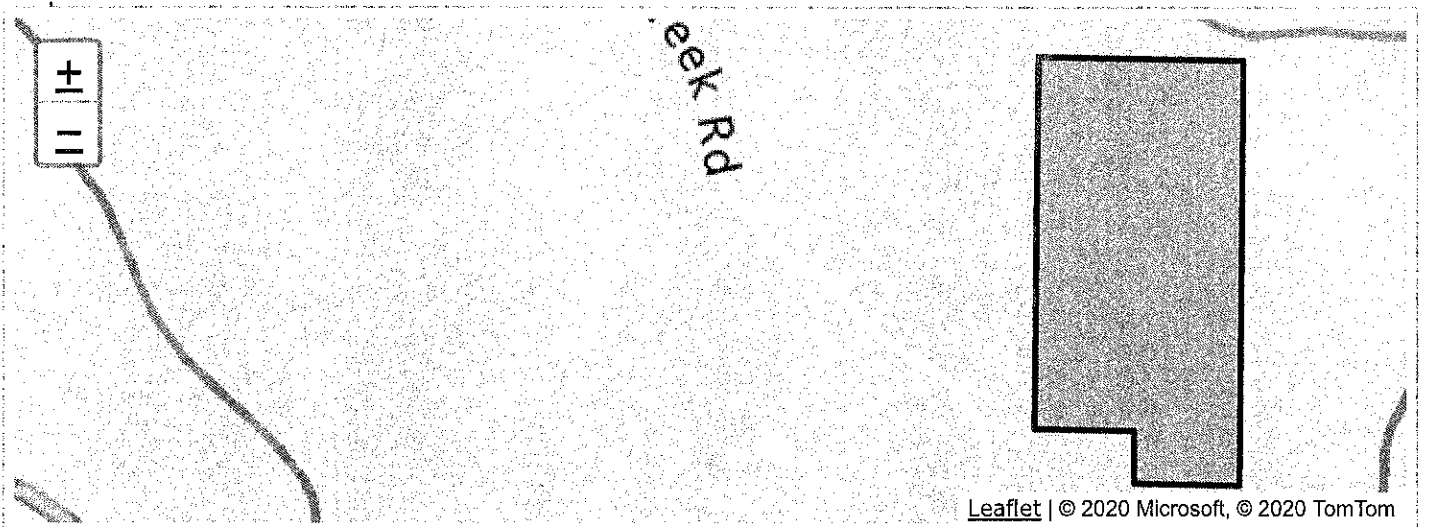

Land Information

Land Type	Quantity	Front Width	Rear Width	Depth 1	Depth 2	Quarter
T19R03	1.00 acres [43,560 sqft]					NW
TIMBER	12.59 acres [548,420 sqft]					NW
TIMBER	61.41 acres [2,675,019 sqft]					NW

Valuation Information

[view prior year information](#)

Entry	Appraised	Assessed
Land:	14,050	2,810
Improvements:	11,150	2,230
Total Value:	25,200	5,040
Taxable Value:		5,040
Millage:		0.04278
Timber:		14.8
Estimated Taxes ⓘ:		\$230.41
Assessment Year:		2015

Tax Information

Year	Book	Tax Owed	Tax Paid	Balance
<u>2019</u>	Current	\$230.41	\$0.00	\$230.41
<u>2018</u>	Current	\$230.41	-\$230.41	\$0.00
<u>2017</u>	Current	\$230.41	-\$230.41	\$0.00
<u>2016</u>	Current	\$230.41	-\$230.41	\$0.00
<u>2015</u>	Current	\$230.41	-\$230.41	\$0.00
<u>2014</u>	Current	\$204.32	-\$204.32	\$0.00
<u>2013</u>	Current	\$194.90	-\$194.90	\$0.00
<u>2012</u>	Delinquent	\$103.93	-\$103.93	\$0.00
<u>2011</u>	Delinquent	\$104.08	-\$104.08	\$0.00
<u>2010</u>	Current	\$97.24	-\$97.24	\$0.00
<u>2009</u>	Current	\$78.85	-\$78.85	\$0.00
<u>2008</u>	Current	\$78.85	-\$78.85	\$0.00
<u>2007</u>	Current	\$78.85	-\$78.85	\$0.00

#### Receipts

Receipt #	Book	Tax Year	ReceiptDate	Cash Amt	Check Amt	Credit Amt	Total
<u>10345</u>	Current	2018	8/16/2019	\$0.00	\$0.00	\$307.70	\$307.70
<u>17724</u>	Current	2017	10/22/2018	\$0.00	\$307.70	\$0.00	\$307.70
<u>18055</u>	Current	2016	10/19/2017	\$0.00	\$0.00	\$307.70	\$307.70
<u>16218</u>	Current	2015	10/20/2016	\$0.00	\$0.00	\$307.70	\$307.70
<u>18321</u>	Current	2014	10/19/2015	\$0.00	\$286.94	\$0.00	\$286.94
<u>6792</u>	Current	2013	4/4/2014	\$0.00	\$277.52	\$0.00	\$277.52
<u>235189</u>	Delinquent	2012	3/5/2014	\$0.00	\$0.00	\$215.56	\$215.56
<u>230307</u>	Delinquent	2011	11/26/2012	\$0.00	\$212.25	\$0.00	\$212.25
<u>5261</u>	Current	2010	3/21/2011	\$0.00	\$173.59	\$0.00	\$173.59
<u>5613</u>	Current	2009	3/18/2010	\$0.00	\$145.31	\$0.00	\$145.31
<u>9160</u>	Current	2008	5/26/2009	\$0.00	\$145.31	\$0.00	\$145.31
<u>12494</u>	Current	2007	9/12/2008	\$0.00	\$145.31	\$0.00	\$145.31

#### Sales History

Filed	Sold	Price	Grantor	Grantee	Book	Page	Deed Type
10/26/2015	9/22/2015	0	WEBB	WEBB	2015	16245	G D(GIFT OR GRANT DEED)
5/7/2014	5/7/2014	130,000	DURHAM	WEBB	2014	6898	WD/WOL(Warranty Deed with other)
4/4/2014	4/3/2014	100,000	MAZA	DURHAM	2014	5141	WD/WOL(Warranty Deed with other)
4/4/2014	1/6/2014	0	COURT	MAZA	2014	5136	ORDER(COURT ORDER)
4/4/2014	12/10/2013	0	B L MAZA		2014	5139	DC(Death Certificate)
11/19/2001	11/19/2001	80,000	PRATT	MAZA	2001	22194	WD/WOL(Warranty Deed with other)
9/14/2001	9/14/2001	0	PRATT	PRATT	2001	19163	QC/WOL(QUIT CLAIM WITH OTHER)
11/9/1995	11/9/1995	35,000		PRATT	320	703	WD/WOL(Warranty Deed with other)
4/11/1994	4/11/1994	0			303	509	WD(Warranty Deed)
9/22/1993	9/22/1993	0			297	529	QCD(Quit Claim Deed)
2/28/1991	2/28/1991	0			270	183	WD/WOL(Warranty Deed with other)
		0			59	100	

#### Improvement Information

#### Residential Improvements

#### Residential Improvement #1

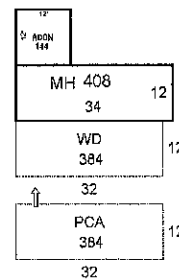
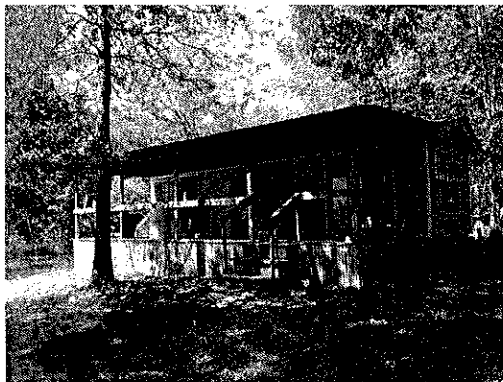

Drawn by: Jper SV/Whitman

Living Area 1st Floor	408	Basement Unfinished	0
Living Area 2nd Floor	0	Basement Finished w/Partitions	0
		Basement Finished w/o Partitions	0
<b>Living Area Total SF</b>	<b>408</b>	<b>Basement Total SF</b>	<b>0</b>

Occupancy Type:	Mobile Home
Grade:	D5
Story Height:	1 Story
Year Built:	Year Built Not Available
Effective Age:	12
Construction Type:	
Roof Type:	Unknown

Heat / AC:	None																						
Fireplace:	0 0																						
Bathrooms:	0 full 0 half																						
Foundation Type:	Unkown																						
Floor Type:	Unkown																						
Floor Covering:																							
Additive Items:	<table border="1"> <thead> <tr> <th>Additive Item</th> <th>Quantity</th> <th>Size</th> <th>Description</th> </tr> </thead> <tbody> <tr> <td>WD</td> <td>384</td> <td></td> <td>WOOD DECKS</td> </tr> <tr> <td>PCA</td> <td>384</td> <td></td> <td>PATIO COVER, ALUM</td> </tr> </tbody> </table>	Additive Item	Quantity	Size	Description	WD	384		WOOD DECKS	PCA	384		PATIO COVER, ALUM										
	Additive Item	Quantity	Size	Description																			
	WD	384		WOOD DECKS																			
PCA	384		PATIO COVER, ALUM																				
Outbuildings / Yard Improvements:	<table border="1"> <thead> <tr> <th>OB/VI Item</th> <th>Quantity</th> <th>Size</th> <th>Description</th> </tr> </thead> <tbody> <tr> <td>MH ADDN</td> <td>192</td> <td>16 x 12</td> <td></td> </tr> <tr> <td>MT OB</td> <td>144</td> <td>12 x 12</td> <td></td> </tr> <tr> <td>PCA NCV</td> <td>120</td> <td>12 x 10</td> <td></td> </tr> <tr> <td>R OVR NCV</td> <td>1</td> <td></td> <td></td> </tr> </tbody> </table>	OB/VI Item	Quantity	Size	Description	MH ADDN	192	16 x 12		MT OB	144	12 x 12		PCA NCV	120	12 x 10		R OVR NCV	1				
	OB/VI Item	Quantity	Size	Description																			
	MH ADDN	192	16 x 12																				
	MT OB	144	12 x 12																				
	PCA NCV	120	12 x 10																				
R OVR NCV	1																						

# WEBB KELLEY W & ANN

BEAR BLUFF TRL

Logged In:  
1 minute  
Total Time:  
1 minute

Basic Information	
Parcel Number:	001-00326-000
County Name:	Sharp County
Property Address:	WEBB KELLEY W & ANN BEAR BLUFF TRL <a href="#">Map This Address</a>
Mailing Address:	WEBB KELLEY W & ANN 2307 RACE ST JONESBORO AR 72401
Total Acres:	40.00
Timber Acres:	39.00
Sec-Twp-Rng:	23-19-03
Lot/Block:	/
Subdivision:	
Legal Description:	SE/4 SW/4
School District:	45 SLOAN HENDRIX
Improvement Districts:	MARTIN CREEK FIRE DISTRICT
Homestead Parcel?:	No
Tax Status:	Taxable
Over 65?:	No
Parcel Boundary	

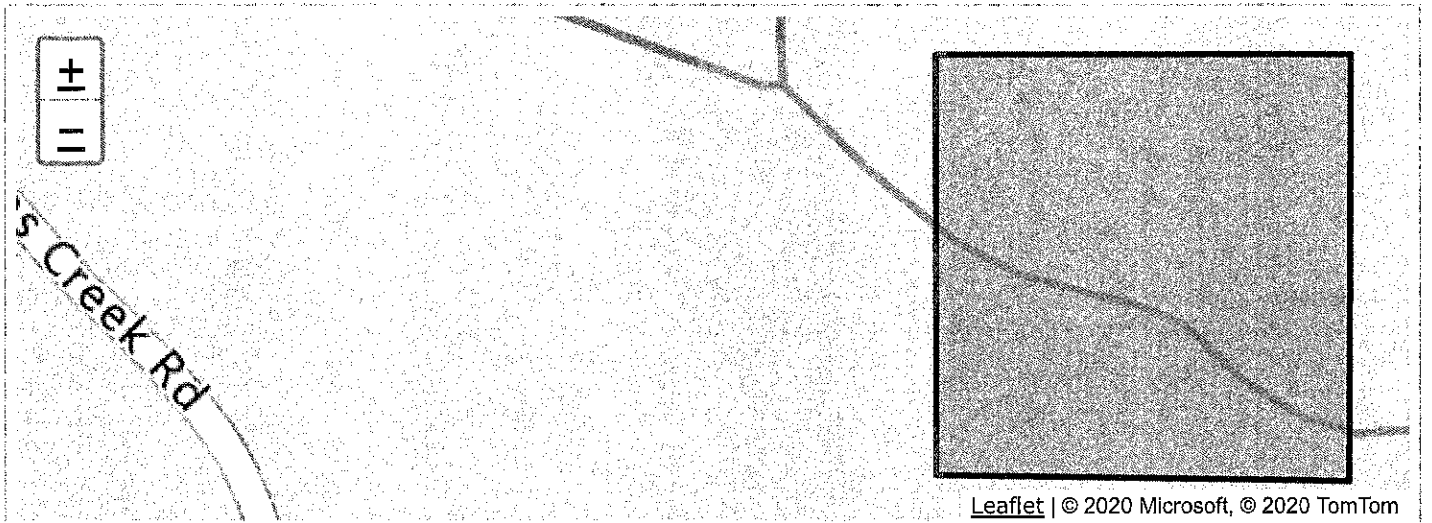

Land Information						
Land Type	Quantity	Front Width	Rear Width	Depth 1	Depth 2	Quarter
PASTURE	0.23 acres [10,018 sqft]					SW
TIMBER	39.77 acres [1,732,381 sqft]					SW

Valuation Information			<a href="#">view prior year information</a>
Entry	Appraised	Assessed	
Land:	5,200	1,040	
Improvements:	0	0	
Total Value:	5,200	1,040	
Taxable Value:		1,040	
Millage:		0.04278	
Timber:		7.8	
Estimated Taxes ⓘ:		\$52.29	
Assessment Year:		2015	

Tax Information
-----------------

Year	Book	Tax Owed	Tax Paid	Balance
<u>2019</u>	Current	\$77.29	\$0.00	\$77.29
<u>2018</u>	Current	\$77.29	-\$77.29	\$0.00
<u>2017</u>	Current	\$77.29	-\$77.29	\$0.00
<u>2016</u>	Current	\$77.29	-\$77.29	\$0.00
<u>2015</u>	Current	\$77.29	-\$77.29	\$0.00
<u>2014</u>	Current	\$82.62	-\$82.62	\$0.00
<u>2013</u>	Current	\$82.62	-\$82.62	\$0.00
<u>2012</u>	Delinquent	\$80.62	-\$80.62	\$0.00
<u>2011</u>	Delinquent	\$80.62	-\$80.62	\$0.00
<u>2010</u>	Current	\$76.35	-\$76.35	\$0.00
<u>2009</u>	Current	\$66.46	-\$66.46	\$0.00
<u>2008</u>	Current	\$66.46	-\$66.46	\$0.00
<u>2007</u>	Current	\$66.46	-\$66.46	\$0.00

Receipts

Receipt #	Book	Tax Year	ReceiptDate	Cash Amt	Check Amt	Credit Amt	Total
<u>10345</u>	Current	2018	8/16/2019	\$0.00	\$0.00	\$307.70	\$307.70
<u>17724</u>	Current	2017	10/22/2018	\$0.00	\$307.70	\$0.00	\$307.70
<u>18055</u>	Current	2016	10/19/2017	\$0.00	\$0.00	\$307.70	\$307.70
<u>16218</u>	Current	2015	10/20/2016	\$0.00	\$0.00	\$307.70	\$307.70
<u>18321</u>	Current	2014	10/19/2015	\$0.00	\$286.94	\$0.00	\$286.94
<u>6792</u>	Current	2013	4/4/2014	\$0.00	\$277.52	\$0.00	\$277.52
<u>235189</u>	Delinquent	2012	3/5/2014	\$0.00	\$0.00	\$215.56	\$215.56
<u>230307</u>	Delinquent	2011	11/26/2012	\$0.00	\$212.25	\$0.00	\$212.25
<u>5261</u>	Current	2010	3/21/2011	\$0.00	\$173.59	\$0.00	\$173.59
<u>5613</u>	Current	2009	3/18/2010	\$0.00	\$145.31	\$0.00	\$145.31
<u>9160</u>	Current	2008	5/26/2009	\$0.00	\$145.31	\$0.00	\$145.31
<u>12494</u>	Current	2007	9/12/2008	\$0.00	\$145.31	\$0.00	\$145.31

Sales History



Filed	Sold	Price	Grantor	Grantee	Book	Page	Deed Type
10/26/2015	9/22/2015	0	WEBB	WEBB	2015	16245	G D(GIFT OR GRANT DEED)
5/7/2014	5/7/2014	130,000	DURHAM	WEBB	2014	6898	WD/WOL(Warranty Deed with other)
4/4/2014	4/3/2014	100,000	MAZA	DURHAM	2014	5141	WD/WOL(Warranty Deed with other)
4/4/2014	1/6/2014	0	COURT	MAZA	2014	5136	ORDER(COURT ORDER)
4/4/2014	12/10/2013	0	B L MAZA		2014	5139	DC(Death Certificate)
11/19/2001	11/19/2001	80,000	PRATT	MAZA	2001	22194	WD/WOL(Warranty Deed with other)
9/14/2001	9/14/2001	0	PRATT	PRATT	2001	19163	
11/9/1995	11/9/1995	35,000			320	703	WD(Warranty Deed)
10/16/1995	10/16/1995	0			320	161	QCD(Quit Claim Deed)
4/21/1995	4/21/1995	0			314	575	WD(Warranty Deed)
9/22/1993	9/22/1993	0			297	529	QCD(Quit Claim Deed)
		0		GRAY	59	100	

# WEBB MICHAEL & MARK

BEAR BLUFF TRL

Logged In:  
2 minutes  
Total Time:  
2 minutes

Basic Information	
Parcel Number:	001-00323-001
County Name:	Sharp County
Property Address:	WEBB MICHAEL & MARK BEAR BLUFF TRL <a href="#">Map This Address</a>
Mailing Address:	WEBB MICHAEL & MARK 2307 RACE ST JONESBORO AR 72401
Total Acres:	40.00
Timber Acres:	40.00
Sec-Twp-Rng:	23-19-03
Lot/Block:	/
Subdivision:	
Legal Description:	NE/4 SW/4
School District:	45 SLOAN HENDRIX
Homestead Parcel?:	No
Tax Status:	Taxable
Over 65?:	No
Parcel Boundary	

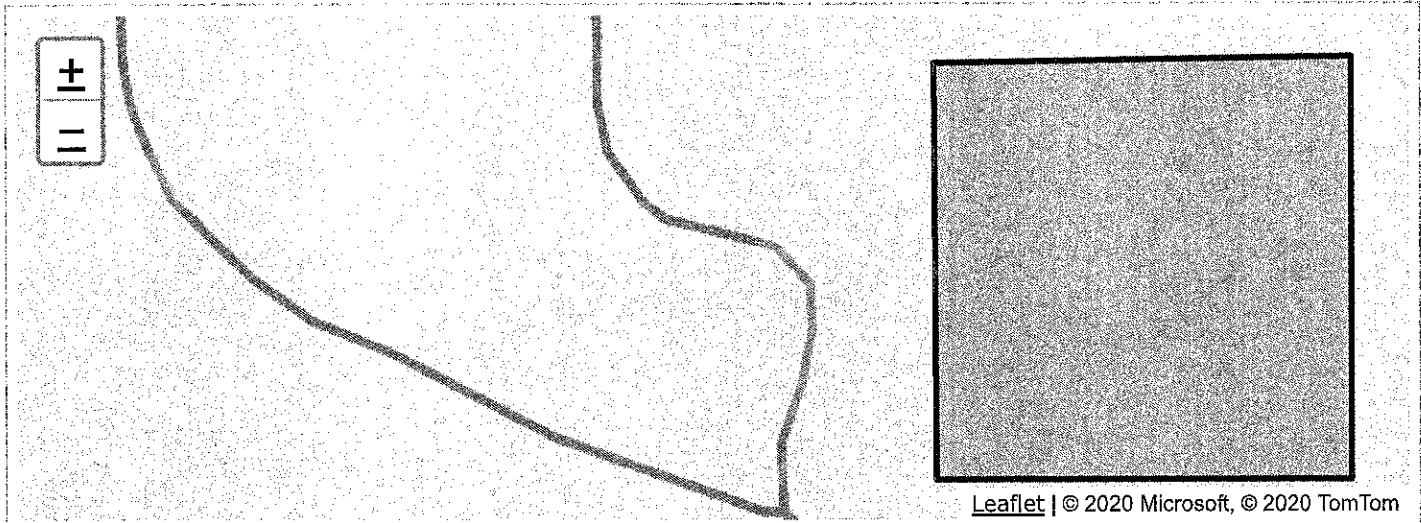

Leaflet | © 2020 Microsoft, © 2020 TomTom

**Land Information**

Land Type	Quantity	Front Width	Rear Width	Depth 1	Depth 2	Quarter
TIMBER	40.00 acres [1,742,400 sqft]					SW

**Valuation Information**

[view prior year information](#)

Entry	Appraised	Assessed
Land:	5,200	1,040
Improvements:	0	0
Total Value:	5,200	1,040
Taxable Value:		1,040
Millage:		0.04278
Timber:		8
Estimated Taxes ⓘ:		\$52.49
Assessment Year:		2015

**Tax Information**

Year	Book	Tax Owed	Tax Paid	Balance
<u>2019</u>	Current	\$52.49	\$0.00	\$52.49
<u>2018</u>	Current	\$52.49	-\$52.49	\$0.00
<u>2017</u>	Current	\$52.49	-\$52.49	\$0.00
<u>2016</u>	Current	\$52.49	-\$52.49	\$0.00
<u>2015</u>	Current	\$52.49	-\$52.49	\$0.00
<u>2014</u>	Current	\$57.62	-\$57.62	\$0.00

**Receipts**

Receipt #	Book	Tax Year	ReceiptDate	Cash Amt	Check Amt	Credit Amt	Total
<u>10346</u>	Current	2018	8/16/2019	\$0.00	\$0.00	\$52.49	<b>\$52.49</b>
<u>17723</u>	Current	2017	10/22/2018	\$0.00	\$52.49	\$0.00	<b>\$52.49</b>
<u>18060</u>	Current	2016	10/19/2017	\$0.00	\$0.00	\$52.49	<b>\$52.49</b>
<u>16222</u>	Current	2015	10/20/2016	\$0.00	\$0.00	\$52.49	<b>\$52.49</b>
<u>10276</u>	Current	2014	7/14/2015	\$0.00	\$57.62	\$0.00	<b>\$57.62</b>

Sales History 

Filed	Sold	Price	Grantor	Grantee	Book	Page	Deed Type
9/22/2014	9/19/2014	60,000	HIRSCH TRUST	WEBB	2014	14722	TR D(Trust Deed)