

Soils Map - Total Acres

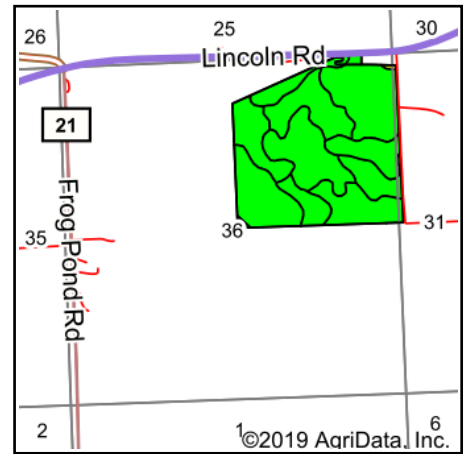

State: **Illinois**
 County: **Whiteside**
 Location: **36-22N-3E**
 Township: **Fulton**
 Acres: **139.28**
 Date: **6/30/2020**

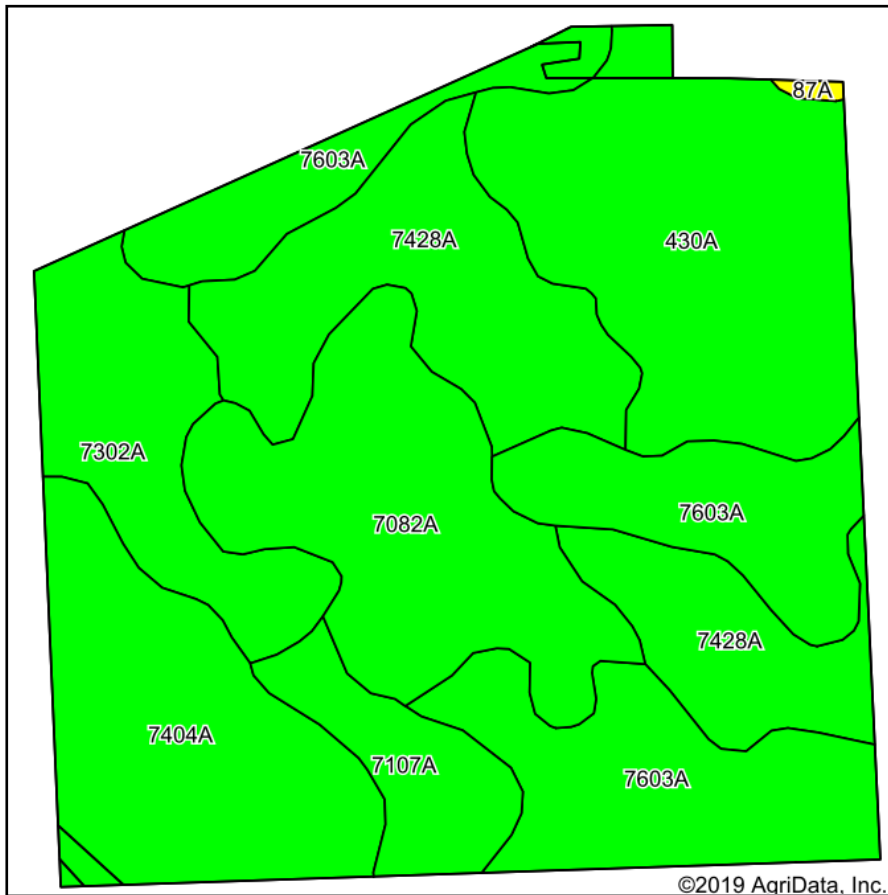

Maps Provided By:



Area Symbol: IL195. Soil Area Version: 16										
Code	Soil Description	Acres	Percent of field	Il. State Productivity Index Legend	Corn Bu/A	Soybeans Bu/A	Wheat Bu/A	Oats Bu/A	Alfalfa d hay, T/A	Crop productivity index for optimum management
7603A	Blackoar silt loam, 0 to 2 percent slopes, rarely flooded	30.04	21.6%		178	57	66	88	0.00	131
430A	Raddle silt loam, 0 to 2 percent slopes	25.46	18.3%		189	59	73	97	6.52	138
7428A	Coffeen silt loam, 0 to 2 percent slopes, rarely flooded	24.95	17.9%		181	57	68	90	0.00	132
7082A	Millington clay loam, 0 to 2 percent slopes, rarely flooded	20.91	15.0%		171	54	65	79	0.00	125
7404A	Titus silty clay loam, 0 to 2 percent slopes, rarely flooded	18.92	13.6%		158	52	61	75	0.00	118
7302A	Ambraw clay loam, 0 to 2 percent slopes, rarely flooded	12.39	8.9%		154	50	61	75	0.00	114
7107A	Sawmill silty clay loam, 0 to 2 percent slopes, rarely flooded	6.35	4.6%		189	60	71	98	0.00	139
87A	Dickinson sandy loam, 0 to 2 percent slopes	0.26	0.2%		142	46	56	74	3.39	104
Weighted Average					175.1	55.7	66.6	86.2	1.20	128.6

Table: Optimum Crop Productivity Ratings for Illinois Soil by K.R. Olson and J.M. Lang, Office of Research, ACES, University of Illinois at Champaign-Urbana. Version: 1/2/2012 Amended Table S2 B811

Crop yields and productivity indices for optimum management (B811) are maintained at the following NRES web site: <http://soilproductivity.nres.illinois.edu/>

** Indexes adjusted for slope and erosion according to Bulletin 811 Table S3

b Soils in the southern region were not rated for oats and are shown with a zero "0".

d Soils in the poorly drained group were not rated for alfalfa and are shown with a zero "0".

*c: Using Capabilities Class Dominant Condition Aggregation Method

Soils data provided by USDA and NRCS. Soils data provided by University of Illinois at Champaign-Urbana.