

# Tillable Soils Map

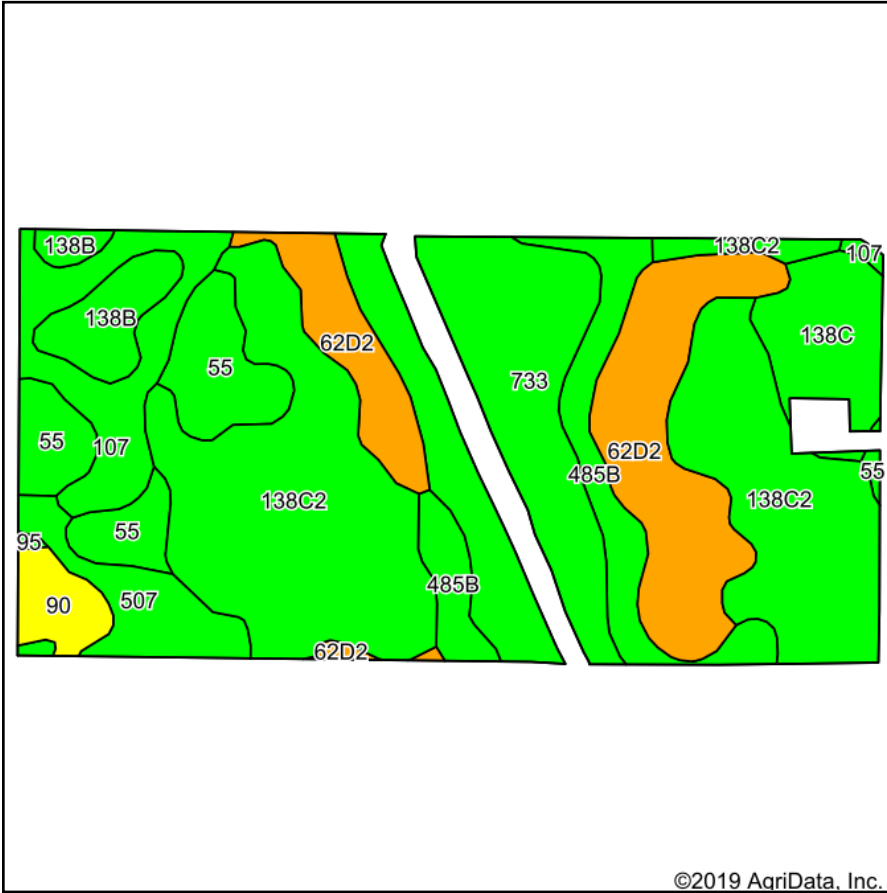

Soils data provided by USDA and NRCS.

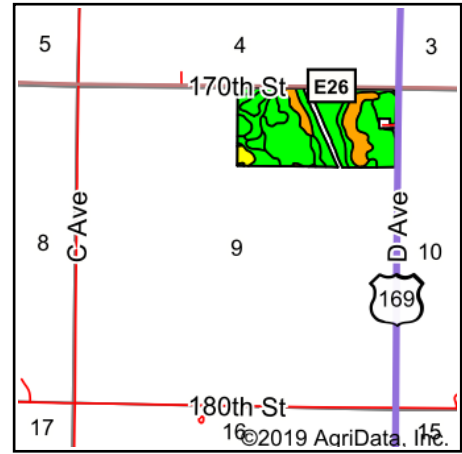

State: **Iowa**  
 County: **Boone**  
 Location: **9-84N-28W**  
 Township: **Amaqua**  
 Acres: **73.76**  
 Date: **6/18/2020**



Maps Provided By:



© AgriData, Inc. 2019

www.AqriDataInc.com



Area Symbol: IA015. Soil Area Version: 27											
Code	Soil Description	Acres	Percent of field	CSR2 Legend	Non-Irr Class *c	*i Corn	*i Soybeans	CSR2**	CSR	*n NCCPI Overall	
138C2	Clarion loam, 6 to 10 percent slopes, moderately eroded	23.52	31.9%		IIIe	204.8	59.4	83	66	65	
733	Calco silty clay loam, 0 to 2 percent slopes, occasionally flooded	12.39	16.8%		IIw	204.8	59.4	78	77	82	
62D2	Storden loam, 10 to 16 percent slopes, moderately eroded	11.09	15.0%		IVe	80	23.2	41	38	61	
55	Nicollet clay loam, 1 to 3 percent slopes	5.72	7.8%		Iw	233.6	67.7	89	92	82	
485B	Spillville loam, 2 to 5 percent slopes	5.36	7.3%		Ile	200	58	88	87	89	
107	Webster clay loam, 0 to 2 percent slopes	4.93	6.7%		IIw	224	65	86	87	80	
138C	Clarion loam, 6 to 10 percent slopes	3.62	4.9%		IIIe	209.6	60.8	84	69	80	
507	Canisteo clay loam, 0 to 2 percent slopes	2.83	3.8%		IIw	224	65	84	82	79	
138B	Clarion loam, 2 to 6 percent slopes	2.57	3.5%		Ile	225.6	65.4	89	84	83	
90	Okoboji mucky silt loam, 0 to 1 percent slopes	1.55	2.1%		IIIw	177.6	51.5	56	61	77	
95	Harps clay loam, 0 to 2 percent slopes	0.18	0.2%		IIw	198.4	57.5	72	64	77	
<b>Weighted Average</b>						<b>190.3</b>	<b>55.2</b>	<b>76.6</b>	<b>69.9</b>	<b>*n 73.5</b>	

\*\*IA has updated the CSR values for each county to CSR2.

\*i Yield data provided by the ISPAID Database version 8.1.1 developed by IA State University.

\*n: The aggregation method is "Weighted Average using major components"

\*c: Using Capabilities Class Dominant Condition Aggregation Method

Soils data provided by USDA and NRCS.