

# Soils Map - Estimated Tillable Acres

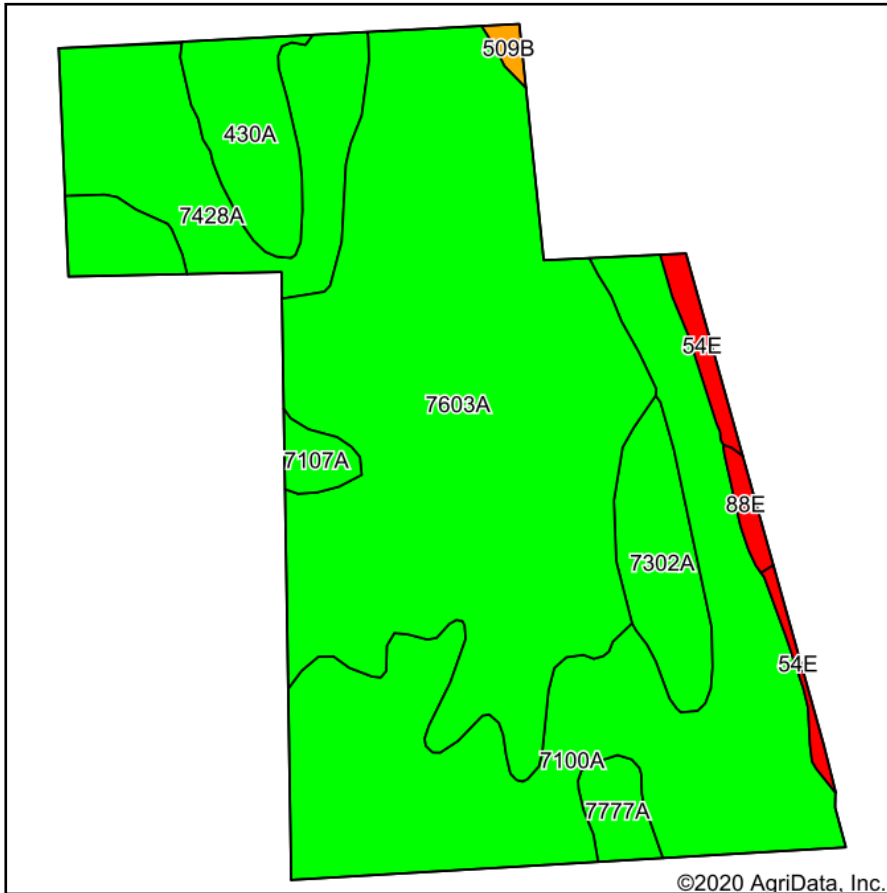

Soils data provided by USDA and NRCS.

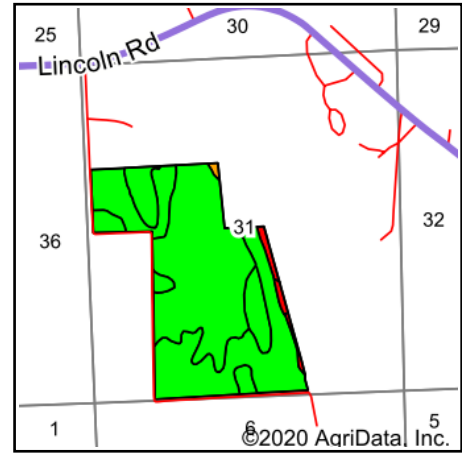

State: **Illinois**  
 County: **Whiteside**  
 Location: **31-22N-4E**  
 Township: **Ustick**  
 Acres: **171.55**  
 Date: **7/16/2020**



Area Symbol: IL195. Soil Area Version: 16										
Code	Soil Description	Acres	Percent of field	Il. State Productivity Index Legend	Corn Bu/A	Soybeans Bu/A	Wheat Bu/A	Oats Bu/A	Alfalfa d hay, T/A	Crop productivity index for optimum management
7603A	Blackoar silt loam, 0 to 2 percent slopes, rarely flooded	79.19	46.2%		178	57	66	88	0.00	131
7100A	Palms muck, 0 to 2 percent slopes, rarely flooded	49.63	28.9%		161	51	0	0	0.00	118
7428A	Coffeen silt loam, 0 to 2 percent slopes, rarely flooded	18.26	10.6%		181	57	68	90	0.00	132
7302A	Ambraw clay loam, 0 to 2 percent slopes, rarely flooded	8.12	4.7%		154	50	61	75	0.00	114
430A	Raddle silt loam, 0 to 2 percent slopes	7.70	4.5%		189	59	73	97	6.52	138
7777A	Adrian muck, 0 to 2 percent slopes, rarely flooded	2.64	1.5%		146	49	0	0	0.00	110
**54E	Plainfield sand, 12 to 20 percent slopes	2.61	1.5%		**86	**30	**35	**42	0.00	**66
7107A	Sawmill silty clay loam, 0 to 2 percent slopes, rarely flooded	1.79	1.0%		189	60	71	98	0.00	139
**88E	Sparta loamy sand, Illinois till plain, 12 to 20 percent slopes	1.02	0.6%		**104	**36	**44	**50	0.00	**80
**509B	Whalan loam, 2 to 5 percent slopes	0.59	0.3%		**122	**39	**50	**64	**2.98	**89
<b>Weighted Average</b>					<b>170.3</b>	<b>54.3</b>	<b>45.6</b>	<b>60.3</b>	<b>0.30</b>	<b>125.2</b>

**Table: Optimum Crop Productivity Ratings for Illinois Soil by K.R. Olson and J.M. Lang, Office of Research, ACES, University of Illinois at Champaign-Urbana.** Version: 1/2/2012 Amended Table S2 B811

Crop yields and productivity indices for optimum management (B811) are maintained at the following NRES web site: <http://soilproductivity.nres.illinois.edu/>

\*\* Indexes adjusted for slope and erosion according to Bulletin 811 Table S3

**b** Soils in the southern region were not rated for oats and are shown with a zero "0".

**d** Soils in the poorly drained group were not rated for alfalfa and are shown with a zero "0".

\*c: Using Capabilities Class Dominant Condition Aggregation Method

Soils data provided by USDA and NRCS. Soils data provided by University of Illinois at Champaign-Urbana.