

Soils Map - Total Acres

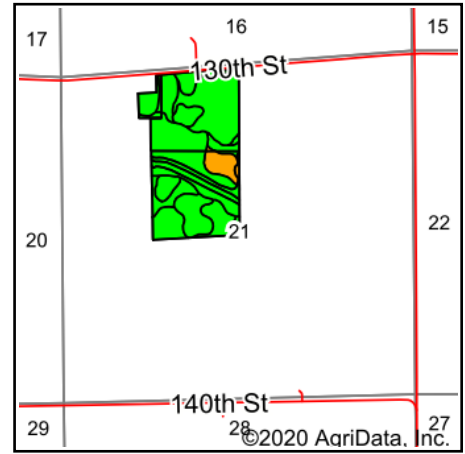

State: **Iowa**
 County: **Cedar**
 Location: **21-82N-1W**
 Township: **Massillon**
 Acres: **80.09**
 Date: **7/23/2020**

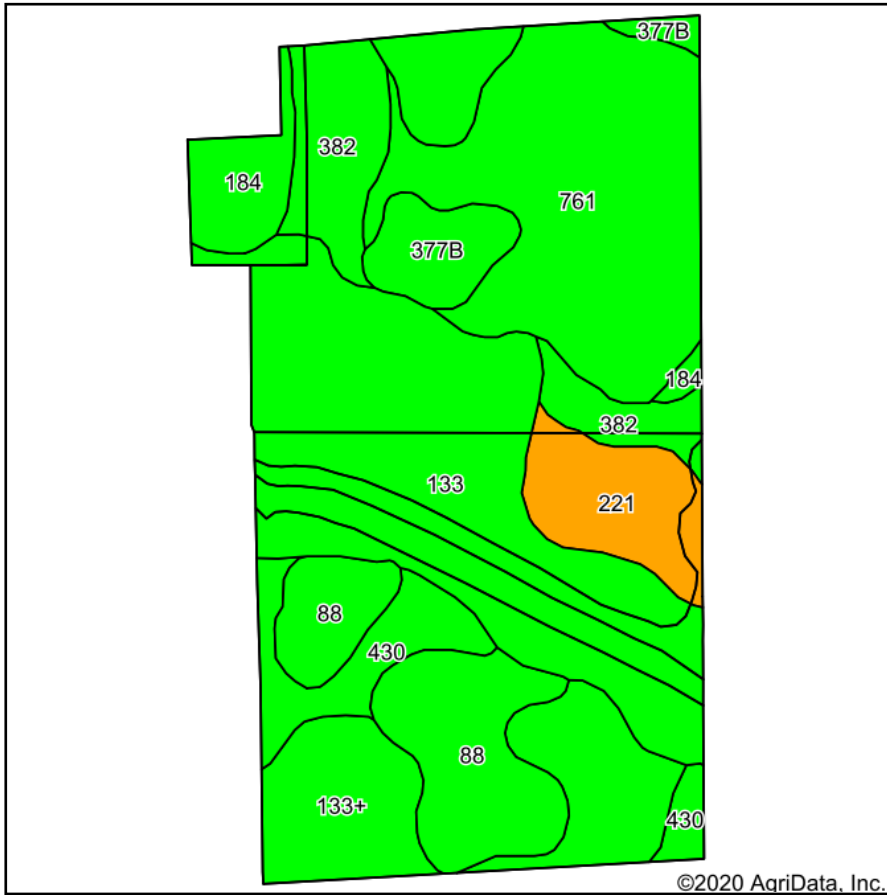

Soils data provided by USDA and NRCS.

Area Symbol: IA031, Soil Area Version: 24																	
Code	Soil Description	Acres	Percent of field	CSR2 Legend	Non-Irr Class *c	*i Corn	*i Alfalfa	*i Soybeans	CSR2**	CSR	Corn	Oats	Soybeans	*n NCCPI Overall	*n NCCPI Corn	*n NCCPI Small Grains	*n NCCPI Soybeans
133	Colo silty clay loam, 0 to 2 percent slopes, occasionally flooded	22.97	28.7%		llw	204.8	4.3	59.4	78	80				95	95	12	71
761	Franklin silt loam, 1 to 3 percent slopes	16.65	20.8%		le	224	5.8	65	85	83	10	5	3	95	95	36	91
133+	Colo silt loam, 0 to 2 percent slopes, occasionally flooded, overwash	9.24	11.5%		llw	204.8	4.3	59.4	78	85				94	94	13	78
88	Nevin silty clay loam, 0 to 2 percent slopes, rarely flooded	8.61	10.8%		lw	227.2	5.9	65.9	94	92				99	99	68	87
382	Maxfield silty clay loam, 0 to 2 percent slopes	5.88	7.3%		llw	230.4	4.8	66.8	87	90				74	74	11	63
184	Klinger silty clay loam, 1 to 4 percent slopes	5.06	6.3%		lw	240	6.2	69.6	95	93				88	88	31	81
221	Klossner muck, 1 to 4 percent slopes	4.48	5.6%		lllw	80	1.7	23.2	48	45				89	89	16	85



430	Ackmore silt loam, 0 to 2 percent slopes, occasionally flooded	4.13	5.2%		llw	203.2	5.3	58.9	77	83				86	86	59	76
377B	Dinsdale silty clay loam, 2 to 5 percent slopes	3.07	3.8%		lle	232	6.5	67.3	94	90				88	88	57	75
Weighted Average						209.3	4.9	60.7	81.8	82.6	2.1	1	0.6	*n 92.3	*n 92.3	*n 28.6	*n 78.9

**IA has updated the CSR values for each county to CSR2.

*i Yield data provided by the ISPAID Database version 8.1.1 developed by IA State University.

*n: The aggregation method is "Weighted Average using major components"

*c: Using Capabilities Class Dominant Condition Aggregation Method

Soils data provided by USDA and NRCS.