

# Soils Map

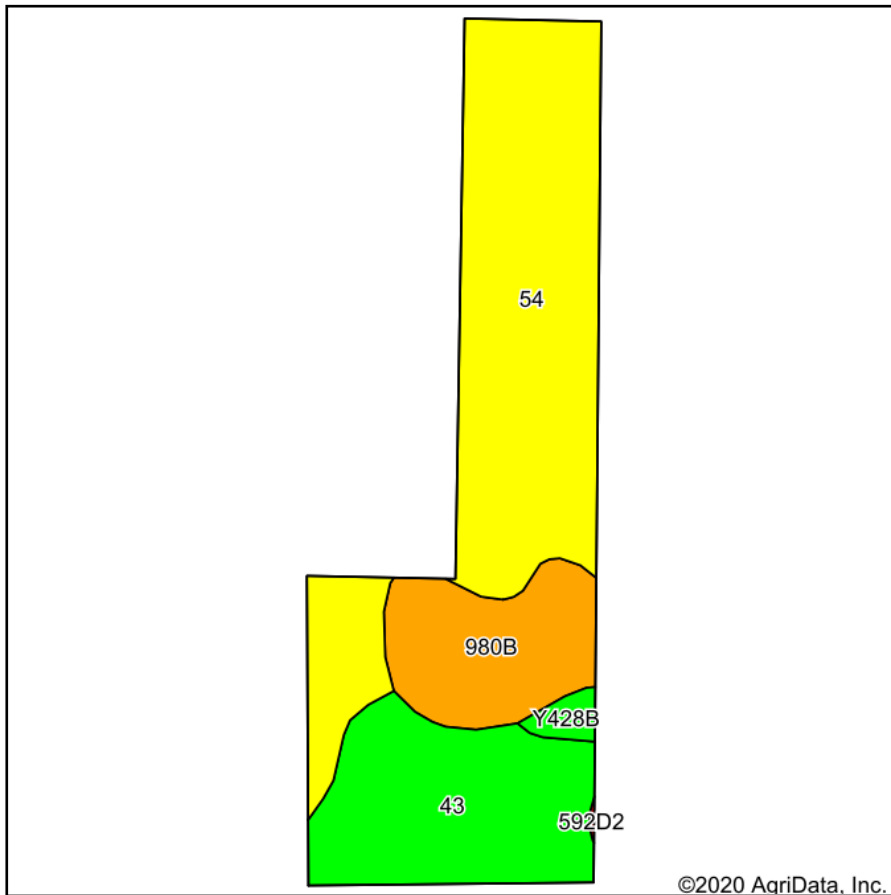

Soils data provided by USDA and NRCS.

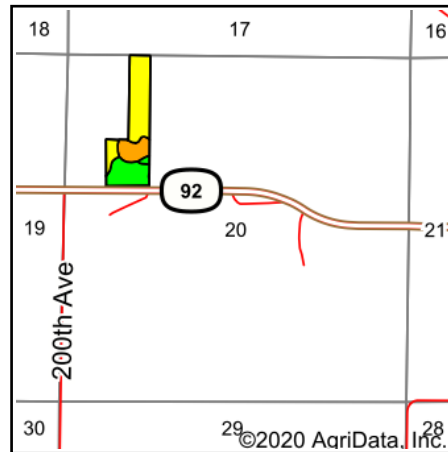

State: **Iowa**  
 County: **Warren**  
 Location: **20-76N-22W**  
 Township: **Union**  
 Acres: **20**  
 Date: **7/31/2020**



Maps Provided By:



Area Symbol: IA181. Soil Area Version: 25										
Code	Soil Description	Acres	Percent of field	CSR2 Legend	Non-Irr Class *c	CSR2**	CSR	*n NCCPI Overall	*n NCCPI Soybeans	
54	Zook silty clay loam, 0 to 2 percent slopes, occasionally flooded	11.05	55.2%	Yellow	IIw	67	70	63	63	
43	Bremer silty clay loam, 0 to 2 percent slopes, occasionally flooded	5.26	26.3%	Green	IIw	74	82	85	78	
980B	Gullied land-Ely-Colo, occasionally flooded, complex, 2 to 5 percent slopes	3.37	16.8%	Orange	VIIe	42	25	10	9	
Y428B	Ely silty clay loam, dissected till plain, 2 to 5 percent slopes	0.32	1.6%	Light Green	IIe	88		95	79	
<b>Weighted Average</b>						<b>65</b>	<b>*</b>	<b>*n 60.4</b>	<b>*n 58.1</b>	

\*\*IA has updated the CSR values for each county to CSR2.

\*- CSR weighted average cannot be calculated on the current soils data, use prior data version for csr values.

\*n: The aggregation method is "Weighted Average using all components"

\*c: Using Capabilities Class Dominant Condition Aggregation Method

Soils data provided by USDA and NRCS.