

# Soils Map - CRP Acres

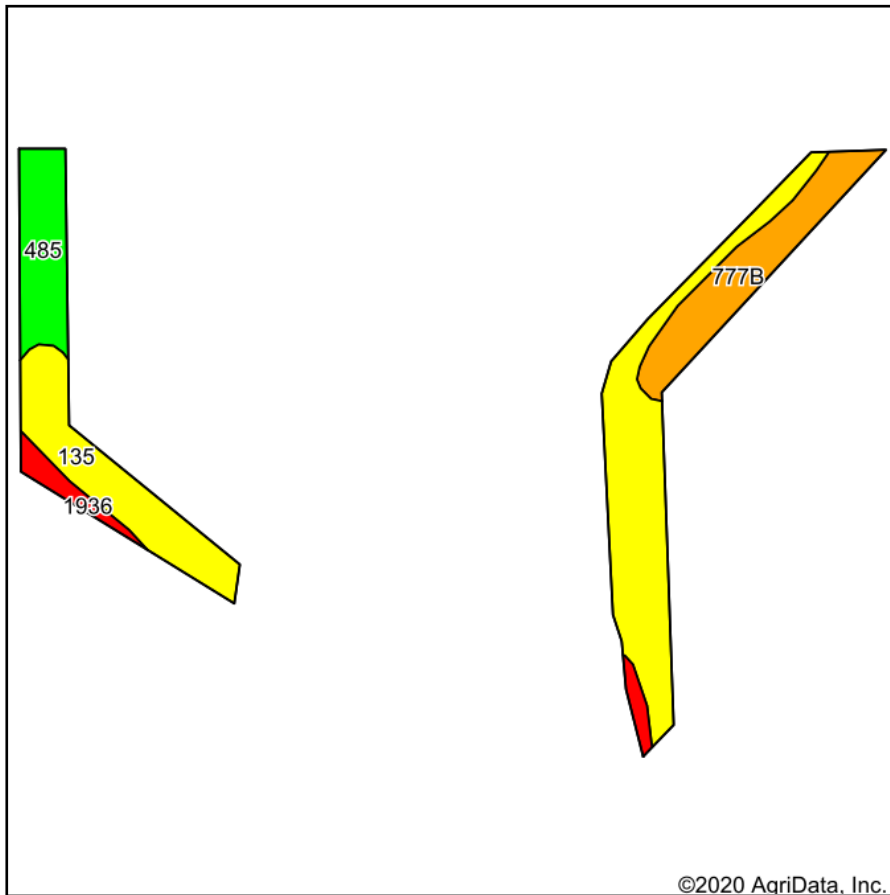

Soils data provided by USDA and NRCS.

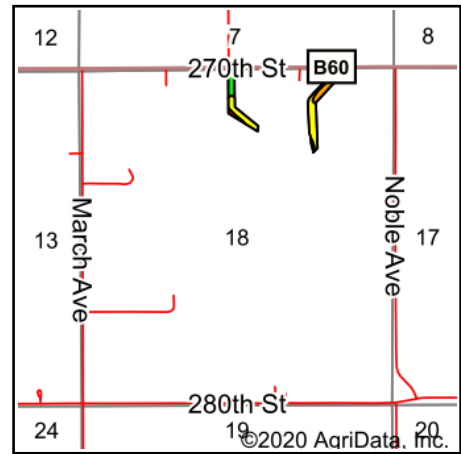

State: **Iowa**  
 County: **Floyd**  
 Location: **18-94N-16W**  
 Township: **Pleasant Grove**  
 Acres: **6.8**  
 Date: **8/6/2020**



Maps Provided By:



| Area Symbol: IA067. Soil Area Version: 26 |  |       |                  |             |                  |              |            |             |           |           |                  |                |                       |                   |  |
|---|--|-------|------------------|-------------|------------------|--------------|------------|-------------|-----------|-----------|------------------|----------------|-----------------------|-------------------|--|
| Code                                      | Soil Description   | Acres | Percent of field | CSR2 Legend | Non-Irr Class *c | *i Corn      | *i Alfalfa | *i Soybeans | CSR2**    | CSR       | *n NCCPI Overall | *n NCCPI Corn  | *n NCCPI Small Grains | *n NCCPI Soybeans |  |
| 135                                       | Coland clay loam, 0 to 2 percent slopes, occasionally flooded      | 3.98  | 58.5%            | Yellow      | Ilw              | 198.4        | 4.2        | 57.5        | 65        | 80        | 87               | 87             | 44                    | 66                |  |
| 777B                                      | Wapsie loam, 2 to 5 percent slopes                                 | 1.40  | 20.6%            | Orange      | Ile              | 80           | 2.2        | 23.2        | 48        | 53        | 66               | 66             | 60                    | 42                |  |
| 485                                       | Spillville loam, 0 to 2 percent slopes, occasionally flooded       | 1.02  | 15.0%            | Green       | Ilw              | 208          | 5.8        | 60.3        | 76        | 92        | 87               | 87             | 51                    | 74                |  |
| 1936                                      | Spillville-Hanlon-Coland complex, channeled, 0 to 3 percent slopes | 0.40  | 5.9%             | Red         | Vw               | 120          | 2.5        | 34.8        | 29        | 25        | 50               | 50             | 26                    | 42                |  |
| <b>Weighted Average</b>                   |  |       |                  |             |                  | <b>170.9</b> | <b>3.9</b> | <b>49.5</b> | <b>61</b> | <b>73</b> | <b>*n 80.5</b>   | <b>*n 80.5</b> | <b>*n 47.3</b>        | <b>*n 60.8</b>    |  |

\*\*IA has updated the CSR values for each county to CSR2.

\*i Yield data provided by the ISPAID Database version 8.1.1 developed by IA State University.

\*n: The aggregation method is "Weighted Average using all components"

\*c: Using Capabilities Class Dominant Condition Aggregation Method

Soils data provided by USDA and NRCS.