

# Soils Map

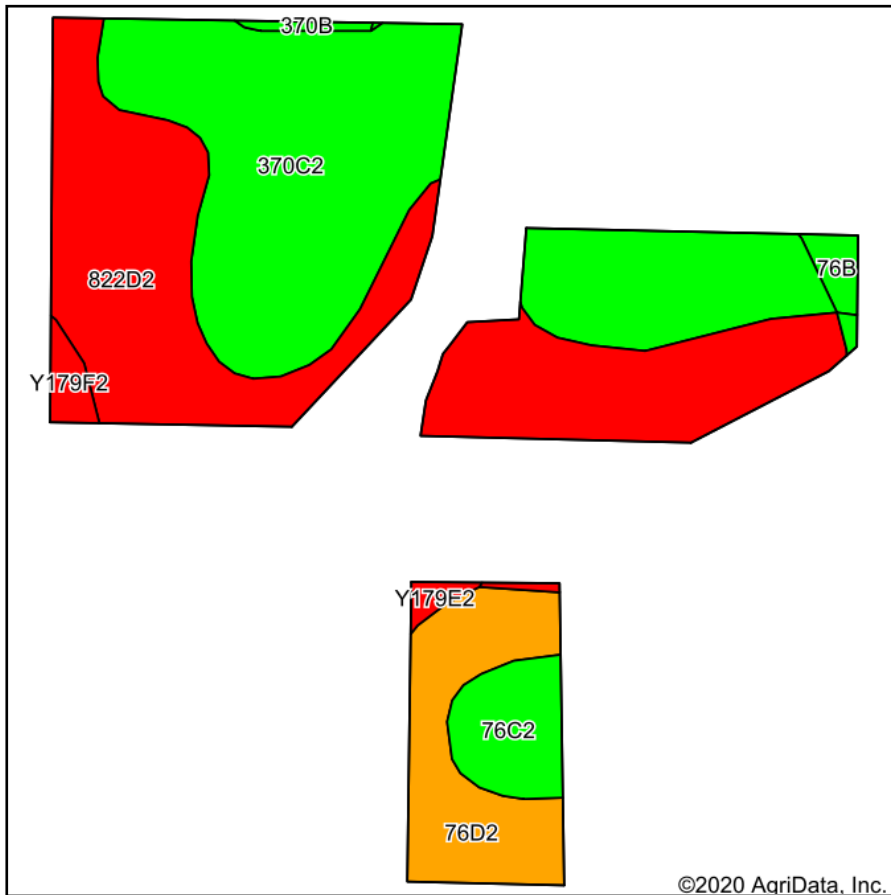

Soils data provided by USDA and NRCS.

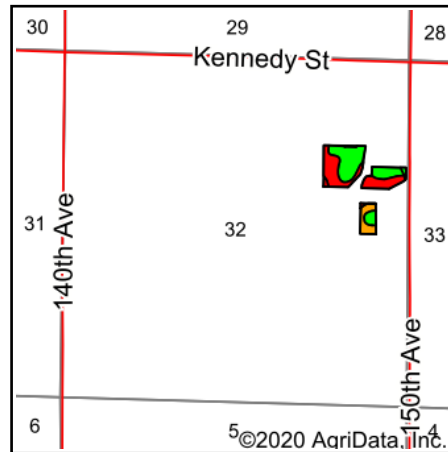

State: **Iowa**  
 County: **Warren**  
 Location: **32-76N-23W**  
 Township: **Lincoln**  
 Acres: **15.05**  
 Date: **8/26/2020**



Area Symbol: IA181. Soil Area Version: 25

Code	Soil Description	Acres	Percent of field	CSR2 Legend	Non-Irr Class *c	CSR2**	CSR	*n NCCPI Overall	*n NCCPI Corn	*n NCCPI Small Grains	*n NCCPI Soybeans
370C2	Sharpsburg silty clay loam, 5 to 9 percent slopes, eroded	6.36	42.3%	Green	IIIe	80	67	84	84	69	67
822D2	Lamoni silty clay loam, 9 to 14 percent slopes, eroded	5.65	37.5%	Red	IVe	10	15	61	61	55	43
76D2	Ladoga silt loam, 9 to 14 percent slopes, eroded	1.70	11.3%	Orange	IIIe	49	55	75	75	66	62
76C2	Ladoga silt loam, dissected till plain, 5 to 9 percent slopes, eroded	0.81	5.4%	Green	IIIe	75	65	78	78	69	66
Y179F2	Gara loam, dissected till plain, 18 to 25 percent slopes, eroded	0.19	1.3%	Red	VIIe	16		57	57	36	37
76B	Ladoga silt loam, 2 to 5 percent slopes	0.17	1.1%	Green	Ile	86	85	85	85	77	79
Y179E2	Gara loam, dissected till plain, 14 to 18 percent slopes, eroded	0.10	0.7%	Red	VIe	32		72	72	54	50
370B	Sharpsburg silty clay loam, 2 to 5 percent slopes	0.07	0.5%	Green	Ile	91	87	93	93	78	80
<b>Weighted Average</b>						<b>48.9</b>	<b>*</b>	<b>*n 73.7</b>	<b>*n 73.7</b>	<b>*n 63</b>	<b>*n 57.1</b>

\*\*IA has updated the CSR values for each county to CSR2.

\*- CSR weighted average cannot be calculated on the current soils data, use prior data version for csr values.

\*n: The aggregation method is "Weighted Average using all components"

\*c: Using Capabilities Class Dominant Condition Aggregation Method

Soils data provided by USDA and NRCS.