

Soils Map

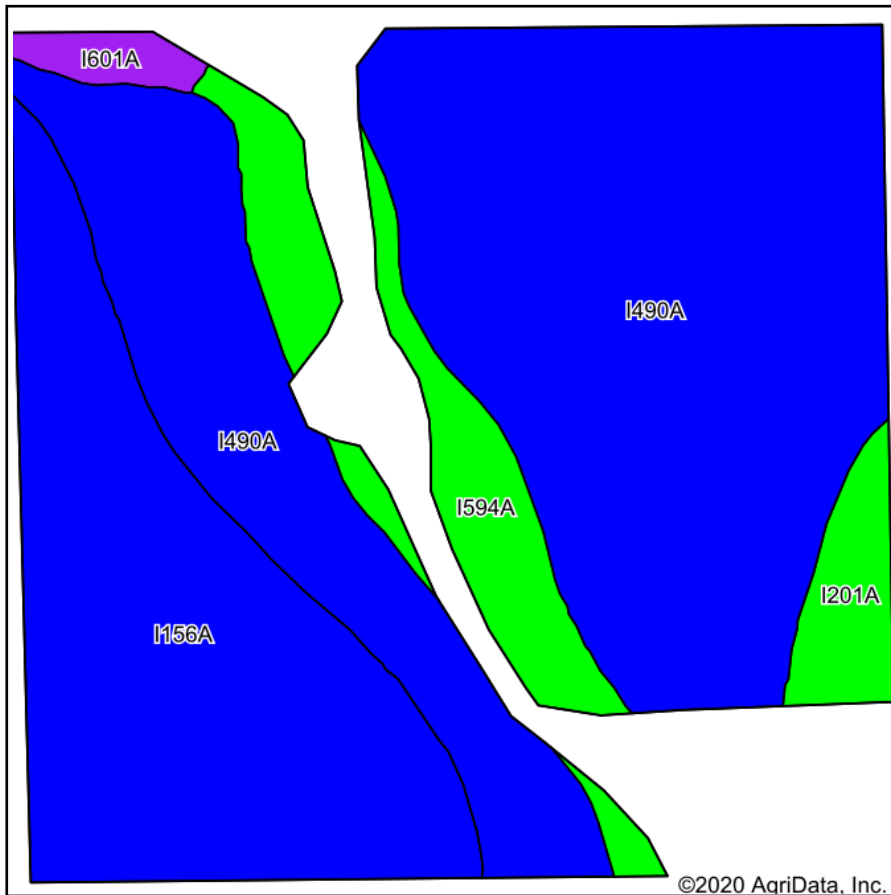

Soils data provided by USDA and NRCS.

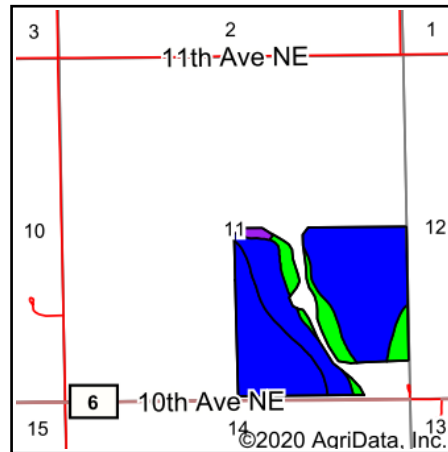

State: **North Dakota**
 County: **Grand Forks**
 Location: **11-150N-55W**
 Township: **Grace**
 Acres: **136.18**
 Date: **8/14/2020**



Area Symbol: ND035. Soil Area Version: 24

Code	Soil Description	Acres	Percent of field	PI Legend	Non-Irr Class *c	Range Production (lbs/acre/yr)	Productivity Index	*n NCCPI Overall	*n NCCPI Corn	*n NCCPI Small Grains	*n NCCPI Soybeans
I490A	Glyndon-Tiffany silt loams, 0 to 2 percent slopes	80.14	58.8%	Blue	Ile	4479	89	61	49	37	61
I156A	Antler silt loam, 0 to 2 percent slopes	37.08	27.2%	Blue	Ile	4115	83	72	49	40	72
I594A	LaDelle silt loam, 0 to 2 percent slopes, occasionally flooded	12.86	9.4%	Green	Ilc	3286	95	76	48	43	75
I201A	Glyndon silt loam, 0 to 2 percent slopes	4.27	3.1%	Green	Ile	4298	92	62	49	37	62
I601A	Bearden silty clay loam, moderately saline, 0 to 2 percent slopes	1.83	1.3%	Purple	IIIs	4066	52	44	22	29	44
Weighted Average						4256	87.5	*n 65.2	*n 48.5	*n 38.3	*n 65.1

*n: The aggregation method is "Weighted Average using all components"

*c: Using Capabilities Class Dominant Condition Aggregation Method

Soils data provided by USDA and NRCS.