

Soils Map

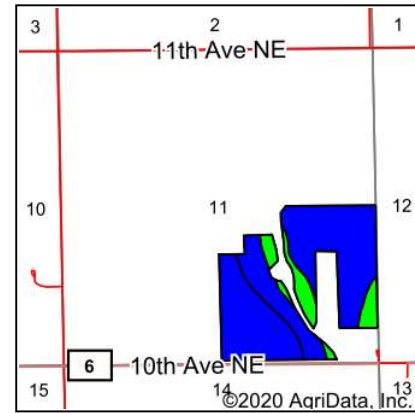

State: **North Dakota**
 County: **Grand Forks**
 Location: **11-150N-55W**
 Township: **Grace**
 Acres: **113.58**
 Date: **8/14/2020**

PEOPLES COMPANY
 INNOVATIVE. REAL ESTATE. SOLUTIONS.

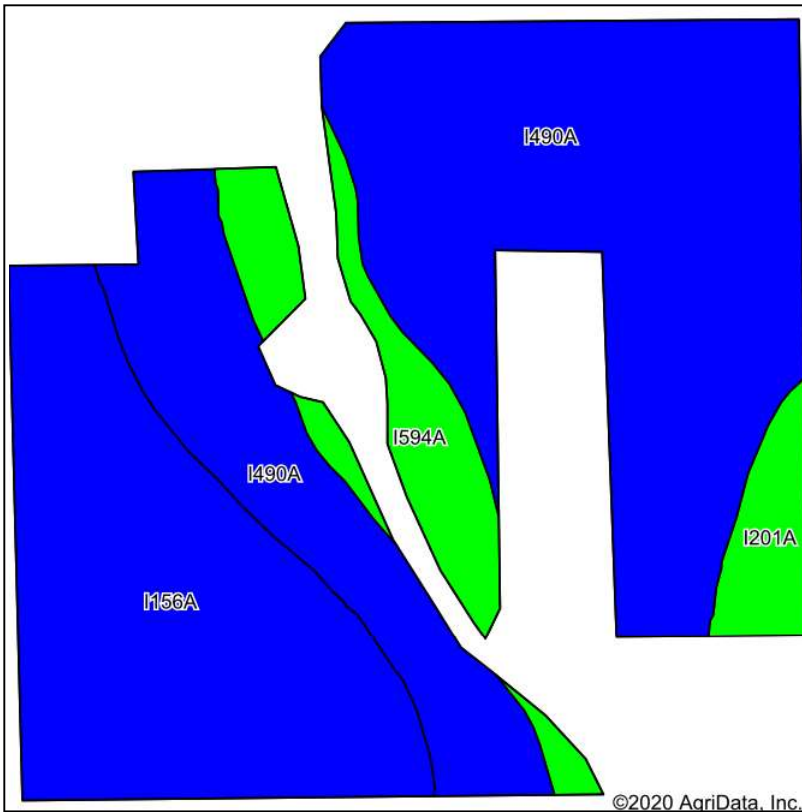

Soils data provided by USDA and NRCS.

Area Symbol: ND035, Soil Area Version: 24

Code	Soil Description	Acres	Percent of field	PI Legend	Non-Irr Class *c	Range Production (lbs/acre/yr)	Productivity Index	*n NCCPI Overall	*n NCCPI Corn	*n NCCPI Small Grains	*n NCCPI Soybeans
I490A	Glyndon-Tiffany silt loams, 0 to 2 percent slopes	64.22	56.5%	■	Ile	4479	89	61	49	37	61
I156A	Antler silt loam, 0 to 2 percent slopes	34.67	30.5%	■	Ile	4115	83	72	49	40	72
I594A	LaDelle silt loam, 0 to 2 percent slopes, occasionally flooded	10.46	9.2%	■	Ilc	3286	95	76	48	43	75
I201A	Glyndon silt loam, 0 to 2 percent slopes	4.23	3.7%	■	Ile	4298	92	62	49	37	62
Weighted Average						4251.3	87.8	*n 65.8	*n 48.9	*n 38.5	*n 65.7

*n: The aggregation method is "Weighted Average using all components"
 *c: Using Capabilities Class Dominant Condition Aggregation Method

Soils data provided by USDA and NRCS.