

# Soils Map

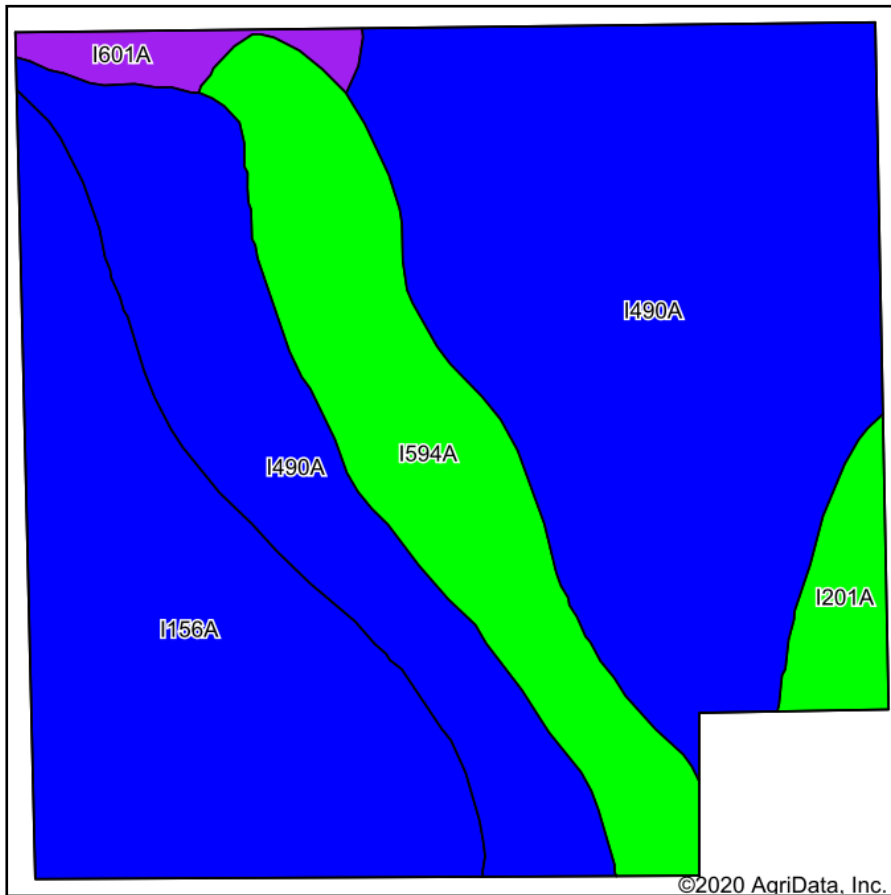

Soils data provided by USDA and NRCS.

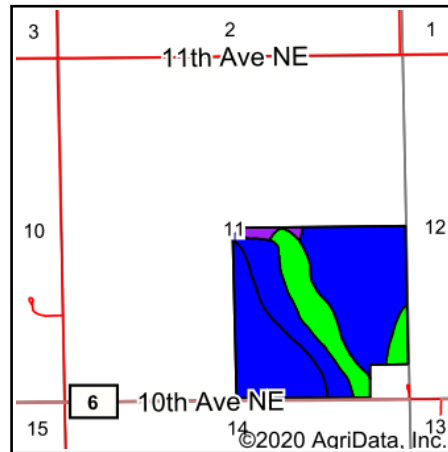

State: **North Dakota**  
 County: **Grand Forks**  
 Location: **11-150N-55W**  
 Township: **Grace**  
 Acres: **153.01**  
 Date: **8/26/2020**



Maps Provided By:



© AgriData, Inc. 2020

www.AgriDataInc.com



Area Symbol: ND035. Soil Area Version: 24

Code	Soil Description	Acres	Percent of field	PI Legend	Non-Irr Class *c	Range Production (lbs/acre/yr)	Productivity Index	*n NCCPI Overall	*n NCCPI Corn	*n NCCPI Small Grains	*n NCCPI Soybeans
I490A	Glyndon-Tiffany silt loams, 0 to 2 percent slopes	82.24	53.7%		Ile	4479	89	61	49	37	61
I156A	Antler silt loam, 0 to 2 percent slopes	38.97	25.5%		Ile	4115	83	72	49	40	72
I594A	LaDelle silt loam, 0 to 2 percent slopes, occasionally flooded	24.18	15.8%		Ilc	3286	95	76	48	43	75
I201A	Glyndon silt loam, 0 to 2 percent slopes	4.63	3.0%		Ile	4298	92	62	49	37	62
I601A	Bearden silty clay loam, moderately saline, 0 to 2 percent slopes	2.99	2.0%		IIIs	4066	52	44	22	29	44
<b>Weighted Average</b>						<b>4184.2</b>	<b>87.8</b>	<b>*n 65.9</b>	<b>*n 48.3</b>	<b>*n 38.6</b>	<b>*n 65.7</b>

\*n: The aggregation method is "Weighted Average using all components"

\*c: Using Capabilities Class Dominant Condition Aggregation Method

Soils data provided by USDA and NRCS.