

Soils Map

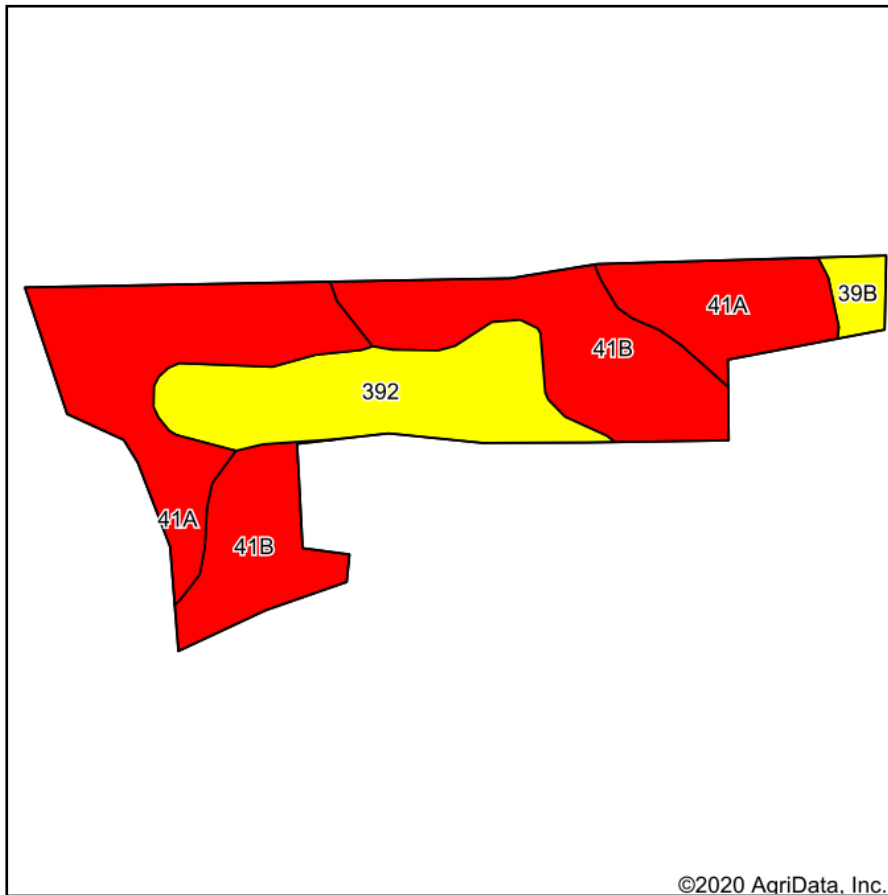

Soils data provided by USDA and NRCS.

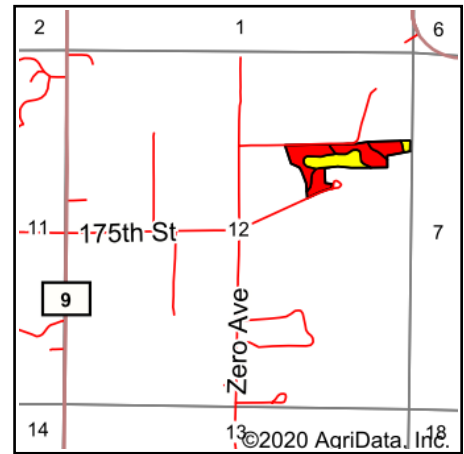

State: **Minnesota**
 County: **McLeod**
 Location: **12-116N-27W**
 Township: **Bergen**
 Acres: **17.3**
 Date: **9/9/2020**



Maps Provided By:



Area Symbol: MN085, Soil Area Version: 18

Code	Soil Description	Acres	Percent of field	PI Legend	Non-Irr Class *c	Productivity Index	Bromegrass alfalfa	Bromegrass alfalfa hay	Corn	Oats	Soybeans	*n NCCPI Overall	*n NCCPI Corn	*n NCCPI Small Grains	*n NCCPI Soybeans
41A	Estherville loam, 0 to 2 percent slopes	6.67	38.6%		III s	44	2.9	2.2	86	62	24	62	62	42	44
41B	Estherville sandy loam, 2 to 6 percent slopes	6.02	34.8%		III s	44						51	51	40	37
392	Biscay clay loam, 0 to 2 percent slopes	4.13	23.9%		II w	70						69	69	51	66
39B	Wadena loam, 2 to 6 percent slopes	0.48	2.8%		Ile	65						63	63	52	52
Weighted Average						50.8	1.1	0.8	33.2	23.9	9.3	*n 59.9	*n 59.9	*n 43.7	*n 47

*n: The aggregation method is "Weighted Average using all components"

*c: Using Capabilities Class Dominant Condition Aggregation Method

Soils data provided by USDA and NRCS.