

Tillable Soils Map

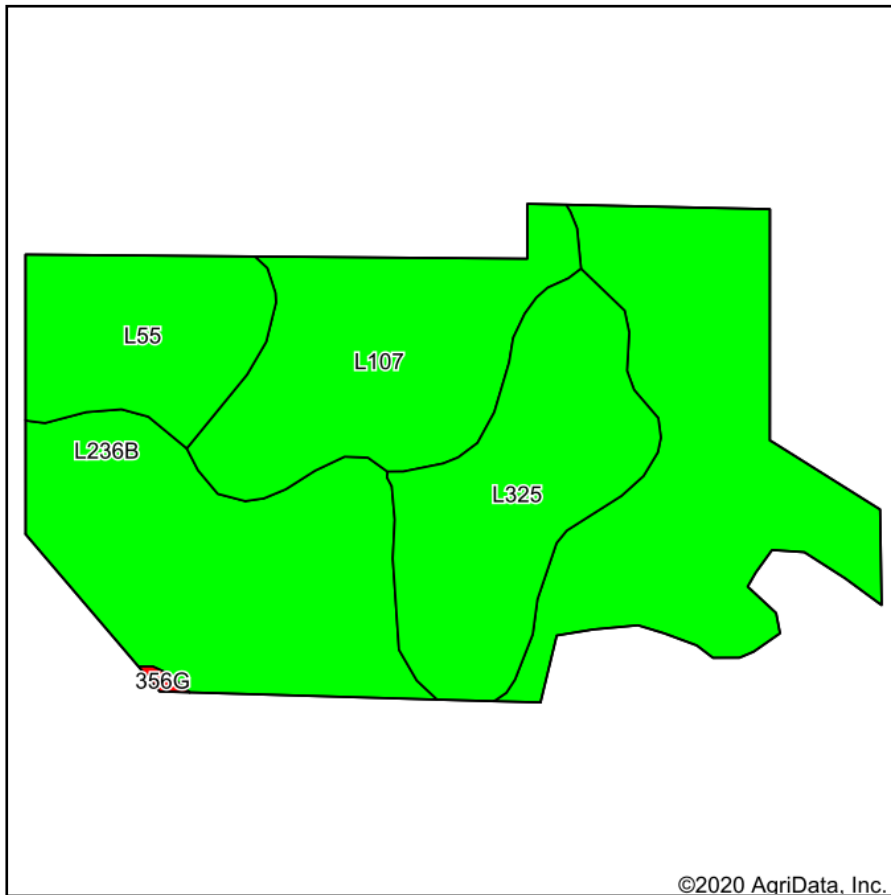

Soils data provided by USDA and NRCS.

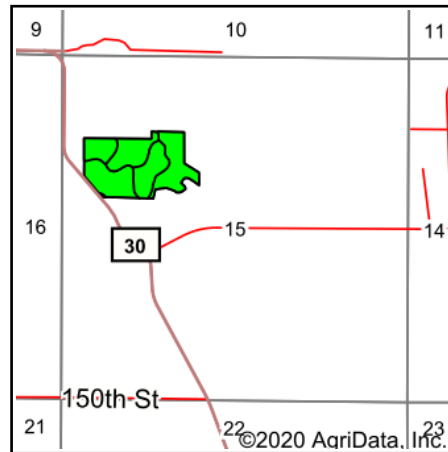

State: **Iowa**
 County: **Dallas**
 Location: **15-81N-26W**
 Township: **Des Moines**
 Acres: **31.49**
 Date: **10/14/2020**



Maps Provided By:



Area Symbol: IA049. Soil Area Version: 26											
Code	Soil Description	Acres	Percent of field	CSR2 Legend	Non-Irr Class *c	*i Corn	*i Soybeans	CSR2**	CSR	*n NCCPI Overall	
L236B	Lester loam, Bemis moraine, 2 to 6 percent slopes	15.90	50.5%		Ile	0	0	85		89	
L107	Webster clay loam, Bemis moraine, 0 to 2 percent slopes	5.93	18.8%		IIw	0	0	88		84	
L325	Le Sueur loam, Bemis moraine, 1 to 3 percent slopes	5.92	18.8%		Ie	0	0	78		92	
L55	Nicollet loam, 1 to 3 percent slopes	3.68	11.7%		Ie	0	0	91		85	
356G	Hayden-Storden loams, 25 to 50 percent slopes	0.06	0.2%		VIIe	88	25.5	5	5	19	
Weighted Average						0.2	*-	84.8	*-	*n 88	

**IA has updated the CSR values for each county to CSR2.

*- CSR weighted average cannot be calculated on the current soils data, use prior data version for csr values.

*i Yield data provided by the ISPAID Database version 8.1.1 developed by IA State University.

*n: The aggregation method is "Weighted Average using all components"

*c: Using Capabilities Class Dominant Condition Aggregation Method

Soils data provided by USDA and NRCS.