

# Soils Map

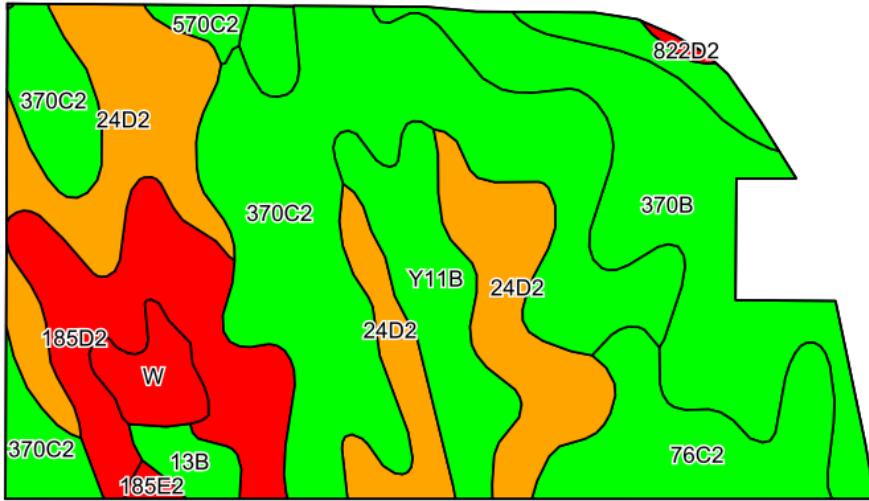

©2020 AgriData, Inc.

Soils data provided by USDA and NRCS.

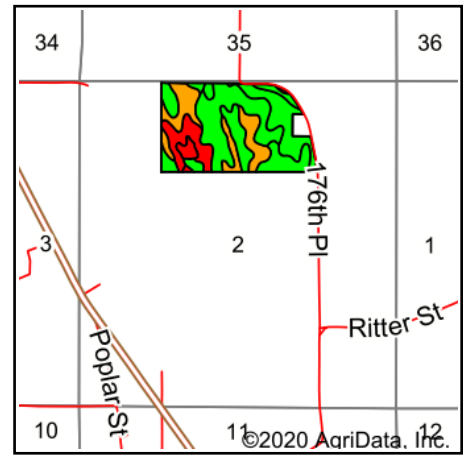

State: **Iowa**  
 County: **Marion**  
 Location: **2-74N-19W**  
 Township: **Indiana**  
 Acres: **79.73**  
 Date: **10/6/2020**

**PC PEOPLES**  
 COMPANY  
 INNOVATIVE. REAL ESTATE. SOLUTIONS.

Maps Provided By:

**surety**  
 CUSTOMIZED ONLINE MAPPING  
 © AgriData, Inc. 2020 www.AgriDataInc.com



Area Symbol: IA125. Soil Area Version: 29

Code	Soil Description	Acres	Percent of field	CSR2 Legend	Non-Irr Class *c	CSR2**	CSR	*n NCCPI Overall	*n NCCPI Corn	*n NCCPI Small Grains	*n NCCPI Soybeans
370C2	Sharpsburg silty clay loam, 5 to 9 percent slopes, eroded	26.09	32.7%		IIIe	80	67	84	84	69	67
24D2	Shelby loam, 9 to 14 percent slopes, moderately eroded	15.96	20.0%		IIIe	45	48	69	69	56	55
370B	Sharpsburg silty clay loam, 2 to 5 percent slopes	13.40	16.8%		Ile	91	87	93	93	78	80
185D2	Bauer silt loam, 9 to 14 percent slopes, moderately eroded	8.51	10.7%		VIe	13	20	36	36	25	17
76C2	Ladoga silt loam, 5 to 9 percent slopes, eroded	6.17	7.7%		IIIe	75	65	87	87	67	68
Y11B	Colo, occasionally flooded-Ely silty clay loams, dissected till plain, 2 to 5 percent slopes	5.48	6.9%		IIw	80		88	86	52	81
W	Water	1.81	2.3%			0	0				
13B	Nodaway-Vesser silt loams, 2 to 5 percent slopes	1.18	1.5%		IIw	79	63	86	81	58	84
570C2	Nira silty clay loam, 5 to 9 percent slopes, moderately eroded	0.67	0.8%		IIIe	72	67	92	92	69	75
185E2	Bauer silt loam, 14 to 18 percent slopes, moderately eroded	0.28	0.4%		VIIe	5	10	34	34	23	16
822D2	Lamoni silty clay loam, 9 to 14 percent slopes, moderately eroded	0.18	0.2%		IVe	10	15	65	65	60	50
Weighted Average						65	*-	*n 75.9	*n 75.7	*n 60	*n 61.1

\*\*IA has updated the CSR values for each county to CSR2.

\*- CSR weighted average cannot be calculated on the current soils data, use prior data version for csr values.

\*n: The aggregation method is "Weighted Average using all components"

\*c: Using Capabilities Class Dominant Condition Aggregation Method

Soils data provided by USDA and NRCS.